

# RUSH AVENUE

- NOTES:
1. MAILBOXES SHALL BE TEMPORARILY AND PERMANENTLY RELOCATED AS DIRECTED BY ENGINEER.
  2. ALL CONCRETE AND BITUMINOUS DRIVEWAYS SHALL BE FULL DEPTH STRAIGHT LINE SAWCUT AS DIRECTED BY ENGINEER.
  3. NO TREE SHALL BE CLEARED AND GRUBBED UNLESS MARKED BY THE ENGINEER.
  4. ALL PRIVATE UTILITY RELOCATION TO BE COORDINATED BETWEEN THE CONTRACTOR AND UTILITY COMPANY.

5. CONCRETE DRIVEWAY REMOVAL TO BE MEASURED AND PAID UNDER CONCRETE SIDEWALK REMOVAL. REMOVAL LIMITS ARE APPROXIMATELY AT THE CONSTRUCTION LIMITS BUT WILL BE MARKED EXACTLY FOR REMOVAL IN THE FIELD BY THE ENGINEER.
6. BITUMINOUS DRIVEWAY REMOVAL TO BE MEASURED AND PAID UNDER BITUMINOUS REMOVAL. REMOVAL LIMITS ARE APPROXIMATELY AT THE CONSTRUCTION LIMITS BUT WILL BE MARKED EXACTLY FOR REMOVAL IN THE FIELD BY THE ENGINEER.

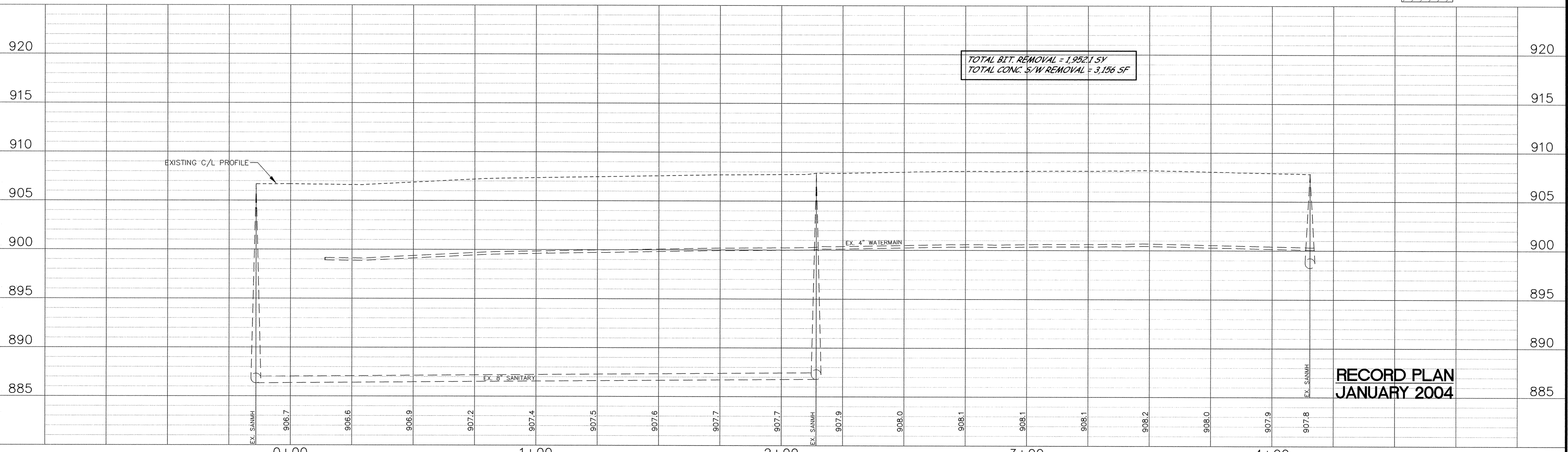
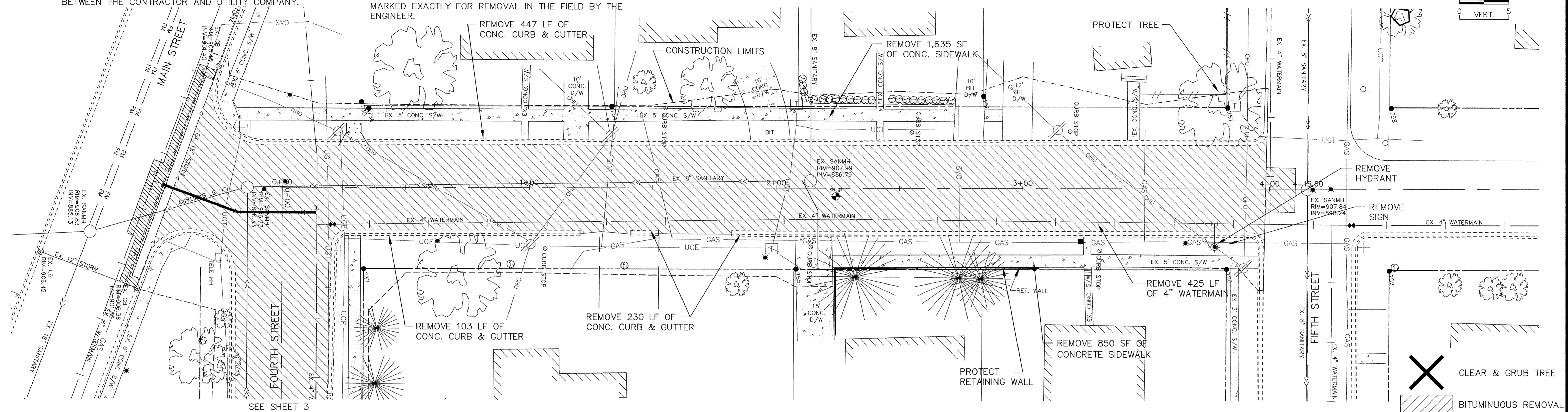
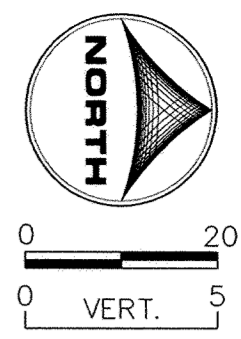

TOTAL BIT. REMOVAL = 1,952.1 SY  
 TOTAL CONC. S/W REMOVAL = 3,156 SF

**RECORD PLAN  
 JANUARY 2004**

DESIGNED BY: DESIGNED BY DRAWN BY: RKM  
 APPROVED BY: APPROVED BY JOB NUMBER 818980J  
 CAD DATE: February 11, 2004 11:56:40 a.m.  
 CAD FILE: 818980J\As-built\C\CS-E06.DWG (RMONJEA)

I HEREBY CERTIFY THAT THIS PLAN, SPECIFICATION, OR REPORT WAS PREPARED BY ME OR UNDER MY DIRECT SUPERVISION AND THAT I AM A DULY LICENSED PROFESSIONAL ENGINEER UNDER THE LAWS OF THE STATE OF MINNESOTA.  
 SIGNATURE: *Kristina Thompson* DATE: 4/2/04  
 PRINTED NAME: KRISTINA J. THOMPSON LIC. NO. 42350

NO.	DATE	BY	REVISION DESCRIPTION

1326 ENERGY PARK DRIVE  
 ST. PAUL, MINNESOTA 55108  
 (651) 644-4389  

 Howard R. Green Company

2003 STREET IMPROVEMENTS  
 CITY OF ELK RIVER

EXISTING TOPOGRAPHY AND REMOVALS  
 RUSH AVENUE  
 0+00 TO 4+15.60

SHEET NO.  
**8**

DRAWING NUMBER 031MPR.04  
 SARGO PRODUCTS • NEW HOPE, MINNESOTA  
 REVISION BY PART NUMBER 0322  
 PREPARED UNDER THE SUPERVISION OF  
 DRAWING NUMBER 0322