

# FOURTH STREET

SEE SHEET 10



SEE SHEET 4

SEE SHEET 6

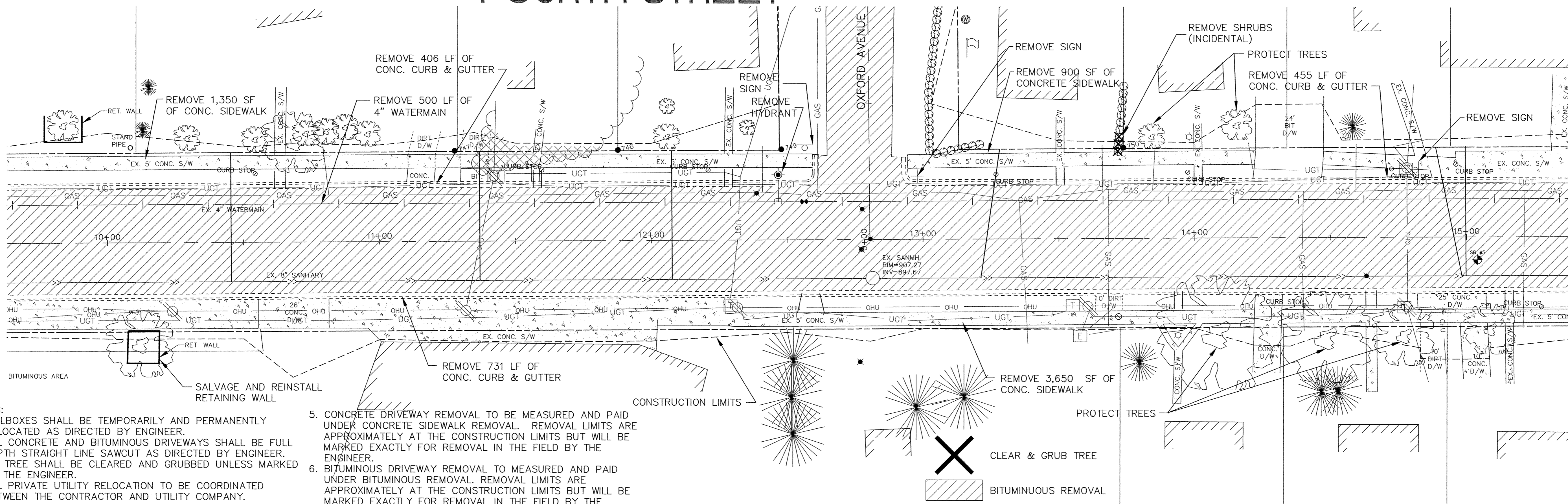

**NOTES:**

- MAILBOXES SHALL BE TEMPORARILY AND PERMANENTLY RELOCATED AS DIRECTED BY ENGINEER.
- ALL CONCRETE AND BITUMINOUS DRIVEWAYS SHALL BE FULL DEPTH STRAIGHT LINE SAWCUT AS DIRECTED BY ENGINEER.
- NO TREE SHALL BE CLEARED AND GRUBBED UNLESS MARKED BY THE ENGINEER.
- ALL PRIVATE UTILITY RELOCATION TO BE COORDINATED BETWEEN THE CONTRACTOR AND UTILITY COMPANY.
- CONCRETE DRIVEWAY REMOVAL TO BE MEASURED AND PAID UNDER CONCRETE SIDEWALK REMOVAL. REMOVAL LIMITS ARE APPROXIMATELY AT THE CONSTRUCTION LIMITS BUT WILL BE MARKED EXACTLY FOR REMOVAL IN THE FIELD BY THE ENGINEER.
- BITUMINOUS DRIVEWAY REMOVAL TO MEASURED AND PAID UNDER BITUMINOUS REMOVAL. REMOVAL LIMITS ARE APPROXIMATELY AT THE CONSTRUCTION LIMITS BUT WILL BE MARKED EXACTLY FOR REMOVAL IN THE FIELD BY THE ENGINEER.

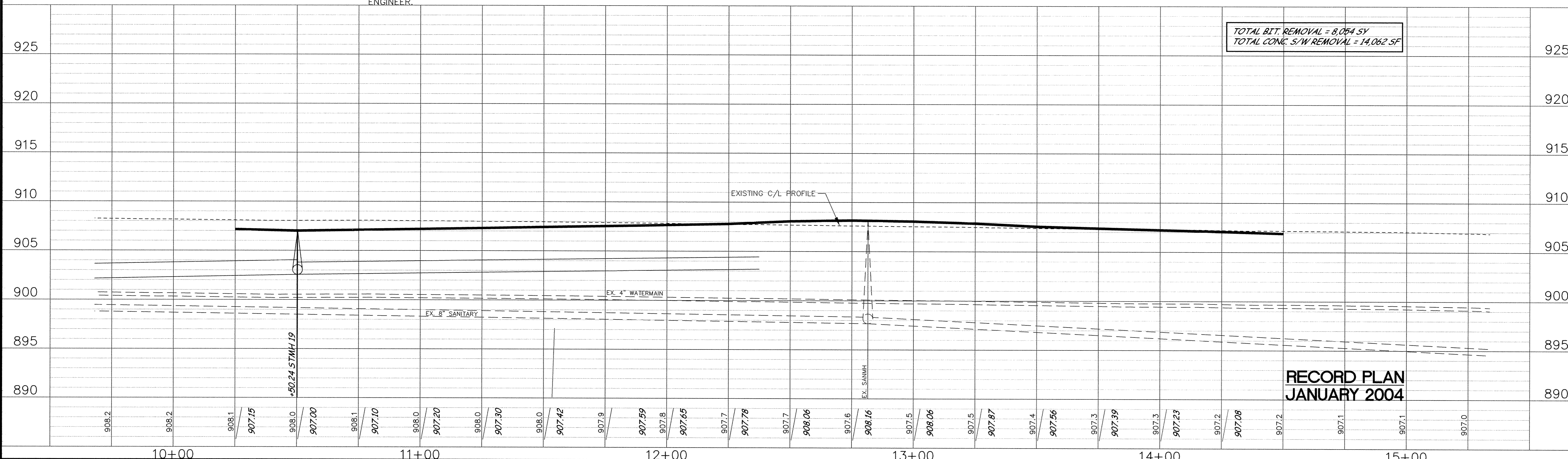

TOTAL BIT. REMOVAL = 8,054 SY  
TOTAL CONC. S/W REMOVAL = 14,062 SF

**RECORD PLAN  
JANUARY 2004**

DESIGNED BY: DESIGNED BY DRAWN BY: RKM  
APPROVED BY: APPROVED BY JOB NUMBER 818980J  
CAD DATE: February 11, 2004 11:58:11 a.m.  
CAD FILE: 818980J\As-built\C\CS\CS-E03.DWG (RMONJEA)

I HEREBY CERTIFY THAT THIS PLAN, SPECIFICATION, OR REPORT WAS PREPARED BY ME OR UNDER MY DIRECT SUPERVISION AND THAT I AM A DULY LICENSED PROFESSIONAL ENGINEER UNDER THE LAWS OF THE STATE OF MINNESOTA.  
SIGNATURE: *Kristina Thompson* DATE: 4/21/04  
PRINTED NAME: KRISTINA J. THOMPSON LIC. NO. 42350

NO.	DATE	BY	REVISION DESCRIPTION

Howard R. Green Company  
1326 ENERGY PARK DRIVE  
ST. PAUL, MINNESOTA 55108  
(651) 644-4389

**2003 STREET IMPROVEMENTS**  
CITY OF ELK RIVER

EXISTING TOPOGRAPHY AND REMOVALS  
FOURTH STREET  
10+00 TO 15+00

SHEET NO.  
**5**

DRAWING NUMBER 03IMPR.04 5  
SARCO PRODUCTS • NEW HOPE, MINNESOTA  
REVISION BY PART NUMBER 8182  
PROFESSOR OF ENGINEERING