















LEGEND:

-  PROPOSED RIP RAP
-  PROPOSED CONTOUR
-  PROPOSED STORM SEWER
-  PROPOSED WATER LINE
-  PROPOSED SANITARY SEWER
-  PROPOSED WATER SERVICE
-  PROPOSED SANITARY SERVICE
-  PROPOSED CATCH BASIN
-  PROPOSED FLARED END SECTION
-  PROPOSED STORM MANHOLE
-  PROPOSED GATE VALVE & BOX
-  PROPOSED HYDRANT
-  PROPOSED SANITARY MANHOLE
-  AS-BUILT CONTOUR

RECORD DRAWING

RECORD DRAWING
 MEASURED BY: MW/CK @ BPA (04-18-22)

 DRAWN BY MW @ BPA

CONSTRUCTION OF PROJECT SHALL MEET CITY OF ELK RIVER DESIGN STANDARDS (LAST REVISION AUGUST 2017) UNLESS PLANS INDICATES OTHERWISE.

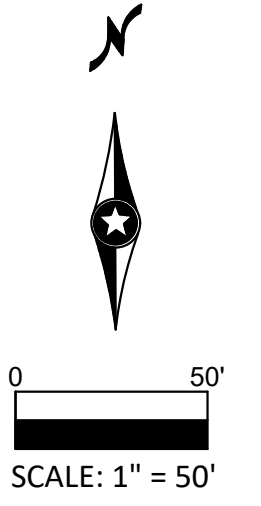
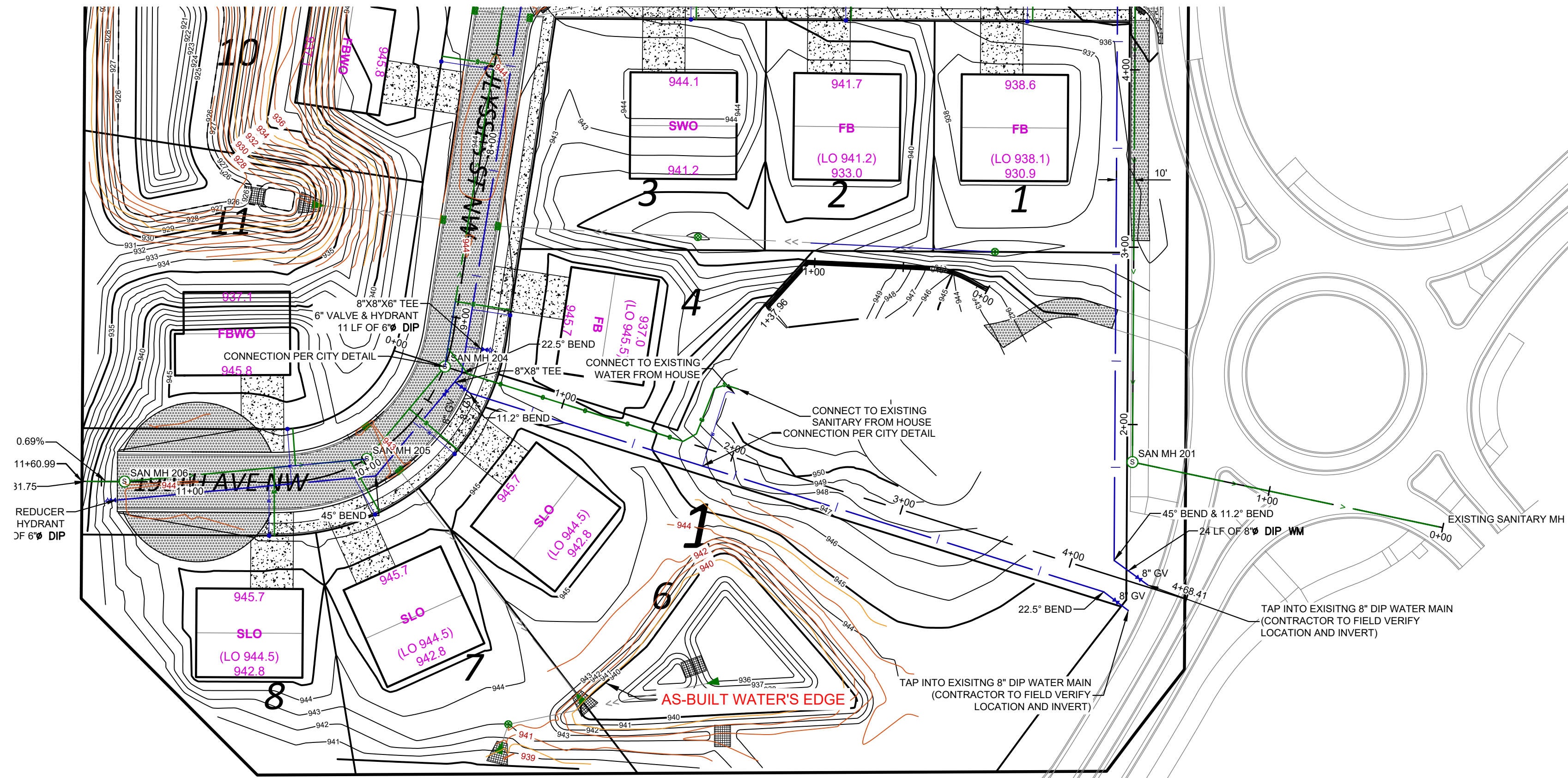

REV NO.	DATE	DESCRIPTION
1	02/22/2021	DRAWINGS ISSUED TO CITY
2	03/12/2021	DRAWINGS REVISED PER CITY REVIEW
3	03/30/2021	MPCA REVIEW
4	04/21/2021	FINAL CONSTRUCTION PLANS
5	05/14/2021	DRAWINGS REVISED PER 2ND CITY REVIEW
6	04/18/2022	ADDED/REMOVED 1 RECORD AS-BUILT DRAWINGS

I hereby certify that this plan, specification, or report was prepared by me or under my direct supervision and that I am a duly Licensed Professional Engineer under the laws of the State of Minnesota.

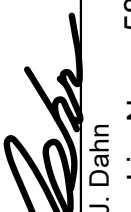
Signed:  Christopher J. Dahn
 Date: 04/18/2022 Lic. No. 68628

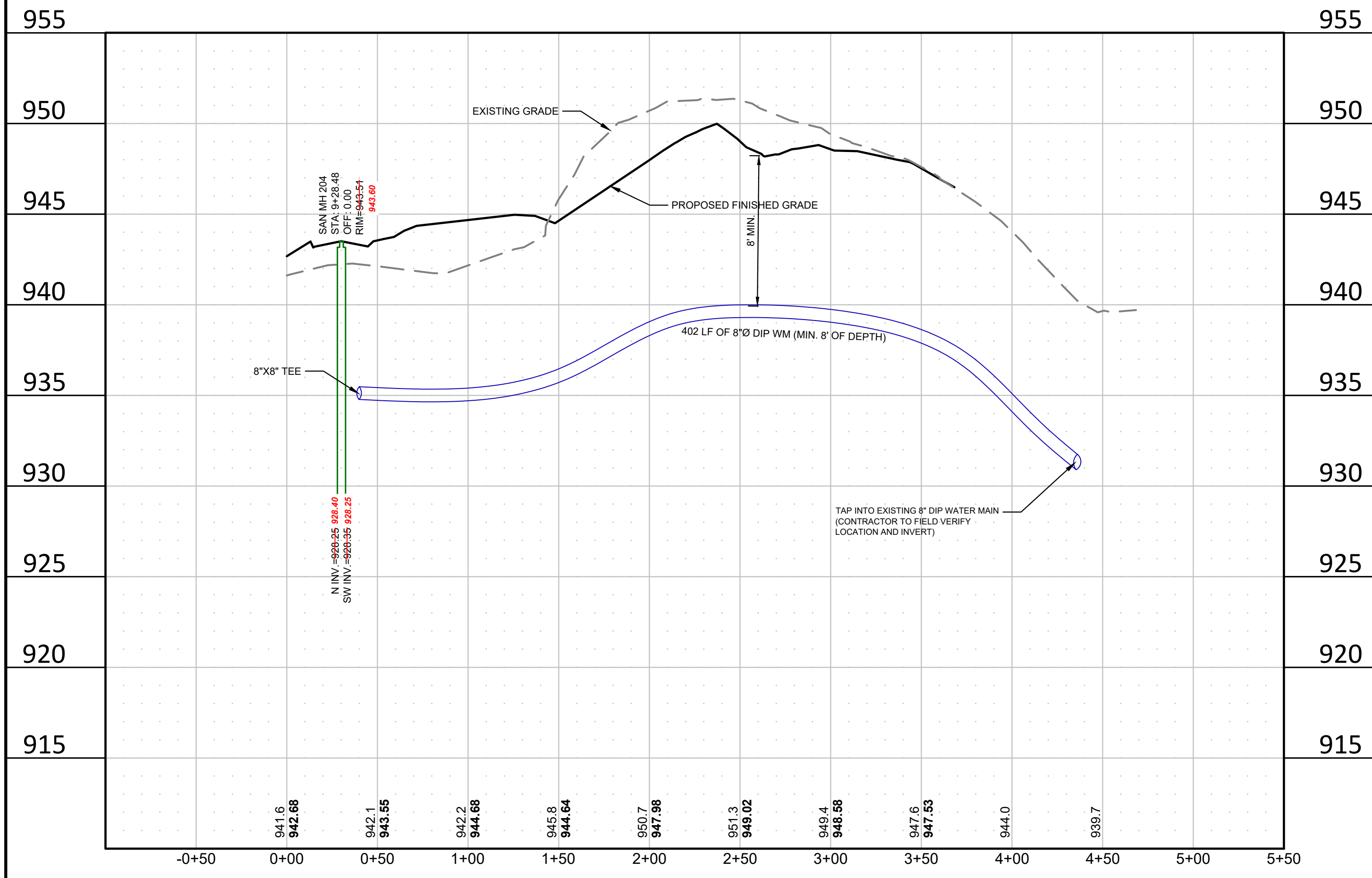

SCALE:
 HORIZONTAL: 1"=50'
 VERTICAL: 1"=5'

BOGART, PEDERSON & ASSOCIATES, INC.
 LAND SURVEYING
 ENVIRONMENTAL SERVICES
 13076 FIRST STREET, BECKER, MN 55309-9322
 TEL: 763-262-8822 FAX: 763-262-8844

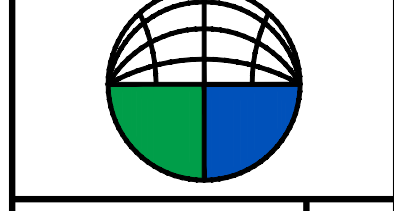

**TRANQUIL MEADOWS
 RESIDENTIAL DEVELOPMENT
 PROVIDENCE S&S, LLC**
 City of Elk River, Sherburne County, MN
 SANITARY & WATERMAIN - SOUTH CONNECTION

SHEET NO.
C9