

NO.	DATE	BY	DESCRIPTION

I HEREBY CERTIFY THAT THIS PLAN, SPECIFICATION, OR REPORT WAS PREPARED BY ME OR UNDER MY DIRECT SUPERVISION AND THAT I AM A DULY LICENSED PROFESSIONAL ENGINEER UNDER THE LAWS OF THE STATE OF MINNESOTA.

NOTES:
 1. EXISTING LANDSCAPING FEATURES SHALL BE PROTECTED IF NECESSARY, SALVAGING AND REINSTALLING SHALL BE CONSIDERED INCIDENTAL.
 2. ALL DRIVEWAYS SHALL BE FULL DEPTH STRAIGHT LINE SAW CUT IMMEDIATELY PROCEEDING PAVING.

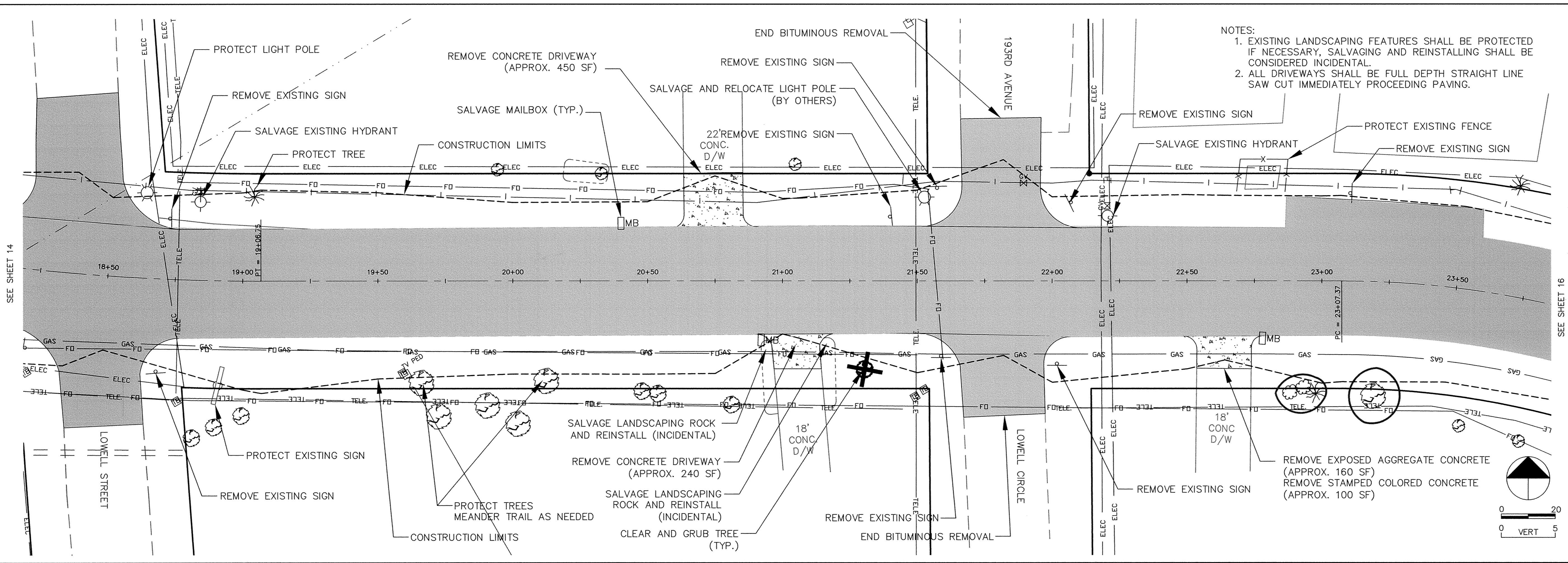

HIGHLAND ROAD

970																							970
965																							965
960																							960
955																							955
950																							950
945																							945
940																							940
935																							935
930																							930
	952.2	952.4	952.6	952.8	953.5	954.1	954.7	955.4	955.8	956.3	956.4	956.5	956.4	956.2	956.0	955.8	955.5	955.2	955.0	954.8	954.5	954.2	
	18+50	19+00	19+50	20+00	20+50	21+00	21+50	22+00	22+50	23+00	23+50												

SAP 204-137-001

RECORD PLAN

HIGHLAND ROAD IMPROVEMENTS

REMOVAL PLAN

HIGHLAND ROAD

CONSULTING ENGINEERS, PLC
 Engineers and Surveyors
 4175 Lovell Road, Suite 112
 Lexington, MN 55014
 Phone: (763) 786-4570
 Fax: (763) 786-4574
 bdmc.com

DRAWN BY: NAB
 CHECKED BY: KJT
 DESIGNED BY: KJT
 JOB NO. 226068D

SHEET	SHEETS
15	55