

- NOTE
1. STATIONING SHOW FOR MANHOLES ON THIS PLAN IS CENTERLINE STREET STATIONING.
 2. SERVICE WYE STATIONING IS FROM DOWNSTREAM MANHOLE.
 3. EXTEND SANITARY SEWER AND WATERMAIN SERVICES 10' BEYOND THE PROPERTY LINE. SEE CITY OF ELK RIVER STANDARD PLATE.
 4. STATIONING FOR CURB STOPS IS CENTERLINE STREET STATIONING.
 5. TOP OF CURB STOPS SHALL BE SET 0.3' ABOVE CENTERLINE AND PLACED ON ROW LINE WITH 10' TAIL UNLESS OTHERWISE DIRECTED BY THE ENGINEER IN THE FIELD.

BENCHMARK:
TOP OF IRON PIPE AS SHOWN
ELEVATION=922.75 FT. (NGDV-1929)

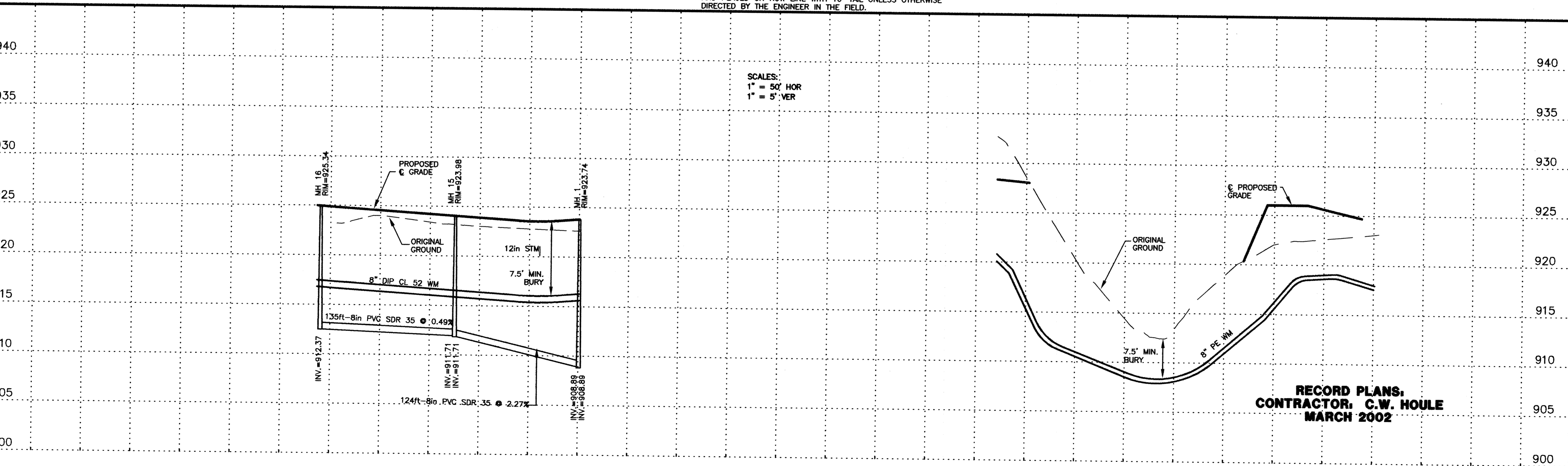

RECORD PLANS,
CONTRACTOR, C.W. HOULE
MARCH 2002

DATE	BY	REVISIONS	REVISION
3-9-01	DS	CITY COMMENTS	
3-2002	SJM	RECORD DRAWING	

I HEREBY CERTIFY THAT THIS PLAN, SPECIFICATION, OR REPORT WAS PREPARED BY ME OR UNDER MY DIRECT SUPERVISION AND THAT I AM A DULY LICENSED PROFESSIONAL ENGINEER UNDER THE LAWS OF THE STATE OF MINNESOTA.

Kenneth Adolf
Kenneth Adolf
DATE: 01-29-01 REG. NO. 12048

REVIEWED BY: _____ DATE: _____

SCHOELL & MADSON, INC.
ENGINEERS * SURVEYORS * PLANNING
SOIL TESTING * ENVIRONMENTAL SERVICES
10580 WAYZATA BOULEVARD, SUITE 1
MINNETONKA, MN 55305
(952) 546-7601 FAX: (952) 546-9065
www.schoellmadson.com

OWNER/DEVELOPER

WINDSOR DEVELOPMENT
9145 EDINBURGH LANE
WOODBURY, MN 55125

DATE: JAN., 2001

PROJECT NAME/SHEET TITLE

WINDSOR OAK HILL
ELK RIVER, MN
195TH COURT
SANITARY SEWER & WATERMAIN PLAN

S.M.I. PROJECT NO. 61846-037 SHEET 10 OF 15 SHEETS

SCHOELL & MADSON, INC. ENGINEERS * SURVEYORS * PLANNING SOIL TESTING * ENVIRONMENTAL SERVICES 10580 WAYZATA BOULEVARD, SUITE 1 MINNETONKA, MN 55305 (952) 546-7601 FAX: (952) 546-9065 www.schoellmadson.com