

NOTE
 1. STATIONING SHOW FOR MANHOLES ON THIS PLAN IS CENTERLINE STREET STATION.
 2. SEE DETAIL SHEET FOR CASTING SCHEDULE.

BENCHMARK:
 TOP NUT OF HYDRANT AT SE CORNER
 196TH AVENUE NW AND ELGIN STREET NW
 ELEVATION = 933.38 FT.

1ST ADDITION

HUDSON CIRCLE NW

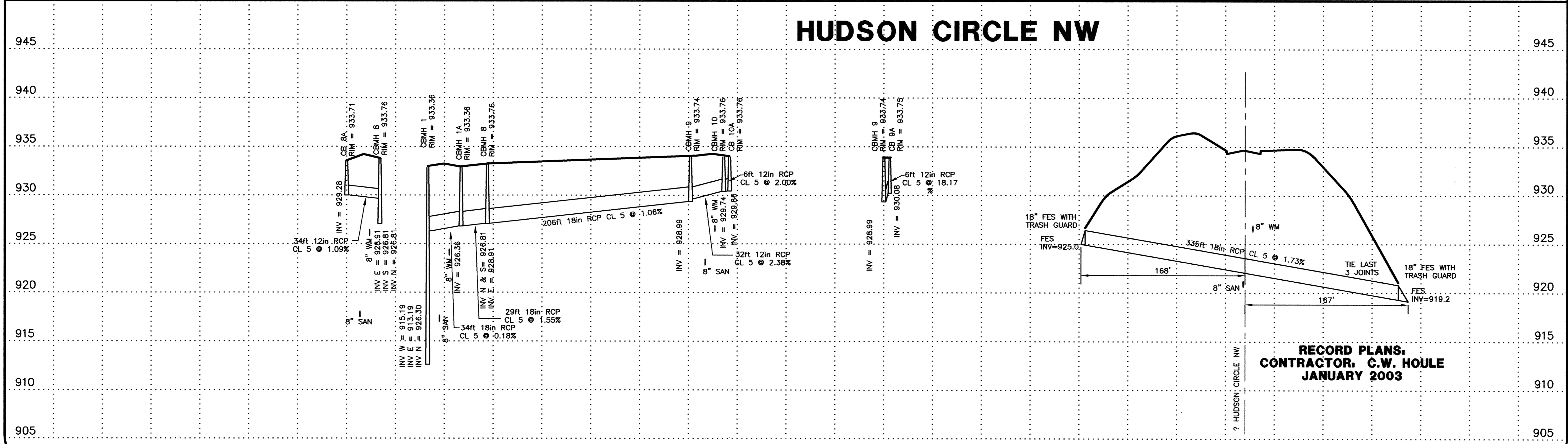

RECORD PLANS,
 CONTRACTOR, C.W. HOULE
 JANUARY 2003

DATE	BY	REVISIONS
4/25/02	DRL	CITY COMMENTS
1-2003	KEJ	RECORD DRAWING

I HEREBY CERTIFY THAT THIS PLAN, SPECIFICATION, OR REPORT WAS PREPARED BY ME OR UNDER MY DIRECT SUPERVISION AND THAT I AM A DULY LICENSED PROFESSIONAL ENGINEER UNDER THE LAWS OF THE STATE OF MINNESOTA.
Kenneth Adolf
 KENNETH ADOLF
 DATE: 03-25-02 REG. NO. 12048
 REVIEWED BY: _____ DATE: _____

SCHOELL & MADSON, INC.
 ENGINEERS * SURVEYORS * PLANNING
 SOIL TESTING * ENVIRONMENTAL SERVICES
 10580 WAYZATA BOULEVARD, SUITE 1
 MINNETONKA, MN 55305
 (952) 546-7601 FAX: (952) 546-9065
 www.schoellmadson.com

OWNER/DEVELOPER
WINDSOR DEVELOPMENT
 9145 EDINBURGH LANE
 WOODBURY, MN 55125
 DATE: MARCH, 2002

PROJECT NAME/SHEET TITLE
WINDSOR OAK HILL 2ND ADDITION
 ELK RIVER, MN
STORM SEWER PLAN

DRAWING NUMBER

DRAWING NUMBER

DRAWING NUMBER

DRAWING NUMBER
 WINDS2.02
 10