

- NOTE**
1. STATIONING SHOW FOR MANHOLES ON THIS PLAN IS CENTERLINE STREET STATIONING.
  2. SERVICE WYE STATIONING IS FROM DOWNSTREAM MANHOLE.
  3. EXTEND SANITARY SEWER AND WATERMAIN SERVICES 10' BEYOND THE PROPERTY LINE. SEE CITY OF ELK RIVER STANDARD P.L.E.
  4. STATIONING FOR CURB STOPS IS CENTERLINE STREET STATIONING.
  5. TOP OF CURB STOPS SHALL BE SET 0.3' ABOVE CENTERLINE AND PLACED ON ROW LINE WITH 10' TAIL UNLESS OTHERWISE DIRECTED BY THE ENGINEER IN THE FIELD.
  6. REFER TO PROJECT MANUAL FOR WATERMAIN TESTING REQUIREMENTS.
- BENCHMARK:**  
TOP NUT OF HYDRANT AT SE CORNER 196TH AVENUE NW AND ELGIN STREET NW  
ELEVATION = 933.38 FT.

SCALES:  
1"=50' HOR  
1"=5' VER

# IRONTON CIRCLE NW

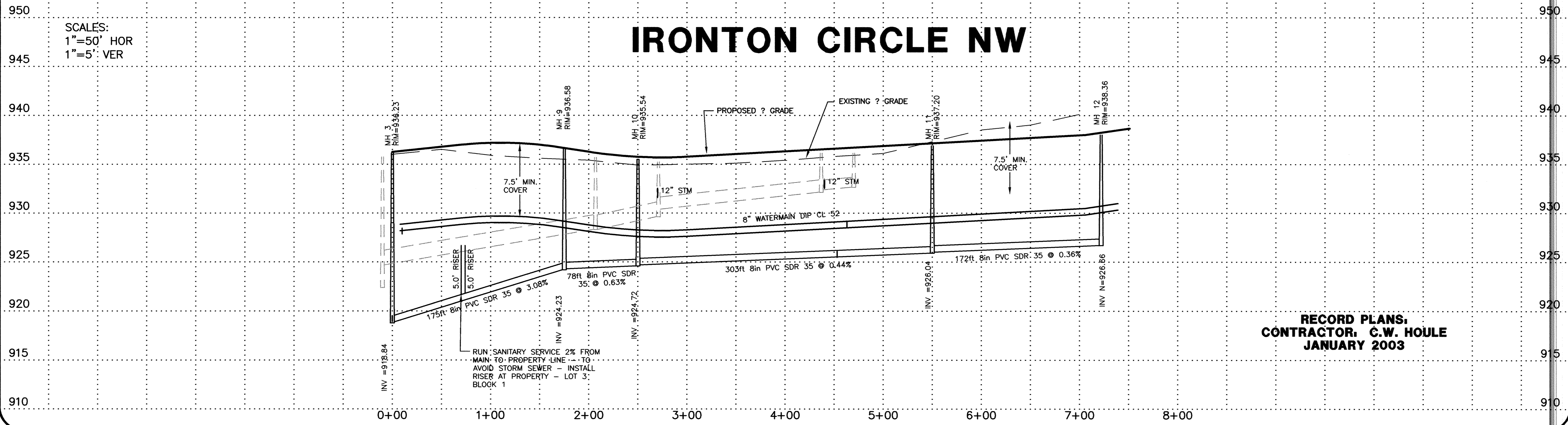

**RECORD PLANS,  
CONTRACTOR, C.W. HOULE  
JANUARY 2003**

DATE	BY	REVISIONS	REVISION
4/25/02	DRL	CITY COMMENTS	
1-2003	KEJ	RECORD DRAWING	
2-2003	CT	RECORD DRAWING CITY REVISIONS	

HEREBY CERTIFY THAT THIS PLAN, SPECIFICATION, OR REPORT WAS PREPARED BY ME OR UNDER MY DIRECT SUPERVISION AND THAT I AM A DULY LICENSED PROFESSIONAL ENGINEER UNDER THE LAWS OF THE STATE OF MINNESOTA.

*Kenneth Adolf*  
KENNETH ADOLF  
DATE: 03-25-02 REG. NO. 12048

**SCHOELL & MADSON, INC.**  
ENGINEERS \* SURVEYORS \* PLANNING  
SOIL TESTING \* ENVIRONMENTAL SERVICES  
10580 WAZATA BOULEVARD, SUITE 1  
MINNETONKA, MN 55305  
(952) 546-7801 FAX: (952) 546-9065  
www.schoellmadson.com

OWNER/DEVELOPER  
**WINDSOR DEVELOPMENT**  
9145 EDINBURGH LANE  
WOODBURY, MN 55125  
DATE: MARCH, 2002

PROJECT NAME/SHEET TITLE  
**WINDSOR OAK HILL 2ND ADDITION**  
ELK RIVER, MN  
**SANITARY SEWER & WATERMAIN PLAN**