

- NOTE
1. STATIONING SHOW FOR MANHOLES ON THIS PLAN IS CENTERLINE STREET STATIONING.
 2. SERVICE WYE STATIONING IS FROM DOWNSTREAM MANHOLE.
 3. EXTEND SANITARY SEWER AND WATERMAIN SERVICES 10' BEYOND THE PROPERTY LINE. SEE CITY OF ELK RIVER STANDARD PLATE.
 4. STATIONING FOR CURB STOPS IS CENTERLINE STREET STATIONING.
 5. TOP OF CURB STOPS SHALL BE SET 0.3' ABOVE CENTERLINE AND PLACED ON ROW LINE WITH 10' TAIL UNLESS OTHERWISE DIRECTED BY THE ENGINEER IN THE FIELD.
 6. REFER TO PROJECT MANUAL FOR WATERMAIN TESTING REQUIREMENTS.
- BENCHMARK:
TOP NUT OF HYDRANT AT SE CORNER 196TH AVENUE NW AND ELGIN STREET NW
ELEVATION = 933.38 FT.

196TH AVENUE NW

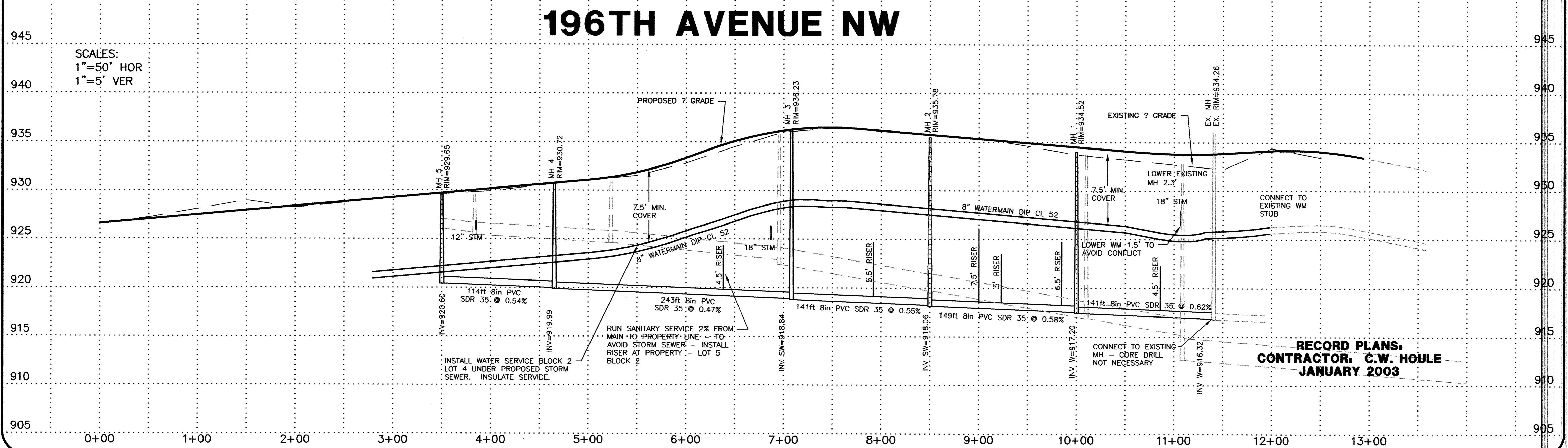

**RECORD PLANS,
CONTRACTOR: C.W. HOULE
JANUARY 2003**

DATE	BY	REVISIONS	REVISION
4/25/02	DRL	CITY COMMENTS	
1-2003	KEJ	RECORD DRAWING	

I HEREBY CERTIFY THAT THIS PLAN, SPECIFICATION, OR REPORT WAS PREPARED BY ME OR UNDER MY DIRECT SUPERVISION AND THAT I AM A DULY LICENSED PROFESSIONAL ENGINEER UNDER THE LAWS OF THE STATE OF MINNESOTA.

Kenneth Adolf
KENNETH ADOLF
DATE: 03-25-02 REG. NO. 12048

SCHOELL & MADSON, INC.
ENGINEERS * SURVEYORS * PLANNING
SOIL TESTING * ENVIRONMENTAL SERVICES
10580 WAYZATA BOULEVARD, SUITE 1
MINNETONKA, MN 55305
(952) 546-7601 FAX: (952) 546-9065
www.schoellmadson.com

OWNER/DEVELOPER
WINDSOR DEVELOPMENT
9145 EDINBURGH LANE
WOODBURY, MN 55125
DATE: MARCH, 2002

PROJECT NAME/SHEET TITLE
WINDSOR OAK HILL 2ND ADDITION
ELK RIVER, MN
SANITARY SEWER & WATERMAIN PLAN