

# U.S. HWY. 10 & 52

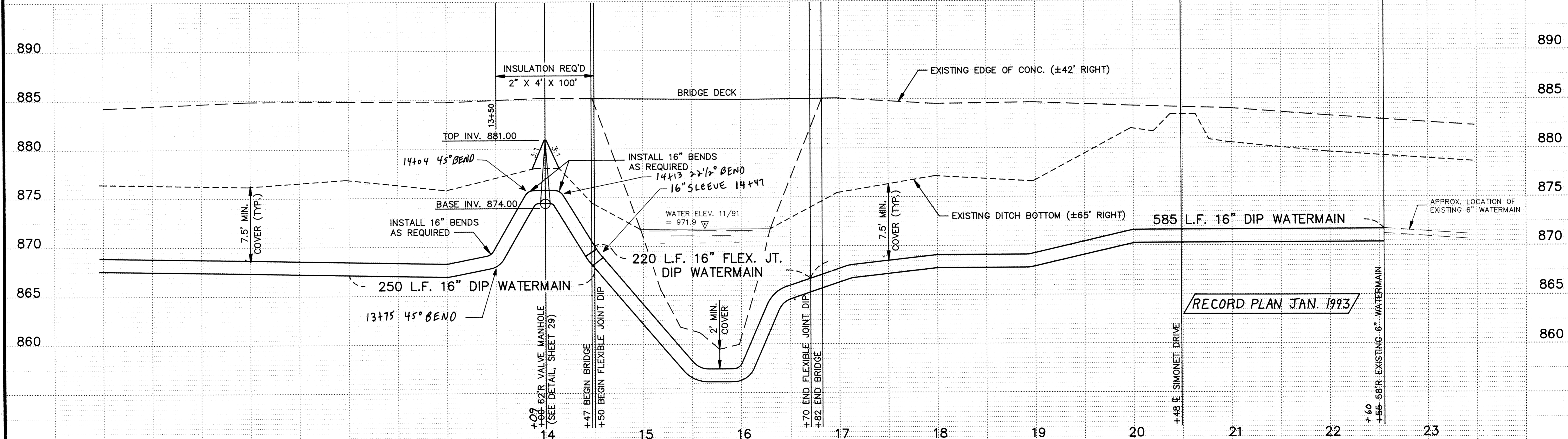
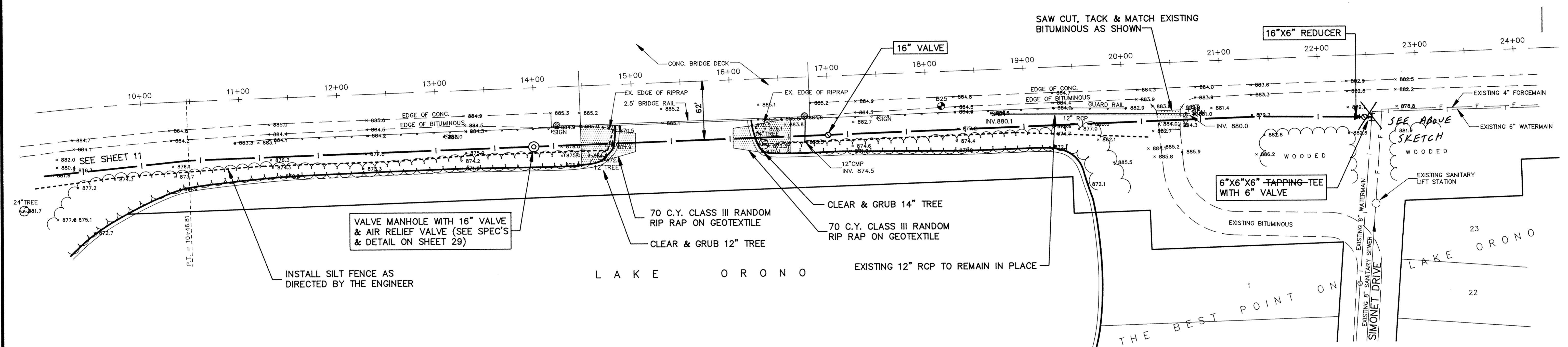
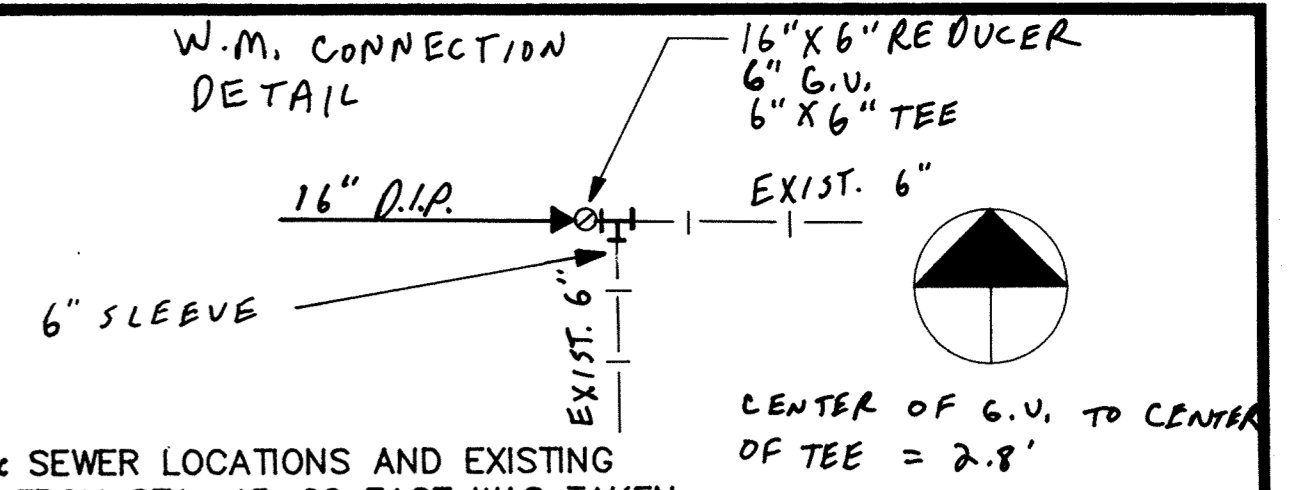

I HEREBY CERTIFY THAT THIS PLAN, SPECIFICATION, OR REPORT WAS PREPARED BY ME OR UNDER MY DIRECT SUPERVISION AND THAT I AM A DULY REGISTERED PROFESSIONAL ENGINEER UNDER THE LAWS OF THE STATE OF MINNESOTA.  
 KRR  
 DATE 3/19/92 REG. NO. 20389

**Maier Stewart & Associates Inc.**  
 CONSULTING ENGINEERS  
 9800 SHELARD PARKWAY (612) 546-0432 MINNEAPOLIS, MINNESOTA 55441  
 1959 SLOAN PLACE (612) 774-6021 ST. PAUL, MINNESOTA 55117

DATE	DESCRIPTION	DESIGNED	CHECKED	DRAWN
		KRR	PFB	GC

REVISIONS	DATE	DESCRIPTION

CITY OF ELK RIVER  
 S.A.P. 204-113-06  
 WATERMAIN CONSTRUCTION  
 U.S. HWY. 10 & 52  
 DATE DEC. 1991 SHEET 12 OF 36 SHEETS PROJECT NO. 230-131

DRAWING NUMBER

DRAWING NUMBER

DRAWING NUMBER

DRAWING NUMBER  
 WESTE.92