

# DEPOT STREET

EXISTING FORCEMAIN CONNECTION TIES:  
SANITARY MANHOLE = 69'  
CORNER OF HOUSE #1639 = 81'

EXISTING FORCEMAIN CONNECTION TIES:  
BACK OF CURB = 18'  
POWER POLE = 39'

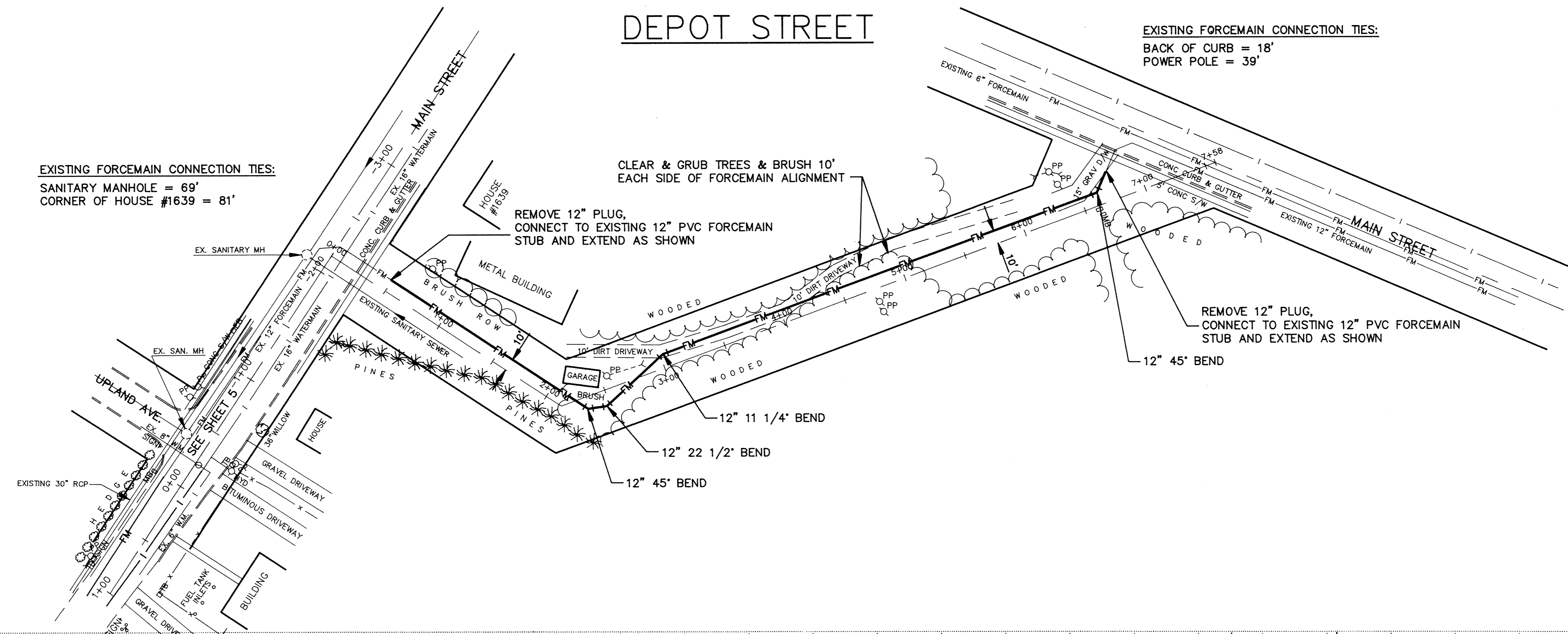

CLEAR & GRUB TREES & BRUSH 10' EACH SIDE OF FORCEMAIN ALIGNMENT

REMOVE 12" PLUG, CONNECT TO EXISTING 12" PVC FORCEMAIN STUB AND EXTEND AS SHOWN

REMOVE 12" PLUG, CONNECT TO EXISTING 12" PVC FORCEMAIN STUB AND EXTEND AS SHOWN

12" 11 1/4° BEND  
12" 22 1/2° BEND  
12" 45° BEND

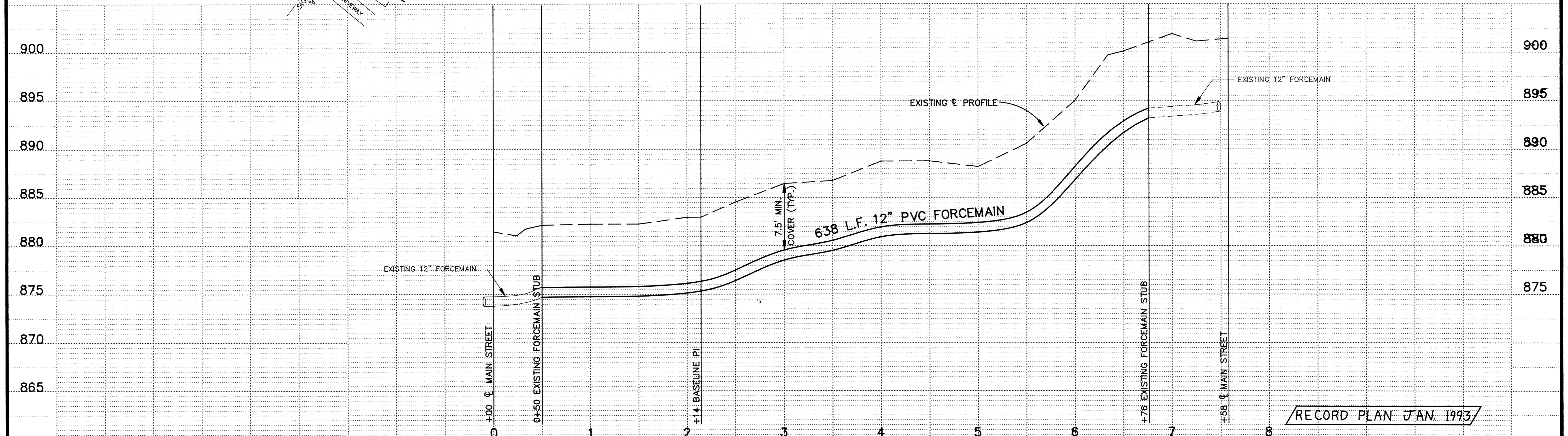

RECORD PLAN JAN. 1993

I HEREBY CERTIFY THAT THIS PLAN, SPECIFICATION, OR REPORT WAS PREPARED BY ME OR UNDER MY DIRECT SUPERVISION AND THAT I AM A DULY REGISTERED PROFESSIONAL ENGINEER UNDER THE LAWS OF THE STATE OF MINNESOTA.  
*K.R. Rosaly*  
DATE 3/19/92 REG. NO. 20389

**MSA** CONSULTING ENGINEERS  
**Maier Stewart & Associates Inc.**  
9800 SHELARD PARKWAY (612) 546-0432 MINNEAPOLIS, MINNESOTA 55441  
1959 SLOAN PLACE (612) 774-6021 ST. PAUL, MINNESOTA 55117

DATE	DESCRIPTION	DESIGNED - KRR
		CHECKED - PEB
		DRAWN - GG
		GRAPHIC SCALE
		0 HORIZ. 50
		0 VERT. 5

CITY OF ELK RIVER  
S.A.P. 204-113-06  
SANITARY FORCEMAIN CONSTRUCTION  
DEPOT STREET  
DATE JAN 1992 SHEET 4 OF 36 SHEETS PROJECT NO. 230-131