

KEY	DESCRIPTION	WIDTH	COLOR	REMARKS	QUANTITY
①	LANE LINE	4"	WHITE	SOLID	200 LF
②	LANE LINE	4"	WHITE	SKIP 10' STRIPE, 40' SPACE	450 LF
③	CENTERLINE STRIPE	4"	YELLOW	SOLID DOUBLE	1800 LF
⑧	CROSS HATCHING	24" WIDE 20' SPACE @ 45°	YELLOW	SOLID	438 LF
↙	LEFT TURN ARROW	10"X 8' LONG	WHITE	SOLID	1 EA
↘	RIGHT TURN ARROW	10"X 8' LONG	WHITE	SOLID	1 EA

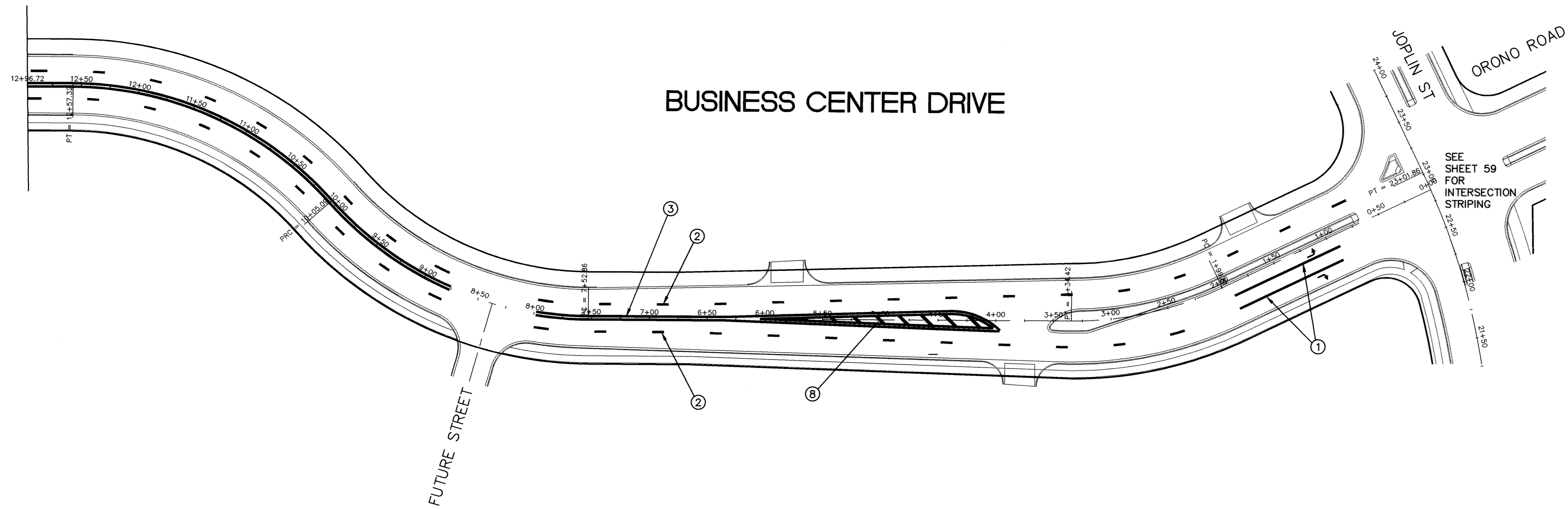

BUSINESS CENTER DRIVE

RECORD PLAN
JANUARY 1996

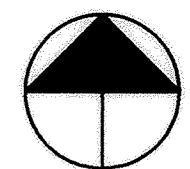

I HEREBY CERTIFY THAT THIS PLAN, SPECIFICATION, OR REPORT WAS PREPARED BY ME OR UNDER MY DIRECT SUPERVISION AND THAT I AM A DULY REGISTERED PROFESSIONAL ENGINEER UNDER THE LAWS OF THE STATE OF MINNESOTA.
Mark V. Lushane
DATE 9/21/94 REG. NO. 19130



1326 ENERGY PARK DRIVE
ST. PAUL, MINNESOTA 55108
(612) 644-4389
9800 SHELARD PARKWAY
MINNEAPOLIS, MINNESOTA 55441
(612) 546-0432

REVISIONS	DATE	DESCRIPTION	DESIGNED	CHKD

CHECKED _____
DRAWN _____
GRAPHIC SCALE
0 50
0 5
VERT.

CITY OF ELK RIVER SIGNING & STRIPPING BUSINESS CENTER DRIVE		
DATE OCT 1995	SHEET 59A OF 63 SHEETS	PROJECT NO. 230-223