

# ORONO PARKWAY

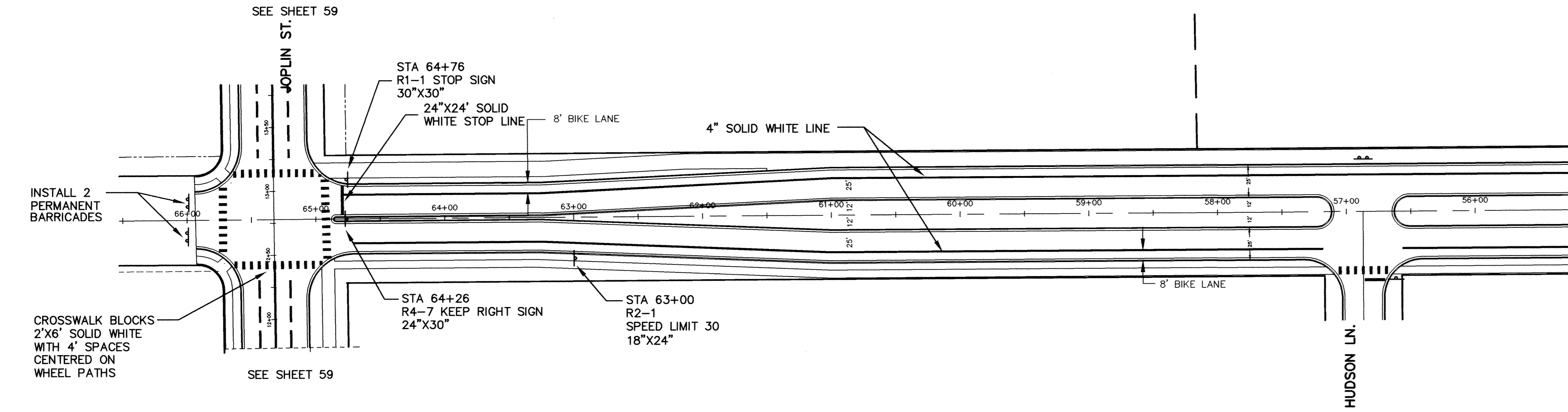
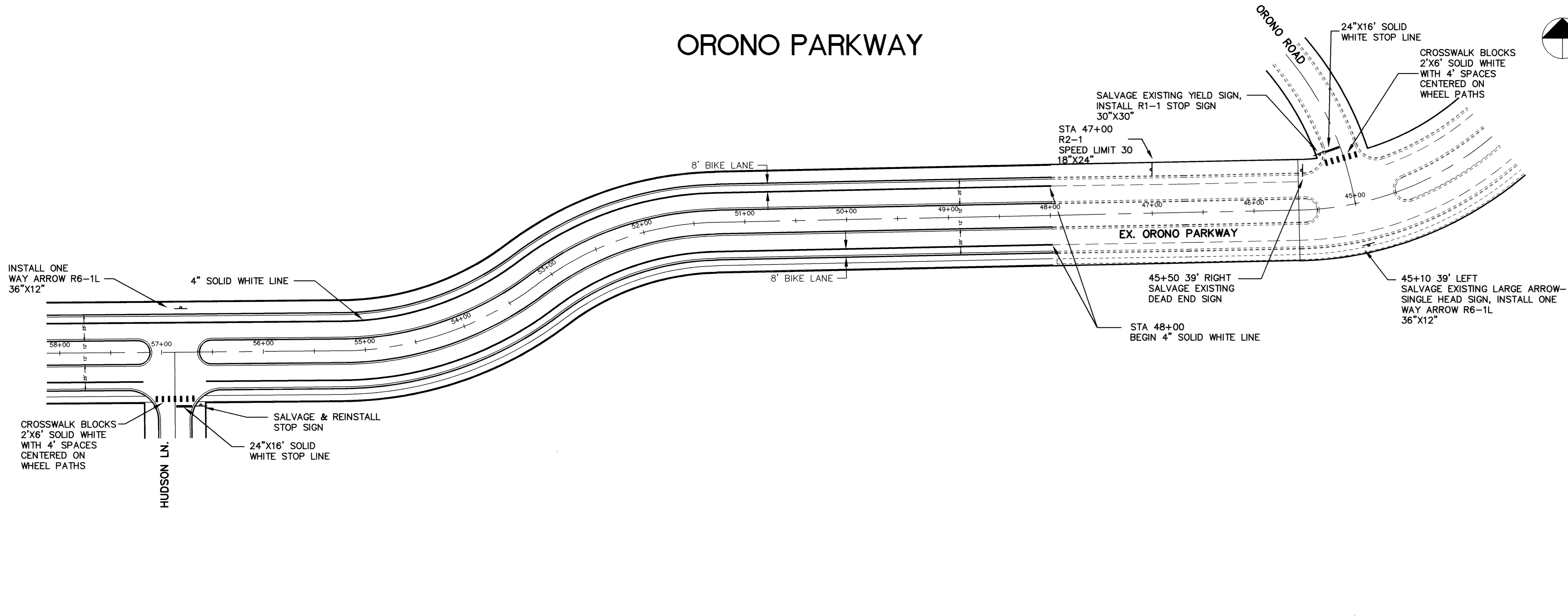

**RECORD PLAN**  
**JANUARY 1996**

CITY OF ELK RIVER  
 SIGNING & STRIPING  
 ORONO PARKWAY

48+00 TO 66+00

I HEREBY CERTIFY THAT THIS PLAN, SPECIFICATION, OR REPORT WAS PREPARED BY ME OR UNDER MY DIRECT SUPERVISION AND THAT I AM A DULY REGISTERED PROFESSIONAL ENGINEER UNDER THE LAWS OF THE STATE OF MINNESOTA.  
*Mark V. Abraham*  
 DATE 9/21/94 REG. NO. 19130

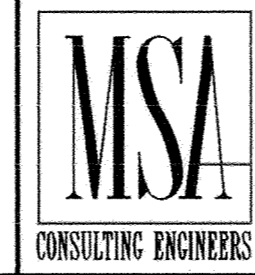

1326 ENERGY PARK DRIVE  
 ST. PAUL, MINNESOTA 55108  
 (612) 644-4389  
 9800 SHELARD PARKWAY  
 MINNEAPOLIS, MINNESOTA 55441  
 (612) 546-0432

REVISIONS	DATE	DESCRIPTION	DESIGNED LCS
	9-15-94	NEW ALIGNMENT	CHECKED
		FOR ORONO PARKWAY	DRAWN LCS

GRAPHIC SCALE  
 0 50  
 0 VERT. 5

DATE AUG. 1994 SHEET 58 OF 63 SHEETS PROJECT NO. 230-223