

P.C. 2+53.69 N 218284.1046 E 570692.1464
 P.T. 2+78.56 N 218259.7185 E 570696.7279
 ST MH 22 N 218225.9726 E 570600.6884

COUNTRY CROSSING 2ND STORM SEWER EASEMENT

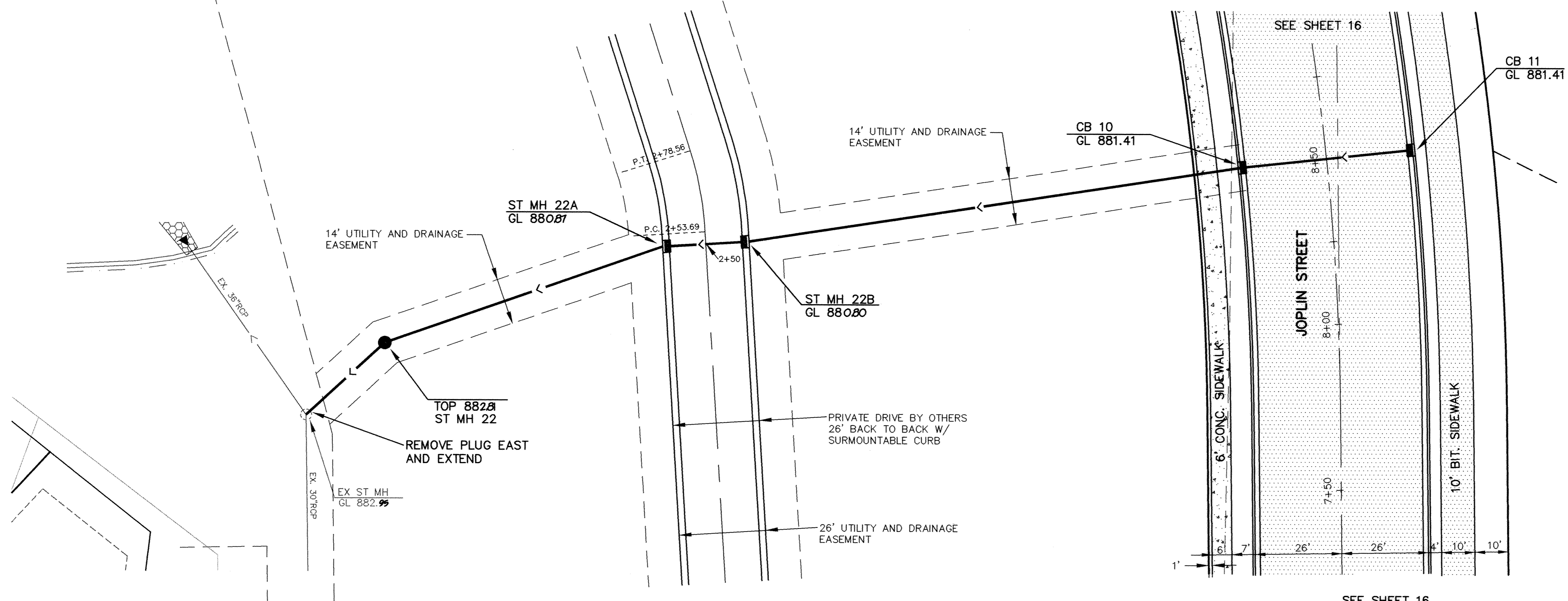

SEE SHEET 16

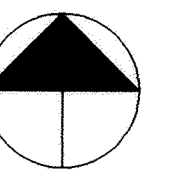
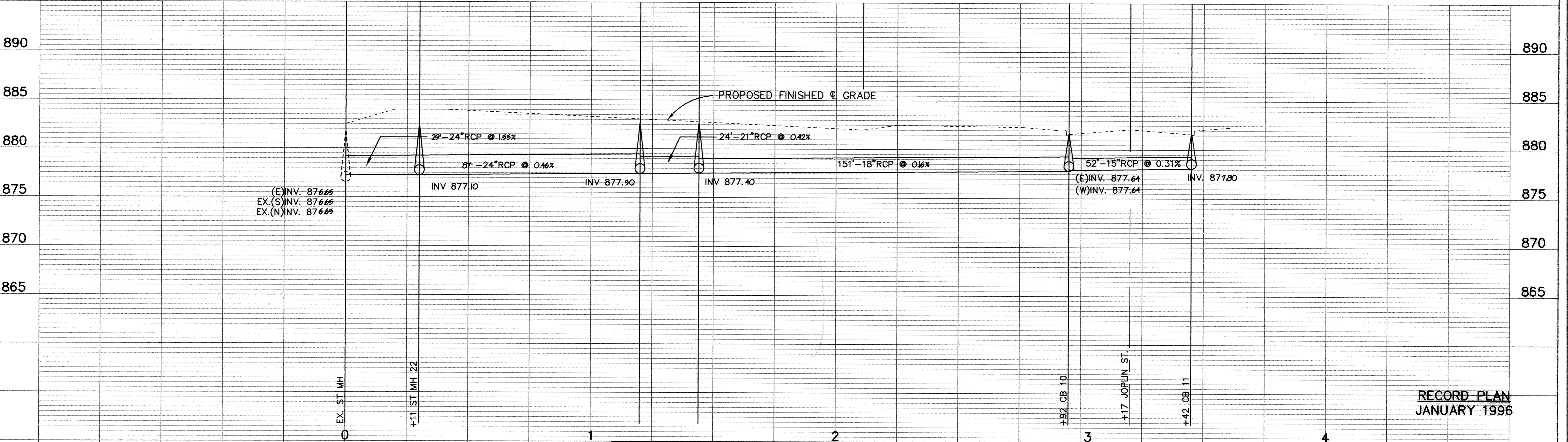

RECORD PLAN
 JANUARY 1996

ER2230-8

I HEREBY CERTIFY THAT THIS PLAN, SPECIFICATION, OR REPORT WAS PREPARED BY ME OR UNDER MY DIRECT SUPERVISION AND THAT I AM A DULY REGISTERED PROFESSIONAL ENGINEER UNDER THE LAWS OF THE STATE OF MINNESOTA.
Mark V. Graham
 DATE 9/2/94 REG. NO. 19130



1326 ENERGY PARK DRIVE
 ST. PAUL, MINNESOTA 55108
 (612) 644-4389
 9800 SHELARD PARKWAY
 MINNEAPOLIS, MINNESOTA 55441
 (612) 546-0432

REVISIONS	DATE	DESCRIPTION	DESIGNED	LCS
	4-3-95	CHANGE ORDER NO. 2	CHECKED	LCS
			DRAWN	LCS
			GRAPHIC SCALE 0' HORIZ. 20' 1" VERT. 5'	

CITY OF ELK RIVER STORM SEWER COUNTRY CROSSING 2ND STORM SEWER EASEMENT		
0+00 TO 3+42	DATE AUG. 1994	SHEET 22 OF 63 SHEETS
		PROJECT NO. 230-223