

JOPLIN STREET

CURVE
 $\Delta = 24^{\circ}38'40''$
 $R = 600.00'$
 $T = 131.06'$
 $L = 258.08'$

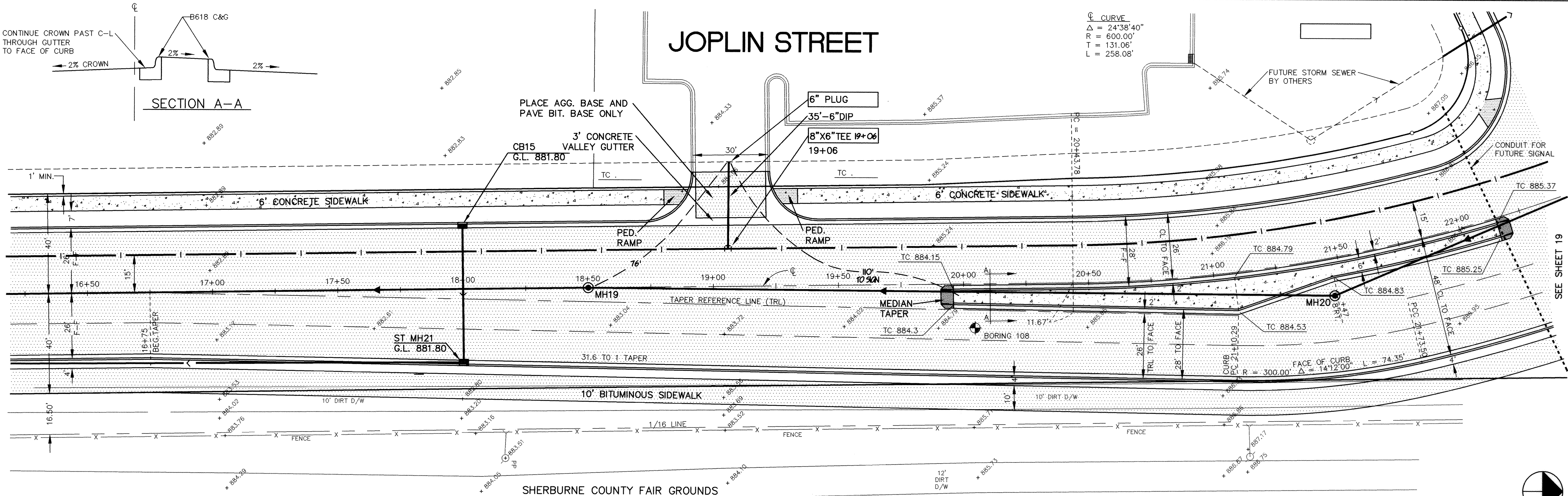

SHERBURNE COUNTY FAIR GROUNDS

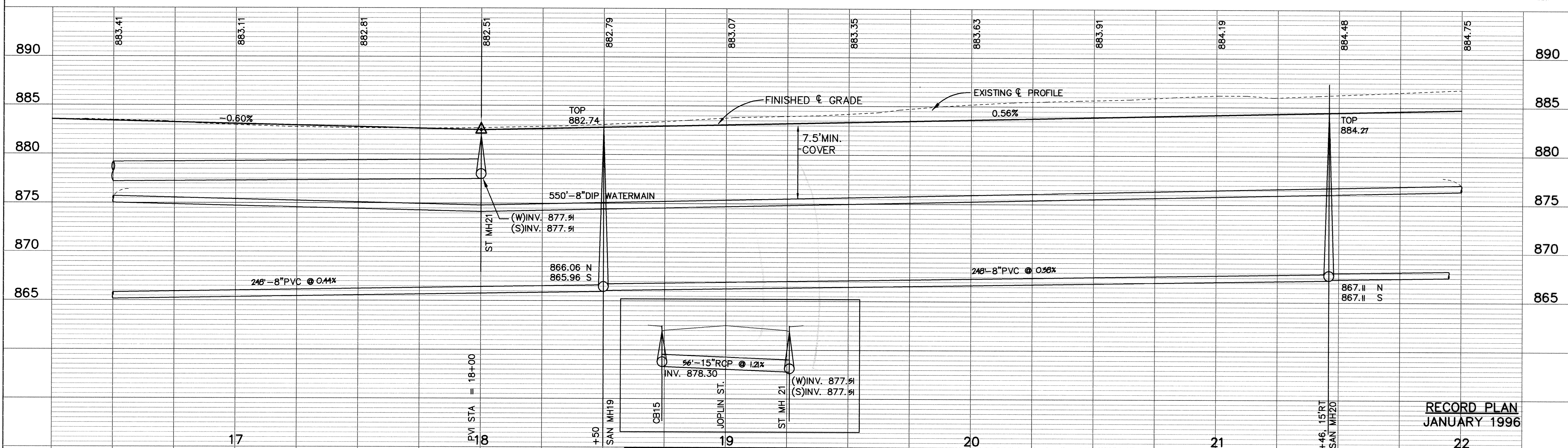
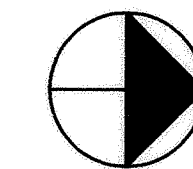

**RECORD PLAN
JANUARY 1996**

I HEREBY CERTIFY THAT THIS PLAN, SPECIFICATION, OR REPORT WAS PREPARED BY ME OR UNDER MY DIRECT SUPERVISION AND THAT I AM A DULY REGISTERED PROFESSIONAL ENGINEER UNDER THE LAWS OF THE STATE OF MINNESOTA. <i>Mark J. Graham</i> DATE 9/21/94 REG. NO. 19130		1326 ENERGY PARK DRIVE ST. PAUL, MINNESOTA 55108 (612) 644-4389 9800 SHELARD PARKWAY MINNEAPOLIS, MINNESOTA 55441 (612) 546-0432	DATE 9-15-94 DESCRIPTION ADDED DRIVEWAY FOR FAIRGROUNDS	DESIGNED LCS CHECKED LCS DRAWN LCS	CITY OF ELK RIVER SANITARY SEWER, STORM SEWER, WATERMAIN AND STREET JOPLIN STREET 16+25 TO 21+75
			REVISIONS 4-3-95 CHANGE ORDER NO. 2	GRAPHIC SCALE 0 20 0 5 VERT. 5	