

RECORD PLAN 2005
 CONTRACTOR
 RYAN CONTRACTING
 8700 13TH AVE.
 SHAKOPEE, MN
 (952) 894-3200

- GENERAL NOTES:
- 1.) SANITARY SEWER SERVICES SHALL BE 4" PVC SDR-35.
 - 2.) SANITARY SEWER SERVICE WYES ARE STATIONED FROM DOWN STREAM MANHOLE.
 - 3.) WATER SERVICES SHALL BE 1" COPPER TYPE "K" W/ 7.5' MINIMUM COVER.
 - 4.) SANITARY SEWER INVERTS ARE SHOWN AT THE SERVICE STUB NEAR CURB STOP.
 - 5.) SANITARY SEWER AND WATER SERVICES SHALL BE CONSTRUCTED 15' BEYOND RIGHT-OF-WAY.

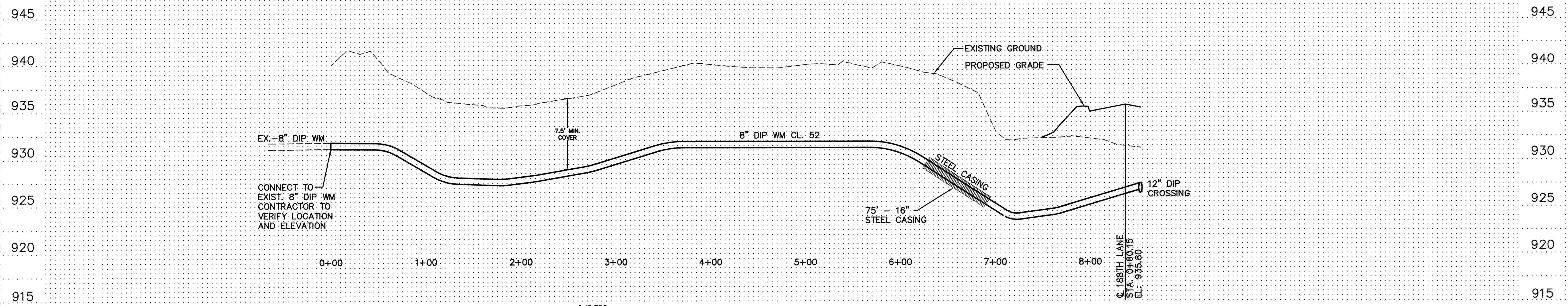

PIONEER engineering <small>LAND SURVEYORS • CIVIL ENGINEERS</small> <small>LAND PLANNERS • LANDSCAPE ARCHITECTS</small> 201 853rd Avenue NW Oak Ridge, MN 55433 (763) 783-1800 FAX: 783-1803 2422 Enterprise Drive Mendota Heights, MN 55120 (612) 881-1914 FAX: 681-9488	I hereby certify that this plan was prepared by me or under my direct supervision and that I am a duly Licensed Professional Engineer under the laws of the State of Minnesota. Name: <i>Paul J. Chaffin</i> Reg. No.: 19860 Date: 7/16/04	Revisions 1. 8/27/04 2. 9/2/04 3. 10/7/04 4. 3/10/05 s. xx/xx/xx	Date: 7/16/04 Designed: AMH Drawn: AMH	SHEET TITLE SANITARY SEWER & WATERMAIN	OWNER: RYAN CONTRACTING CO. 8700 13TH AVENUE EAST SHAKOPEE, MINNESOTA 55379	PROJECT: TWIN LAKES ESTATES ELK RIVER	RECORD PLAN 2005	SHEET 7 OF 24 SHEETS

DRAWING NUMBER
 TWINLAKEST.05
 7