

PE RAW WATER MAIN DETAIL

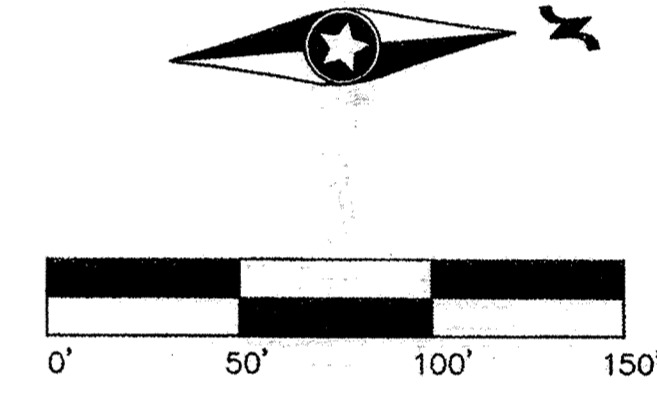

Smith Drive

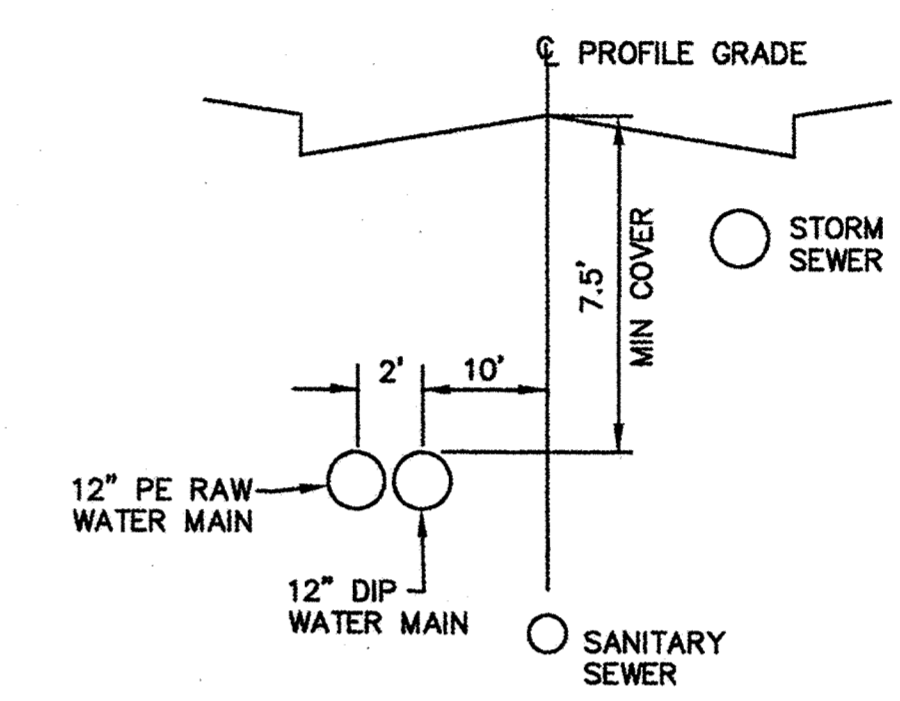
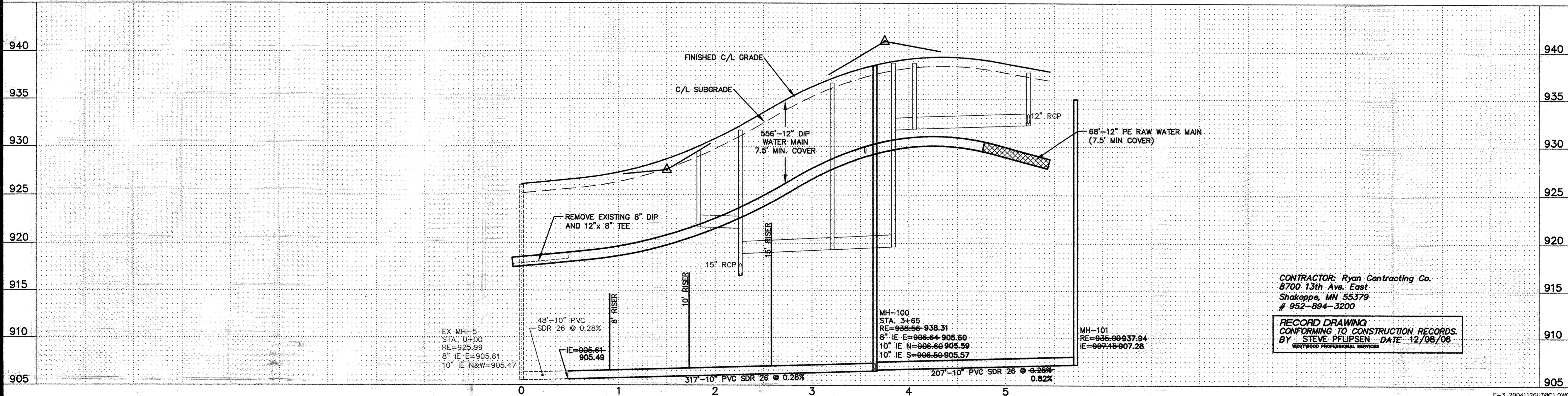

CONTRACTOR: Ryan Contracting Co.
 8700 13th Ave. East
 Shakopee, MN 55379
 # 952-894-3200

RECORD DRAWING
 CONFORMING TO CONSTRUCTION RECORDS.
 BY: STEVE PFLIPSEN DATE: 12/08/06
 WESTWOOD PROFESSIONAL SERVICES

P:\2004\1126\dwg\Record\20041126UT01.dwg 12/8/2006 12:43:36 PM CST

E-3 20041126UT01.DWG
 Latest Revision Date: 12/20/04

Date: 08/06/04 Sheet: 3 OF 12

Westwood Professional Services, Inc.
 1859 Airgram Drive
 Eden Prairie, MN 55344

PHONE 952-937-5150
 FAX 952-937-9822
 TOLL FREE 1-888-937-5150

www.westwoodps.com

I hereby certify that this plan was prepared by me or under my direct supervision and that I am a duly licensed PROFESSIONAL ENGINEER under the laws of the State of Minnesota.

Jason M. McCarty
 Date: 12/08/06 License No. 41955

Revision	Date	By	Check
09/14/04 CITY REVIEW (HW)			
10/19/04 ADD 186TH CIRCLE, 187TH AVENUE			
11/04/04 CITY REVIEW (SH)			
11/18/04 SMITH DRIVE DATUM ALIGNMENT (CLJ)			
12/20/04 SMITH DRIVE REVISION (SH)			
12/22/06 RECORD DRAWING (SH)			
12/08/06 RECORD DRAWING-DOM COMMENTS (SHW)			

Designed:	JHM
Checked:	CKJ
Drawn:	HW
Record Drawing by/date:	

Prepared for:

D.R. Horton, Inc.
 20860 Kenbridge Court, Suite 100
 Lakeville, MN 55044

Trott Brook Farms
10th Addition
 Elk River, Minnesota

Sanitary Sewer and Water Main Record Plans
 Smith Drive