

SURMOUNTABLE CONCRETE CURB AND GUTTER

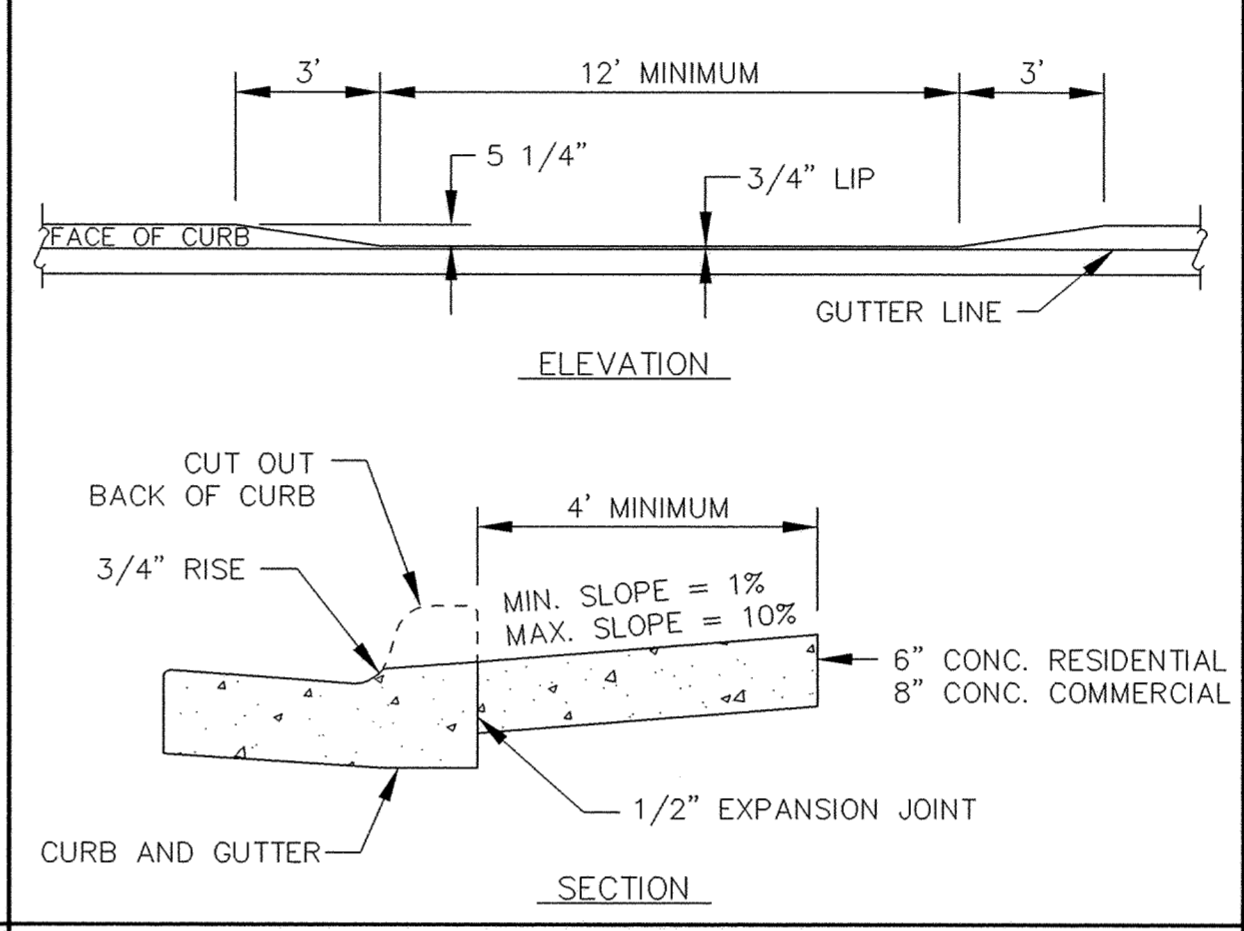

DEPRESSED CURB WITH DRIVEWAY APRON

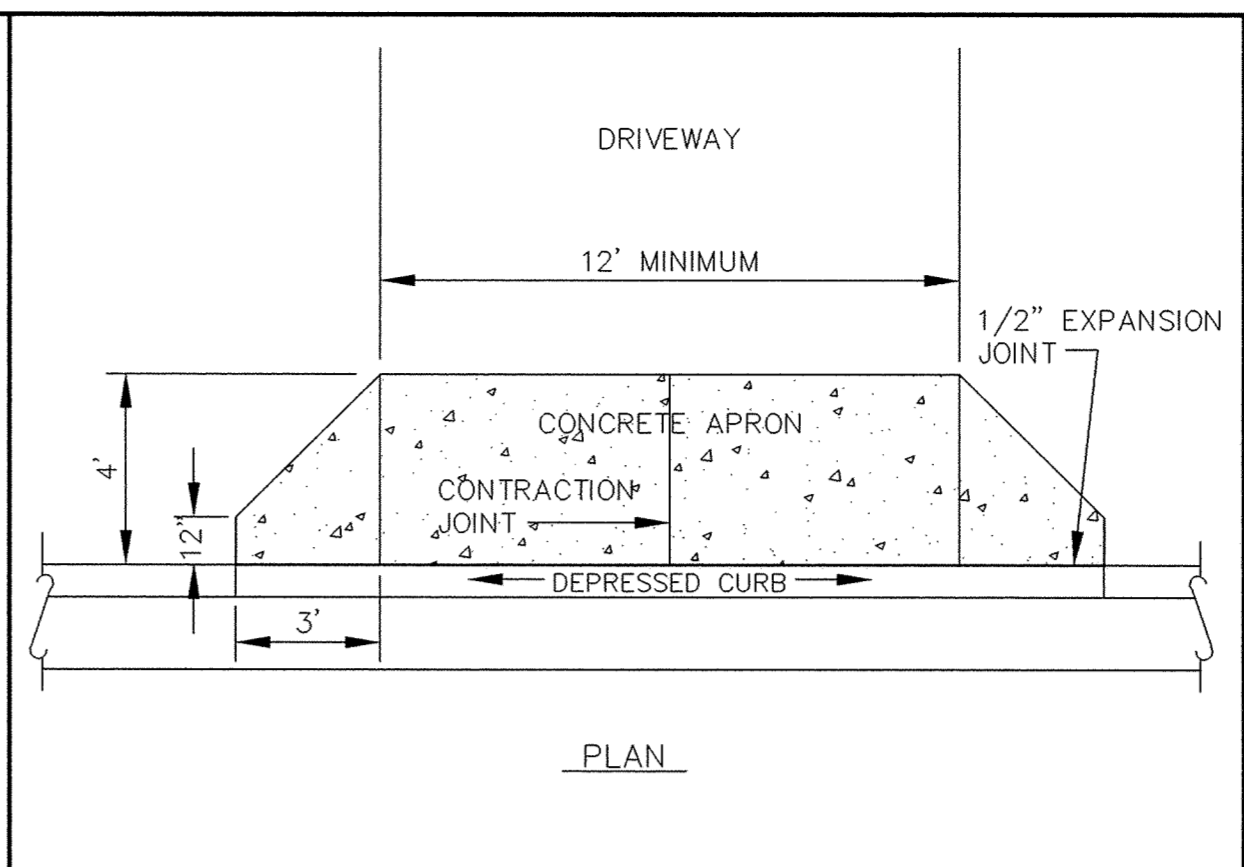
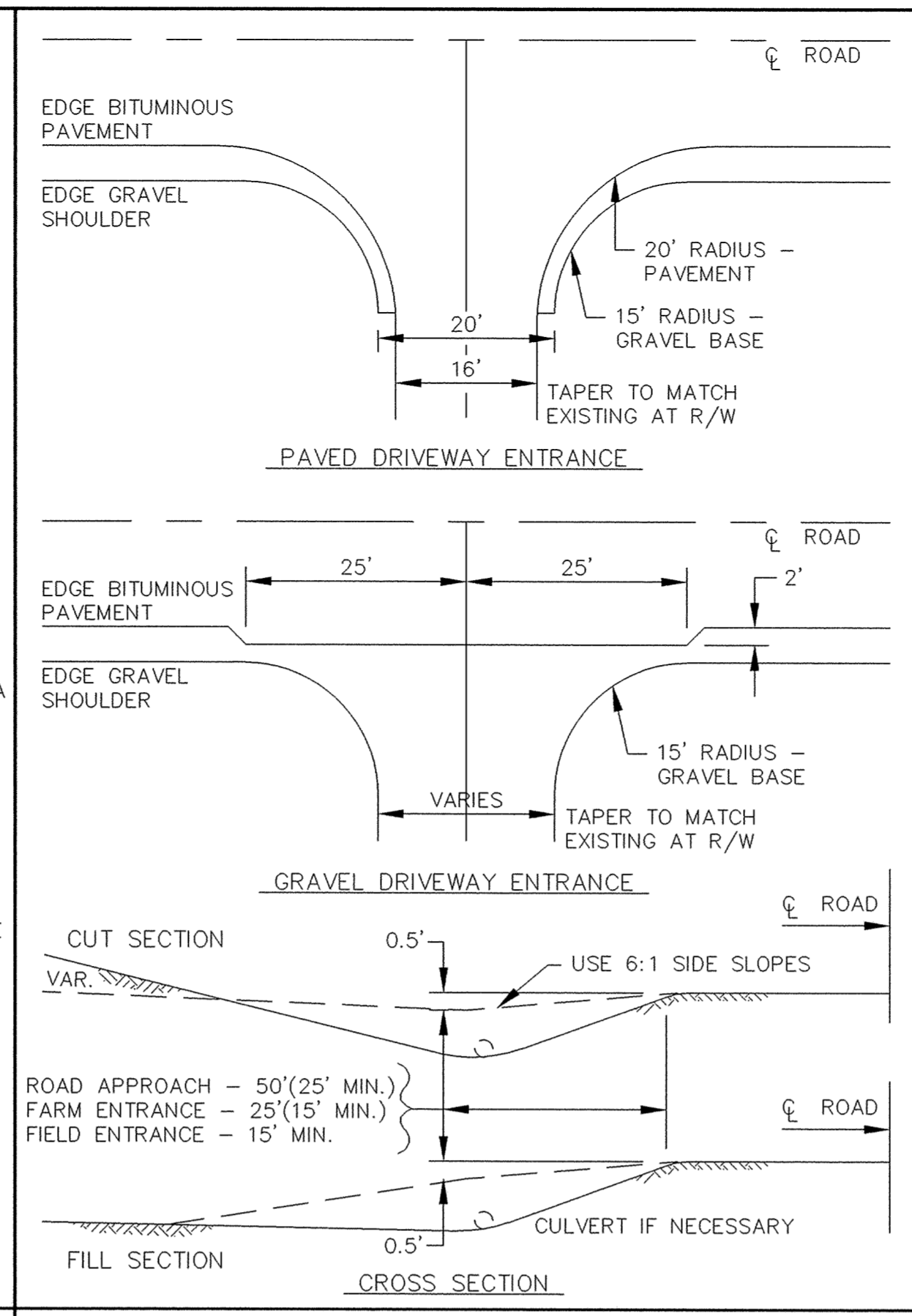

RURAL DRIVEWAY ENTRANCE

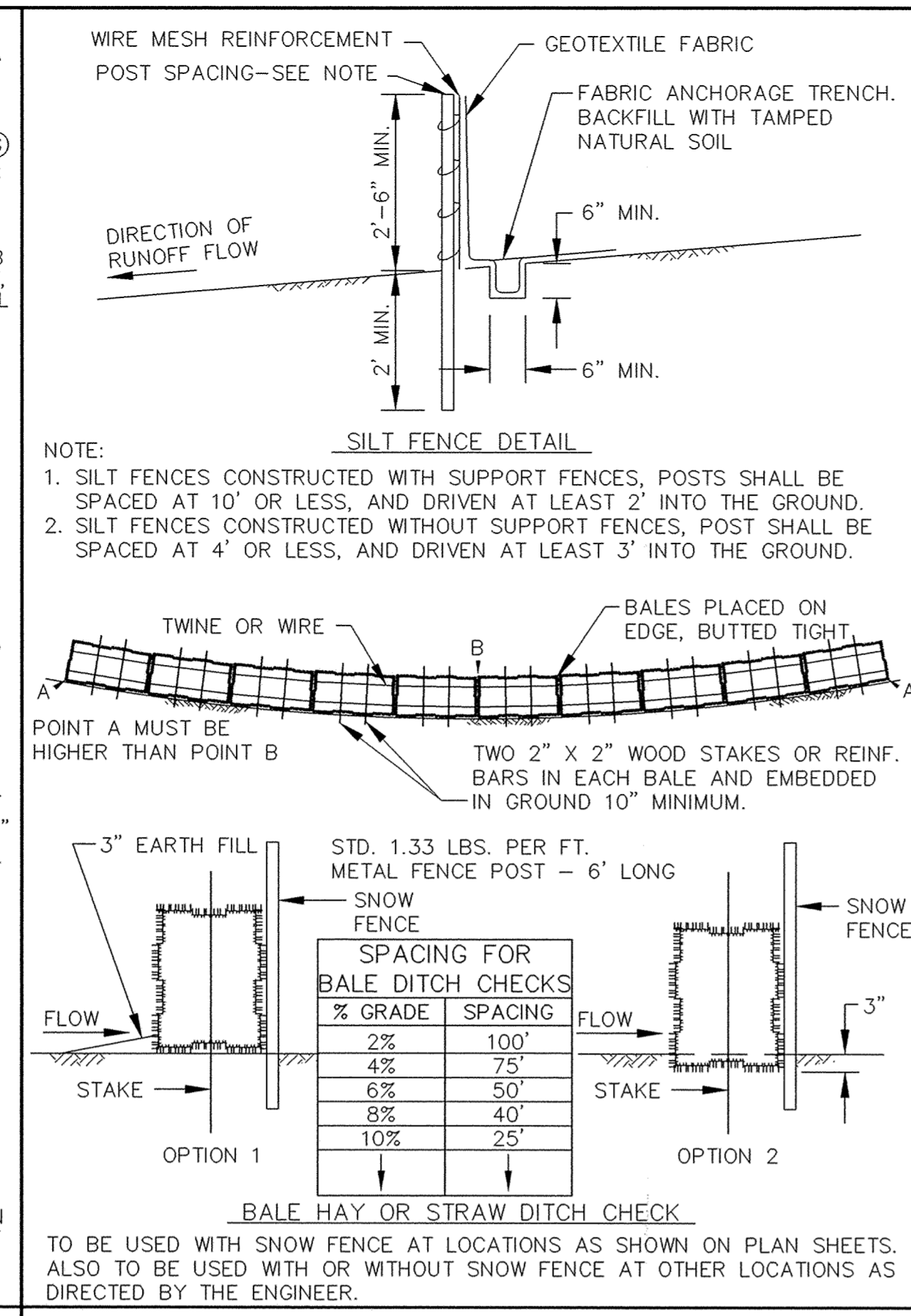

EROSION CONTROL DETAIL

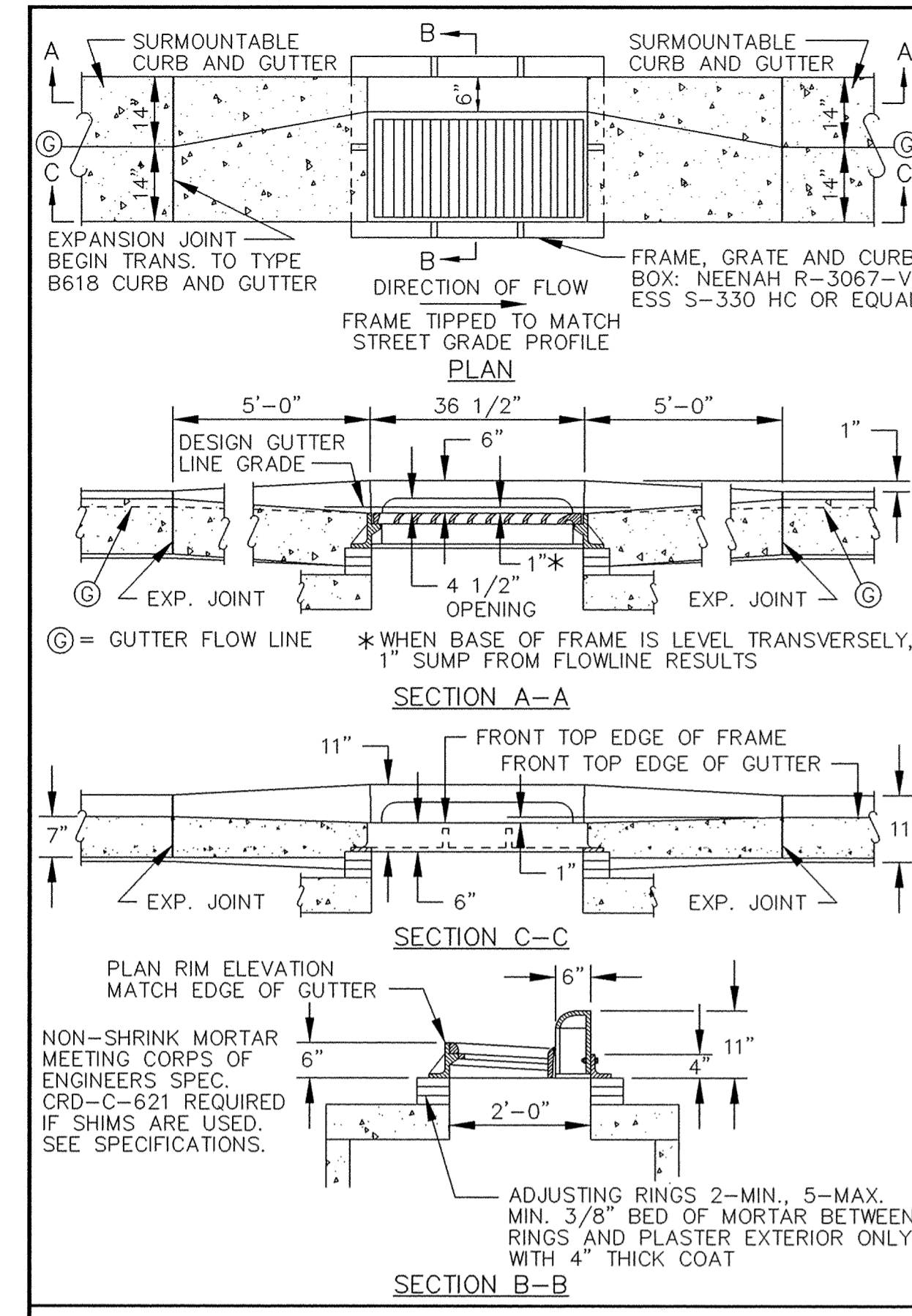

CATCH BASIN FRAME PLACEMENT SURMOUNTABLE CURB AND GUTTER

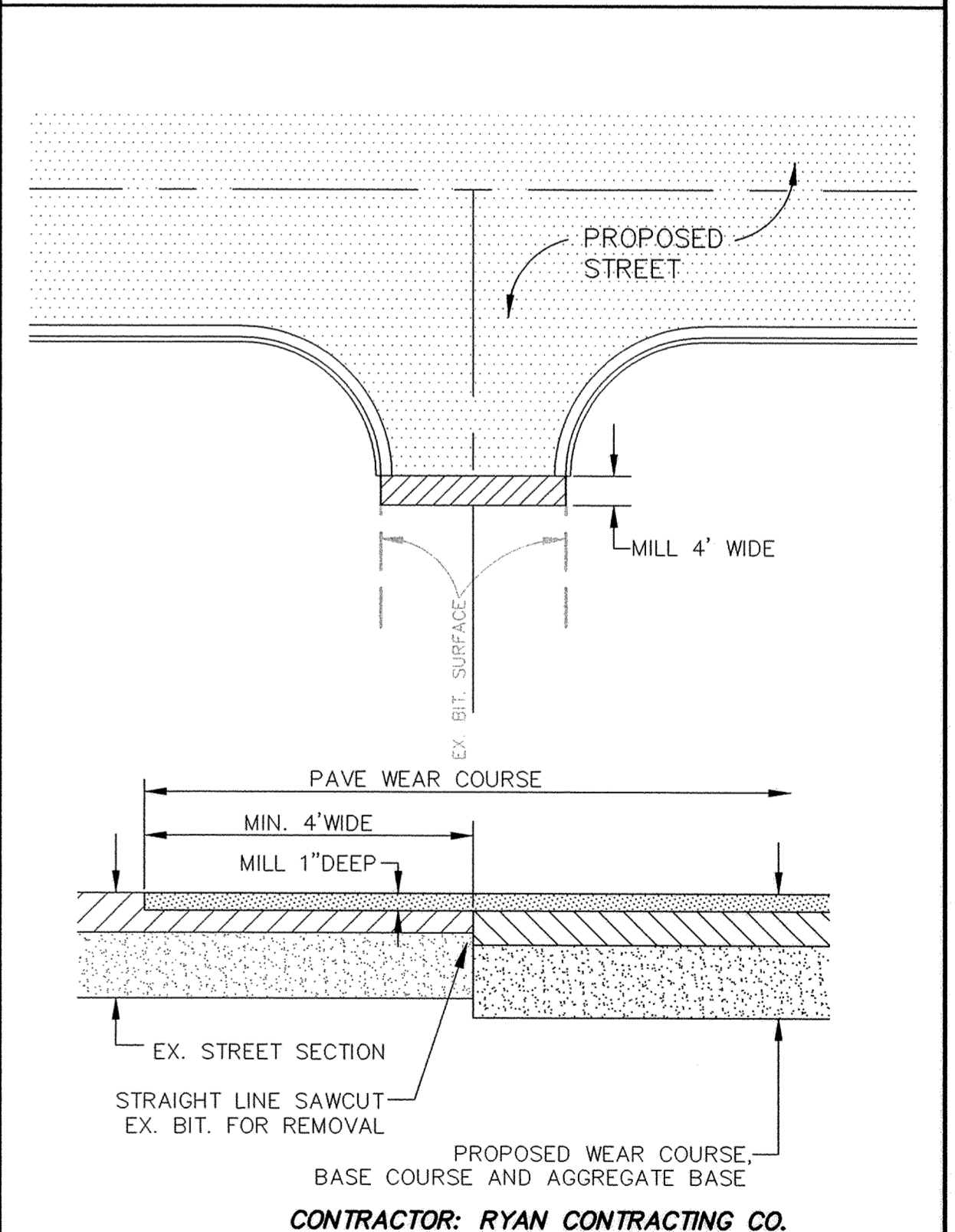

MATCH EXISTING BITUMINOUS SURFACING

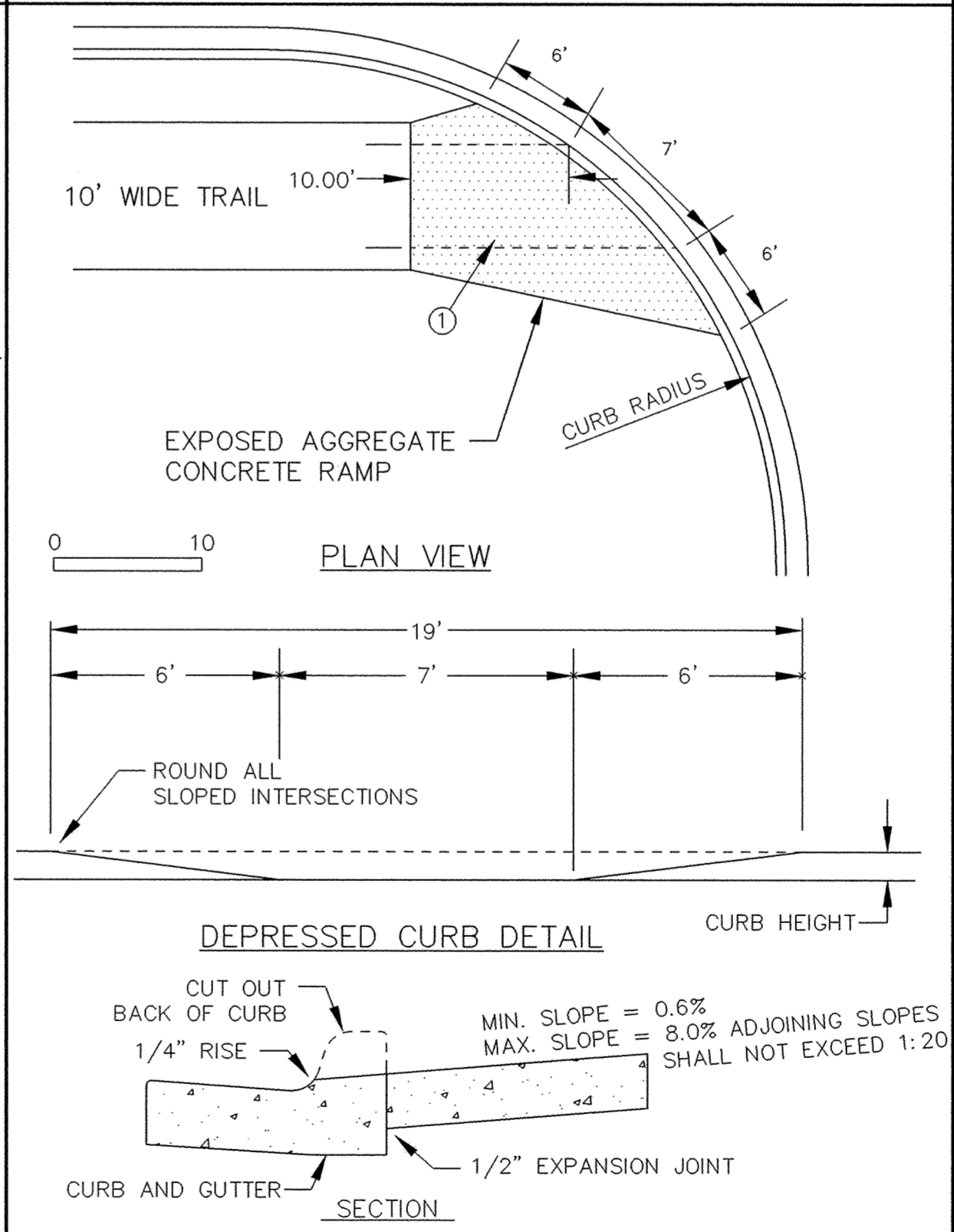

PEDESTRIAN CURB RAMPS FOR TRAILS

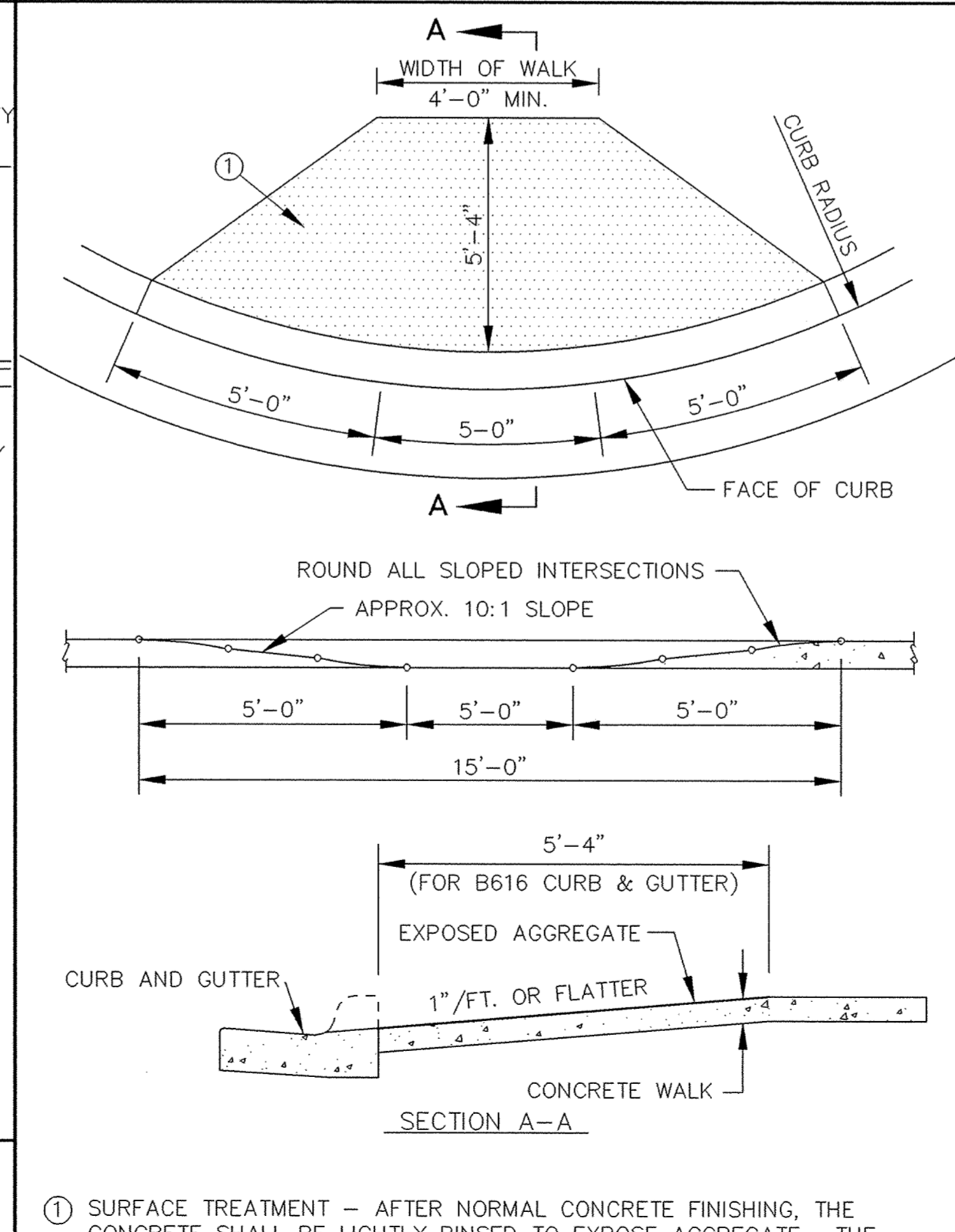

PEDESTRIAN CURB RAMPS FOR SIDEWALKS

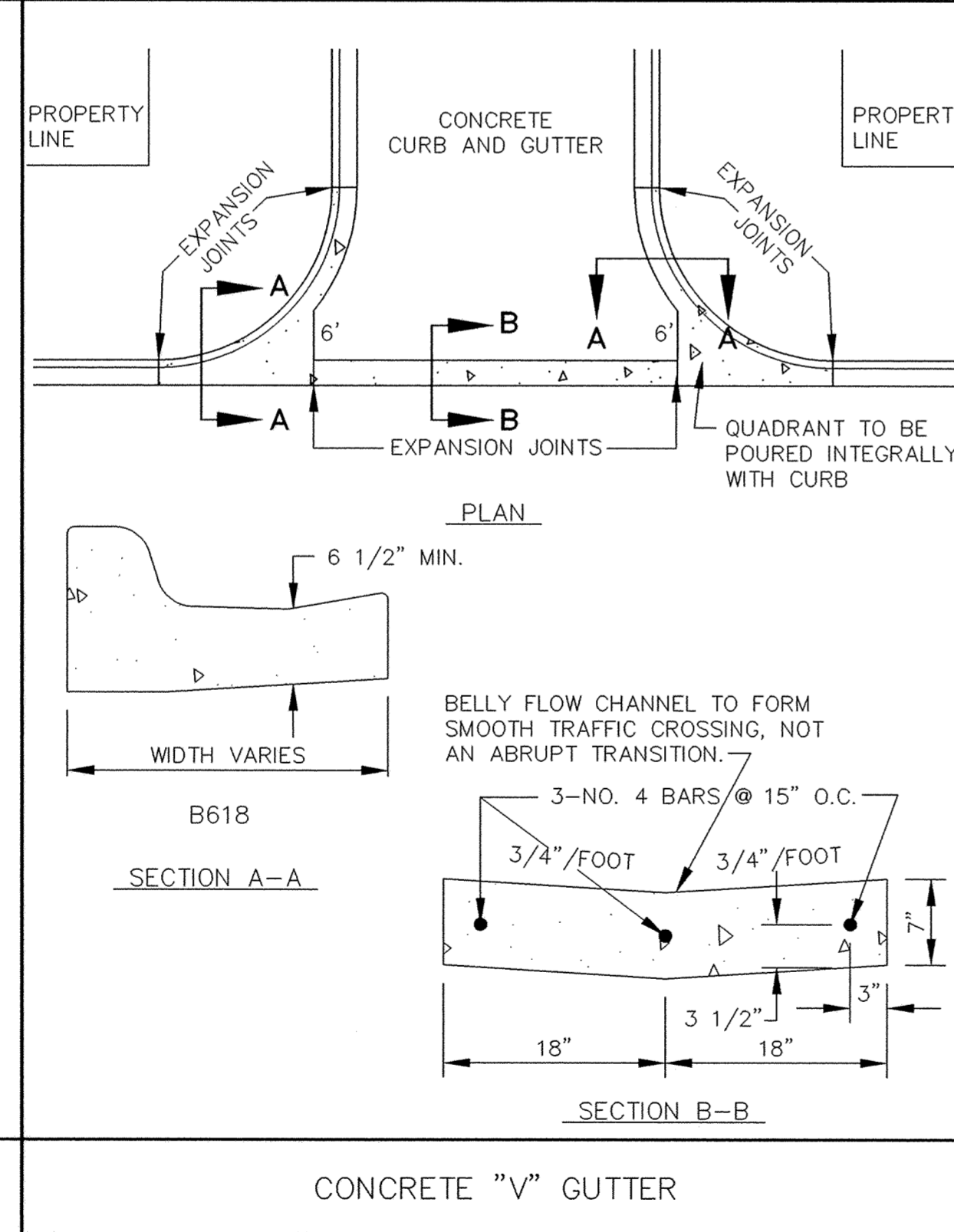

CONCRETE "V" GUTTER

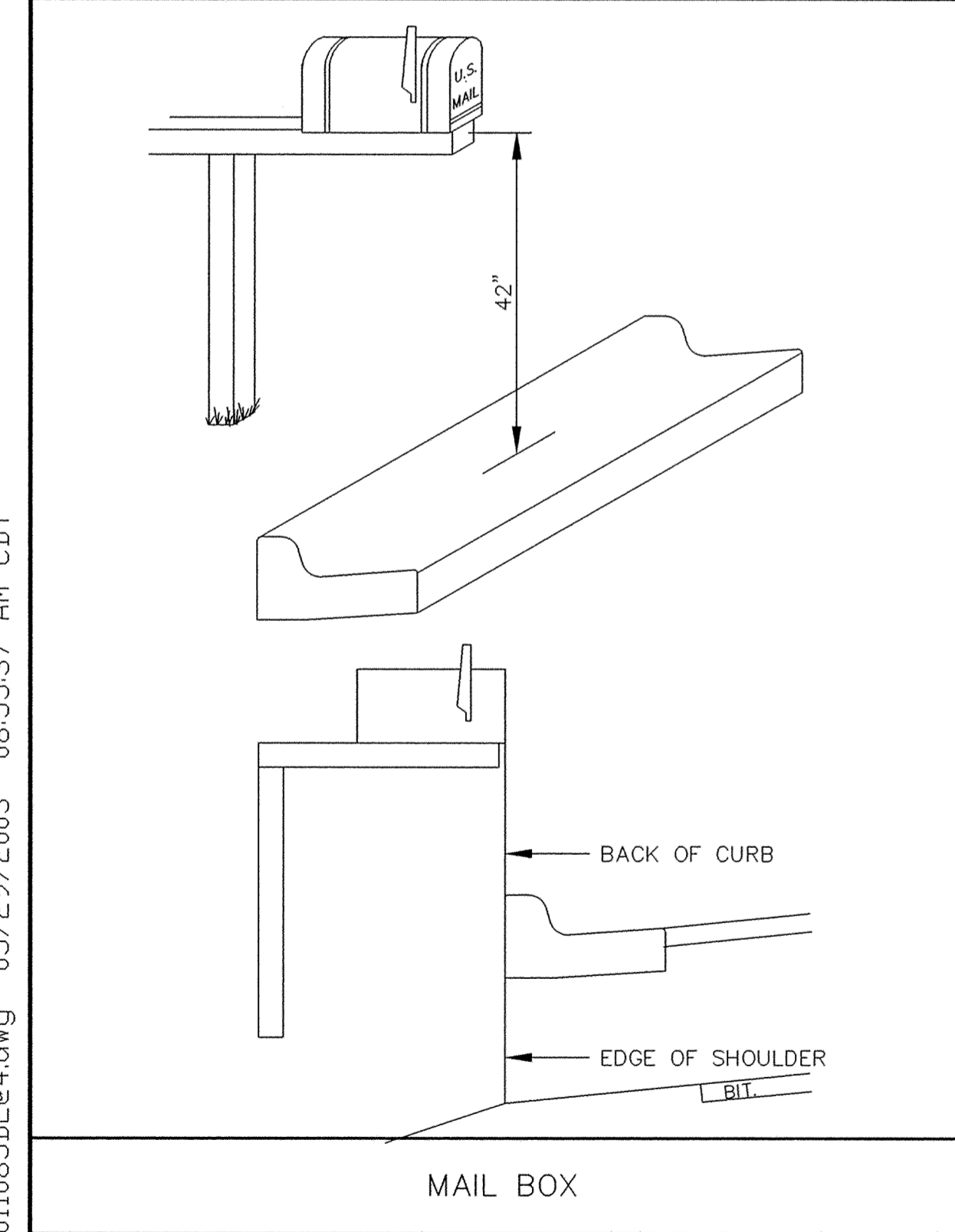

MAIL BOX

CONTRACTOR: RYAN CONTRACTING CO.  
 RECORD DRAWING  
 CONFORMING TO CONSTRUCTION RECORDS.  
 BY AL SPILLES DATE 05/29/03  
 WESTWOOD PROFESSIONAL SERVICES

**Westwood Professional Services, Inc.**  
 7599 Anagram Drive  
 Eden Prairie, MN 55344  
 Phone: 952/937-5150 Fax: 952/937-5822

PREPARED FOR:  
**D. R. Horton, Inc.**  
 20860 Kenbridge Court  
 Lakeville, Minnesota 55044

1326 ENERGY PARK DRIVE  
 ST. PAUL, MINNESOTA 55108  
 (612) 644-4389  
**Howard R. Green Company**  
 CONSULTING ENGINEERS

**CITY OF ELK RIVER**  
**TROTT BROOK FARMS EIGHTH ADDITION**  
**STREET CONSTRUCTION DETAILS**

SHEET NO.  
**16**  
 OF  
**17**

DESIGNED BY: --- DRAWN BY: ---  
 APPROVED: --- JOB NUMBER: ---  
 CAD DATE: April 14, 1999 11:17:32 a.m.  
 CAD FILE: 230000m\ER-ST.DWG

I HEREBY CERTIFY THAT THIS PLAN, SPECIFICATION,  
 OR REPORT WAS PREPARED BY ME OR UNDER MY DIRECT  
 SUPERVISION AND THAT I AM A DULY REGISTERED  
 PROFESSIONAL ENGINEER UNDER THE LAWS OF THE  
 STATE OF MINNESOTA.  
 DATE: \_\_\_\_\_ REG. NO. \_\_\_\_\_

NO.	DATE	BY	REVISION DESCRIPTION
1	05/29/03	GKB	RECORD DRAWING

P:\20011085\dwg\RECORD\20011085DE@4.dwg 05/29/2003 08:55:37 AM CDT