

**GENERAL NOTES:**

(XXX.X) DENOTES SANITARY SEWER SERVICE INVERT @ PROPERTY LINE.

(WYE=X+XX) DENOTES SANITARY SEWER SERVICE WYE LOCATED ON MAINLINE FROM DOWN STREAM M.H.

FLAG HYDRANTS.

HYDRANTS TO BE PLACED 5' BEHIND BACK OF CURB.

EXTEND RODS ON DEEP VALVES.

ALL DROP MANHOLES WITH DROPS OVER 2' TO CONSTRUCTED USING OUTSIDE DROPS.

SANITARY SEWER & WATER SERVICES TO BE EXTENDED 10' PAST R.O.W. ON ALL LOTS

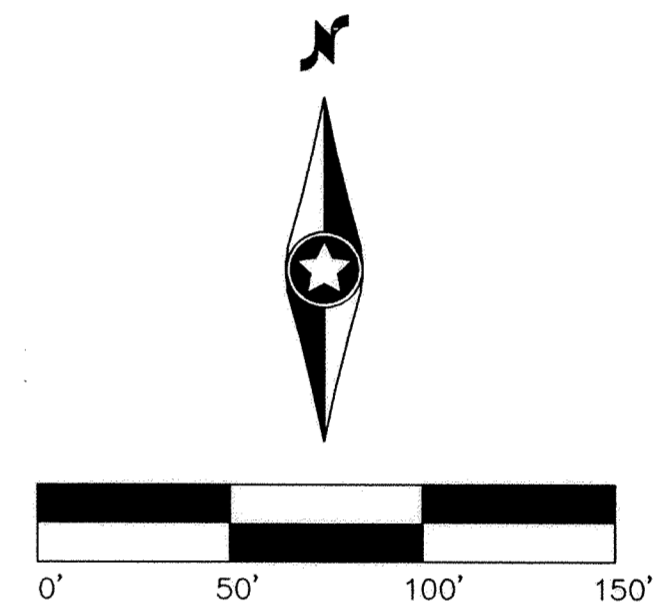

**OLSON STREET**

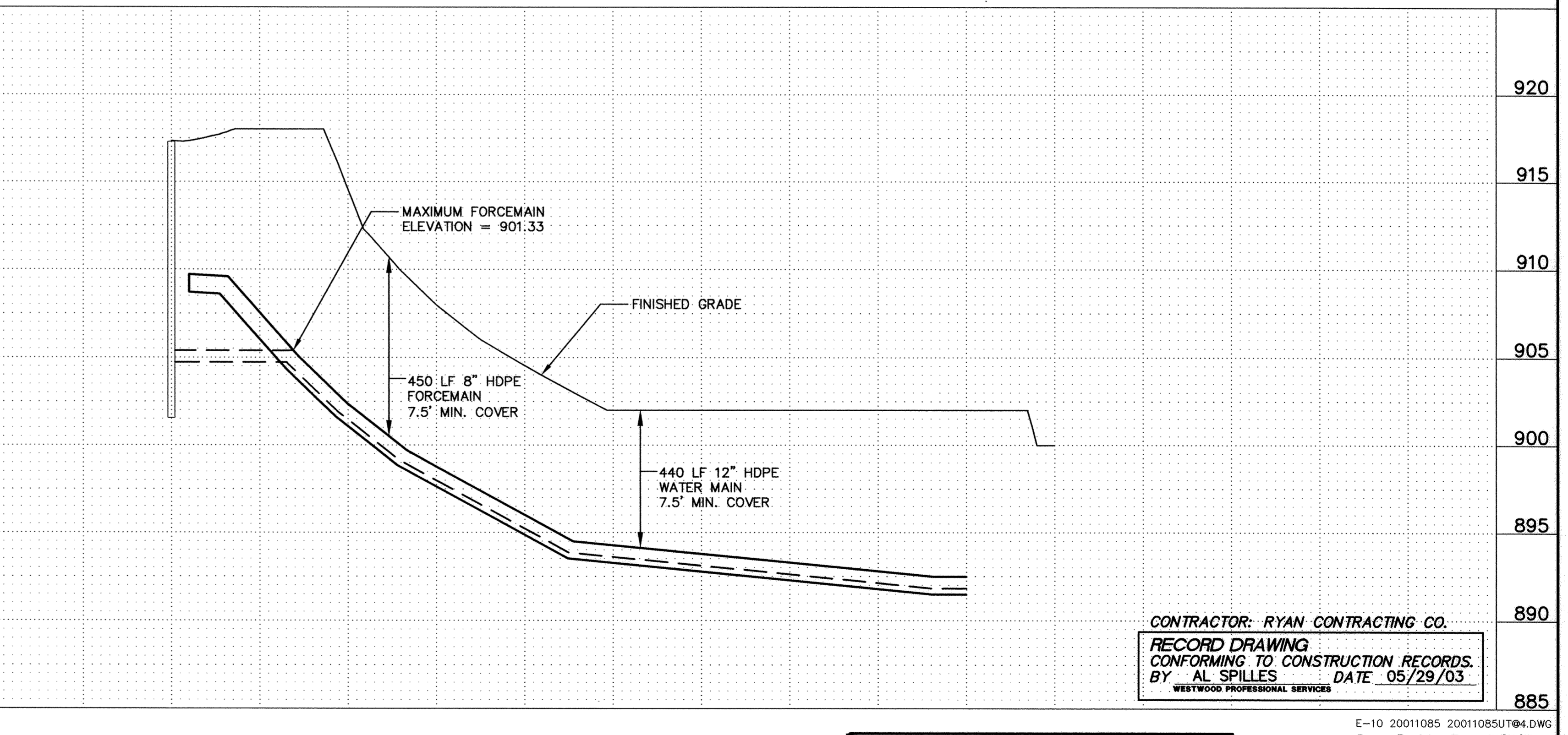
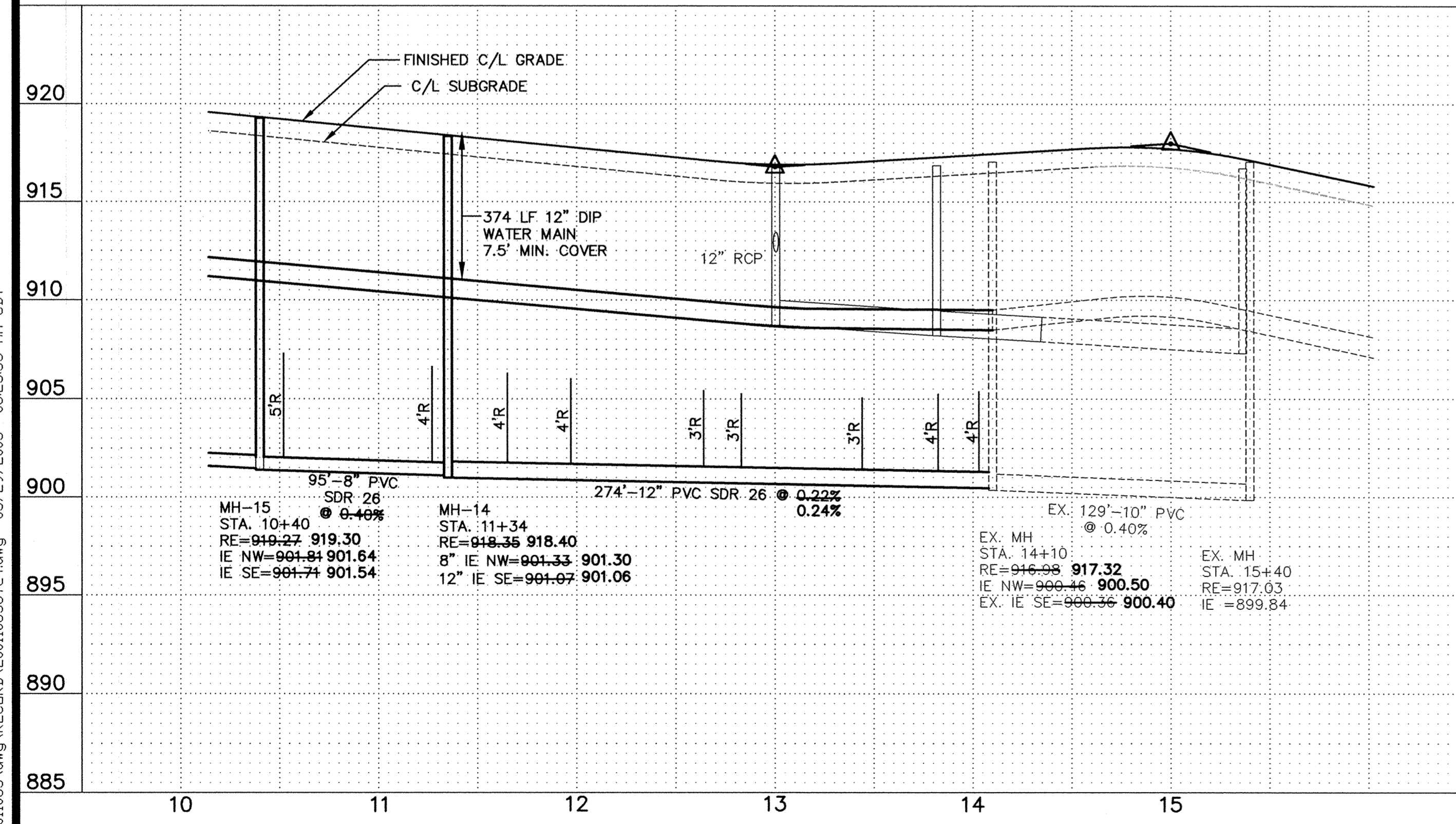

CONTRACTOR: RYAN CONTRACTING CO.  
 RECORD DRAWING  
 CONFORMING TO CONSTRUCTION RECORDS.  
 BY AL SPILLES DATE 05/29/03  
 WESTWOOD PROFESSIONAL SERVICES

P:\2001\085\dwg\RECORD\2001085UT04.dwg 05/29/2003 08:25:53 AM CDT

**Westwood Professional Services, Inc.**  
 7599 Anagram Drive  
 Eden Prairie, MN 55344  
 Phone: 952/937-5150 Fax: 952/937-5822

I hereby certify that this plan was prepared by me or under my direct supervision and that I am a duly licensed PROFESSIONAL ENGINEER under the laws of the State of Minnesota.  
  
**Francis D. Hagen, II**  
 Date: 05/29/03 License No. 17716

**Revisions:**  
 03/22/02 Grade/Lot Changes-WH  
 05/20/02 City Review-RNS  
 08/14/02 Route Taper Court Intersection - WH  
 05/29/03 RECORD DRAWINGS (AS/OKS)

**Designed:** FDH, II  
**Checked:** JMM  
**Drawn:** WH  
**Record Drawing by/date:** 5/29/03 AS

Prepared for:

**D.R. Horton, Inc.**  
 20860 Kenbridge Court  
 Lakeville, Minnesota 55044

**Trott Brook Farms  
 Eighth Addition**  
 Elk River, Minnesota

**Sanitary Sewer  
 and Water Main  
 Construction Plans**  
 Olson Street Sta. 10+40 - 14+54

E-10 20011085 20011085UT04.DWG  
 Latest Revision Date: 06/14/02  
 Date: 12/21/01 Sheet: 6 OF 17

DRAWING NUMBER  
 TROTTR8.03  
 6  
 SDCO PRODUCTS • NEW HARBOR, MINNESOTA  
 REVISION BY PART NUMBER COLOR  
 DRAWING NUMBER  
 DRAWING NUMBER  
 DRAWING NUMBER  
 DRAWING NUMBER