

GENERAL NOTES:

- RADIUS TO BE B618 C. & G. AS PER CITY DETAIL (TYP.)
- 25.90 * DENOTES GUTTERLINE ELEVATION AT INTERSECTIONS
- ALL RCP SHALL BE CLASS 4, UNLESS OTHERWISE NOTED

CASTING NOTE:

ALL CATCH BASIN CASTINGS IN CURB SHALL BE SUMPED 0.15 FEET AND MANHOLE CASTINGS IN PAVED AREAS SHALL BE SUMPED 0.05 FEET. RIM ELEVATIONS ON PLAN PROFILES REFLECT THE SUMPED ELEVATIONS.

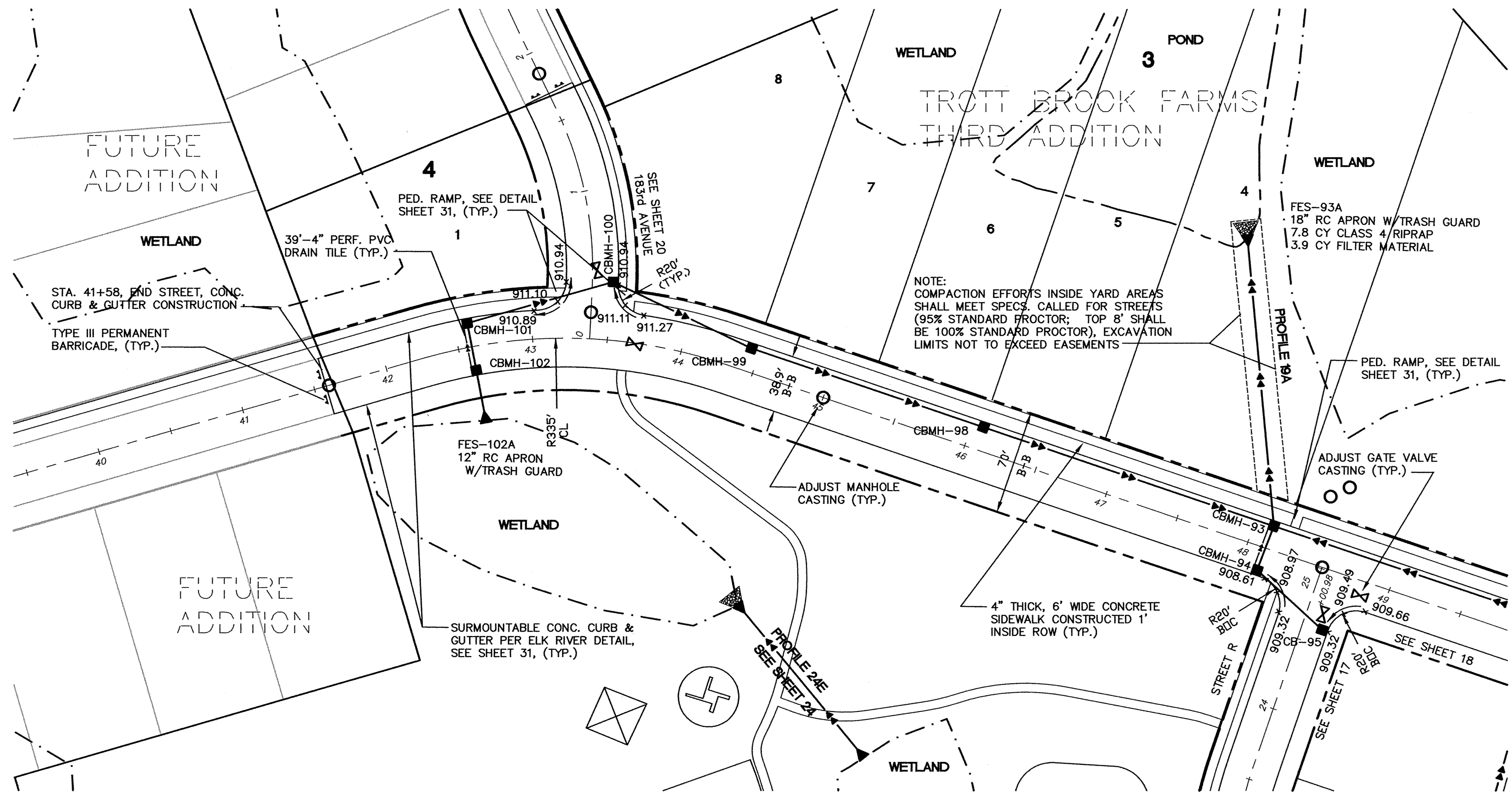

CONTRACTOR: RYAN CONTRACTING, INC.
RECORD DRAWING
 CONFORMING TO CONSTRUCTION RECORDS.
 BY S. HUTTNER DATE 7/20/01
 WESTWOOD PROFESSIONAL SERVICES

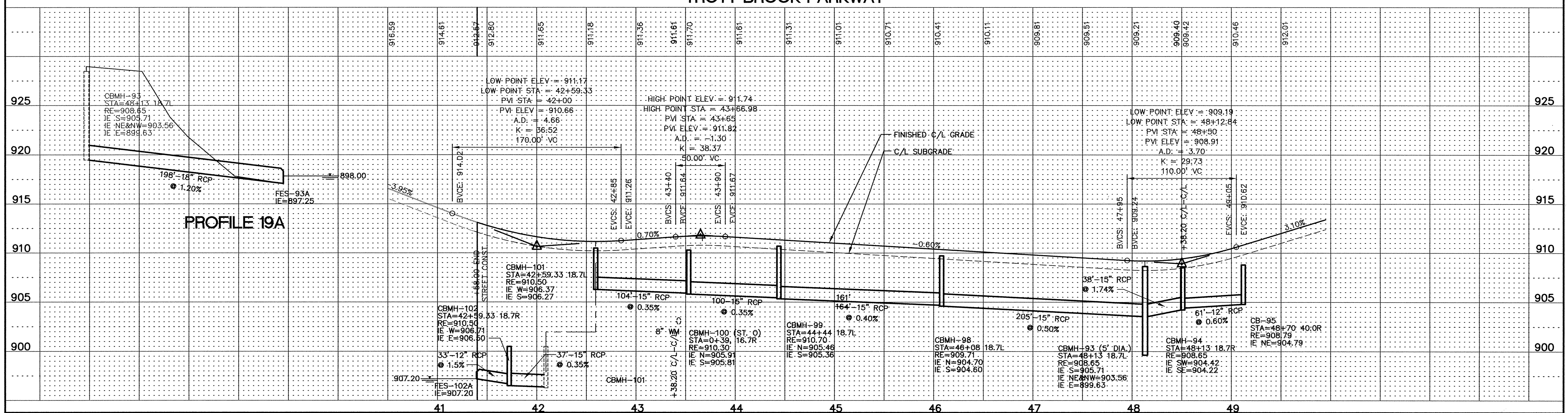
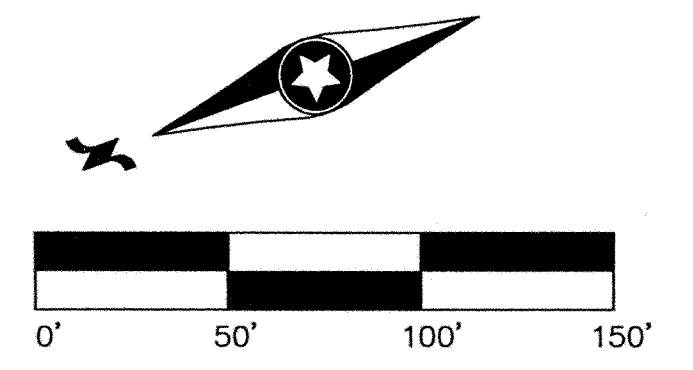

REVISIONS

6/28/99	
7/23/99	PER CITY REDLINES
7/27/99	PER CITY REDLINES

I hereby certify that this plan was prepared by me or under my direct supervision and that I am a duly registered PROFESSIONAL ENGINEER under the laws of the State of Minnesota.
 DATE 7/27/99 REG. NO. 17716

DESIGNED FDH, II CHECKED FDH, II
 DRAWN WH RECORD DRAWING BY/DATE

PREPARED FOR:
D.R. Horton, INC.
 3459 Washington Drive
 Suite 204
 Eagan, Minnesota 55122

Trott Brook Farms
 Elk River, Minnesota

Storm Sewer & Street Construction Plan

DATE 6/1/99
 SHEET 19 OF 32

LATEST REVISION DATE: 7/27/99

P:\96367.dwg\6367STF6.dwg 07/27/99 05:24:54 PM CDT

DRAWING NUMBER TROTT1-499 SHEET 19 OF 32
 S:\CADD\PROJECTS\NEW\96367\6367STF6.DWG
 PROJECT BY PHILIP HANSEN 05/22/99
 WESTWOOD PROFESSIONAL SERVICES, INC.
 7599 ANAGRAM DRIVE
 EDEN PRAIRIE, MN 55344
 612.937.5150