

Call 48 Hours before digging:  
**GOPHER STATE ONE CALL**  
 Twin City Area 651-454-0002  
 Mn. Toll Free 1-800-252-1166

**GENERAL NOTES:**  
 (XXX.X) DENOTES SANITARY SEWER SERVICE INVERT @ ROW LINE. ALL SERVICES SHALL BE EXTENDED 9' INTO PROPERTY WHERE SIDEWALK IS BEING CONSTRUCTED.  
 WYE=X+XX DENOTES SANITARY SEWER SERVICE WYE LOCATED ON MAINLINE FROM DOWN STREAM M.H.  
 FLAG HYDRANTS.  
 EXTEND RODS ON DEEP VALVES.

**CONTRACTOR: RYAN CONTRACTING, INC.**  
**RECORD DRAWING**  
 CONFORMING TO CONSTRUCTION RECORDS.  
 BY S. HUTTNER DATE 7/20/01  
 WESTWOOD PROFESSIONAL SERVICES

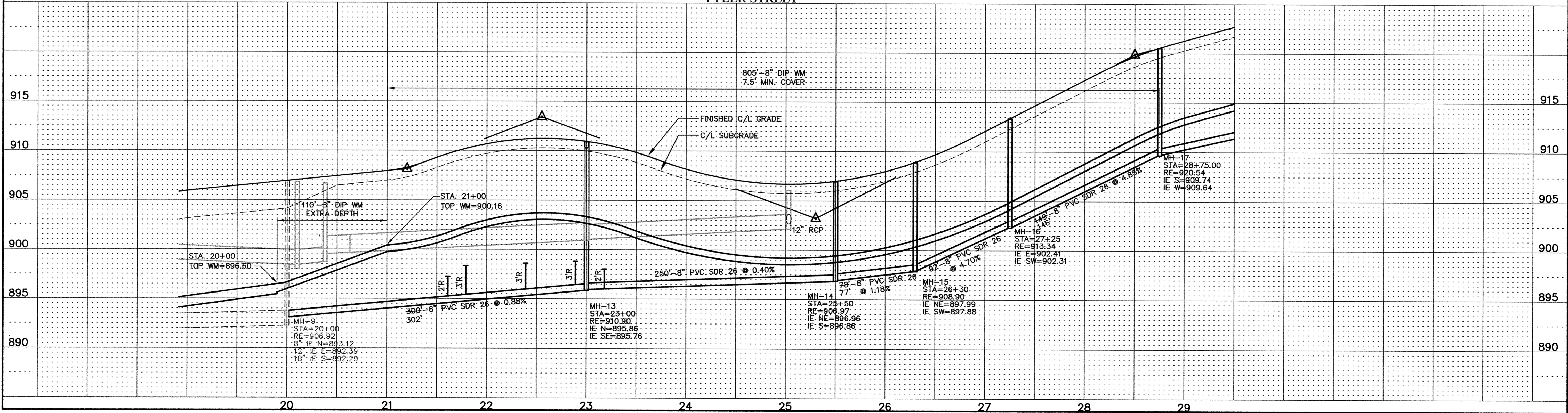
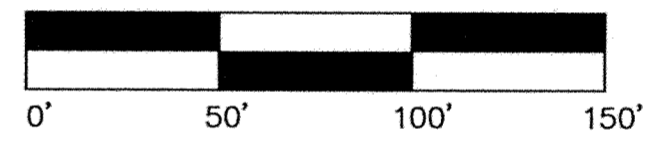

**REVISIONS**  
 6/28/99  
 7/23/99 PER CITY REDLINES  
 7/27/99 PER CITY REDLINES

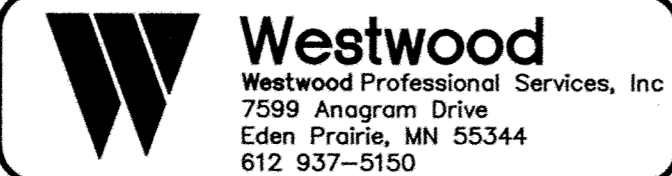

I hereby certify that this plan was prepared by me or under my direct supervision and that I am a duly registered PROFESSIONAL ENGINEER under the laws of the State of Minnesota.  
 DATE 7/27/99 REG. NO. 17716

DESIGNED FDH, II CHECKED FDH, II  
 DRAWN WH RECORD DRAWING BY/DATE

PREPARED FOR:  
**D.R. Horton, INC.**  
 3459 Washington Drive  
 Suite 204  
 Eagan, Minnesota 55122

**Trott Brook Farms**  
 Elk River, Minnesota

**Sanitary Sewer & Water Main Construction Plan**

DATE 6/1/99  
 SHEET 11 OF 32

DRAWING NUMBER

DRAWING NUMBER

DRAWING NUMBER

DRAWING NUMBER  
 TROTT14-99  
 11