

DRAWING NUMBER
SEALC 93
1

SAFCD PRODUCTS • NEW LORCE, MINNESOTA
RECORDED BY PART NUMBER E652
FURNISHED UNDER A LICENSE FROM THE STATE

DRAWING NUMBER

SAFCD PRODUCTS • NEW LORCE, MINNESOTA
RECORDED BY PART NUMBER E652
FURNISHED UNDER A LICENSE FROM THE STATE

DRAWING NUMBER

SAFCD PRODUCTS • NEW LORCE, MINNESOTA
RECORDED BY PART NUMBER E652
FURNISHED UNDER A LICENSE FROM THE STATE

DRAWING NUMBER
SEALC 93
1

SAFCD PRODUCTS • NEW LORCE, MINNESOTA
RECORDED BY PART NUMBER E652
FURNISHED UNDER A LICENSE FROM THE STATE

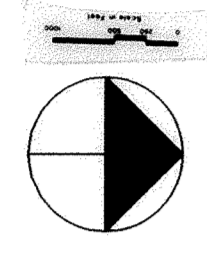
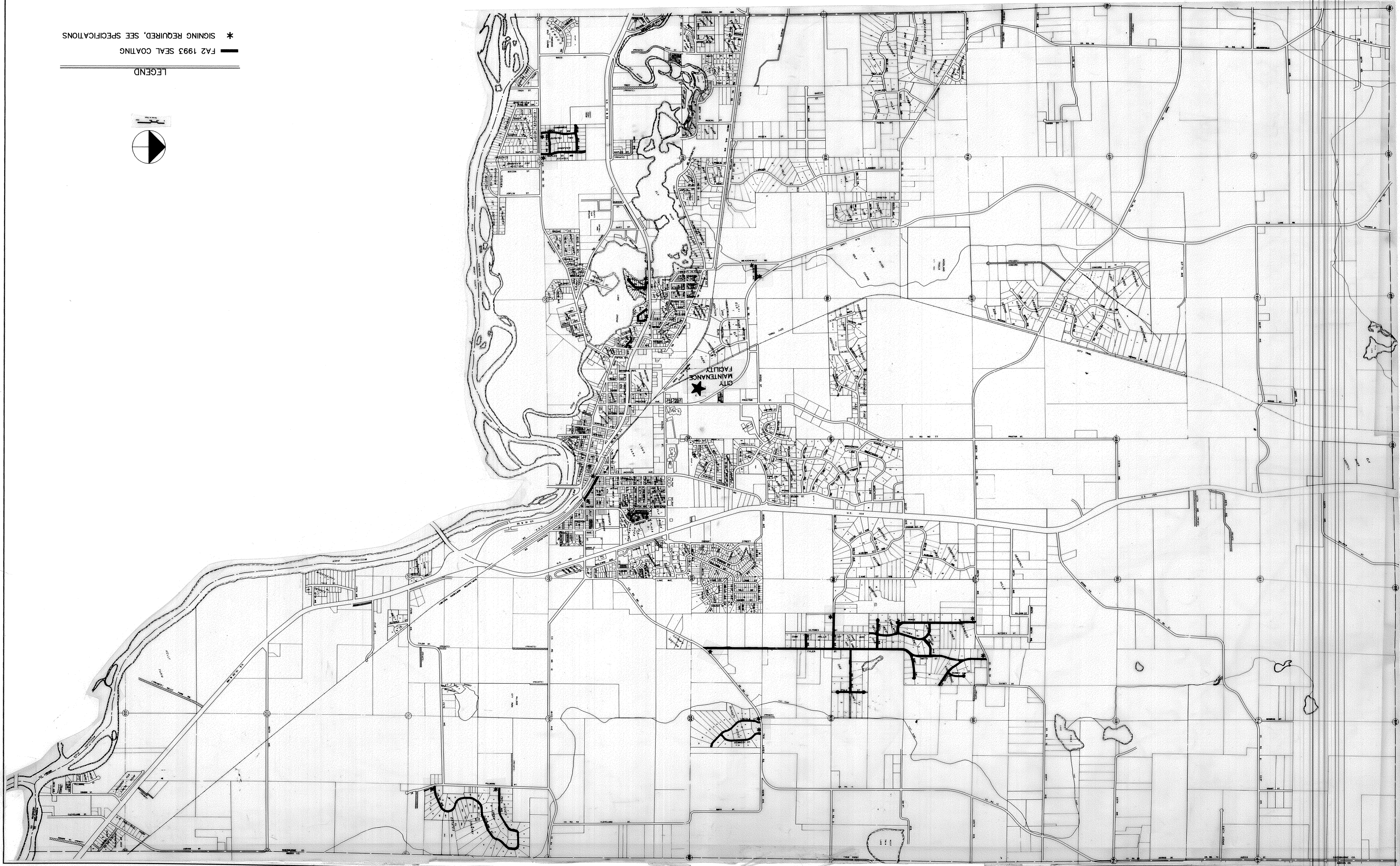

LEGEND

— FA2 1993 SEAL COATING

* SIGNING REQUIRED, SEE SPECIFICATIONS

DESIGNED			
CHECKED			
DRAWN	CLS		
GRAPHIC SCALE			
HORIZ.	0		
VERT.	0		
DATE	JULY 1993	SHEET	1 OF 1 SHEETS
PROJECT NO. 230-188			

REVISIONS

DATE		DESCRIPTION

CONSULTING ENGINEERS
Water Stewart & Associates Inc.
ST. PAUL, MINNESOTA 55117
(612) 774-6021
9800 SHELDON PARKWAY (612) 546-0432
MINNEAPOLIS, MINNESOTA 55444
1959 SLOAN PLACE

I HEREBY CERTIFY THAT THIS PLAN, SPECIFICATION OR REPORT WAS PREPARED BY ME OR UNDER MY DIRECT SUPERVISION AND THAT I AM A DULY REGISTERED PROFESSIONAL ENGINEER UNDER THE LAWS OF THE STATE OF MINNESOTA.

Andy G. Mauer
REG. NO. 53916
DATE 7-16-93

725