

# JACKSON AVENUE

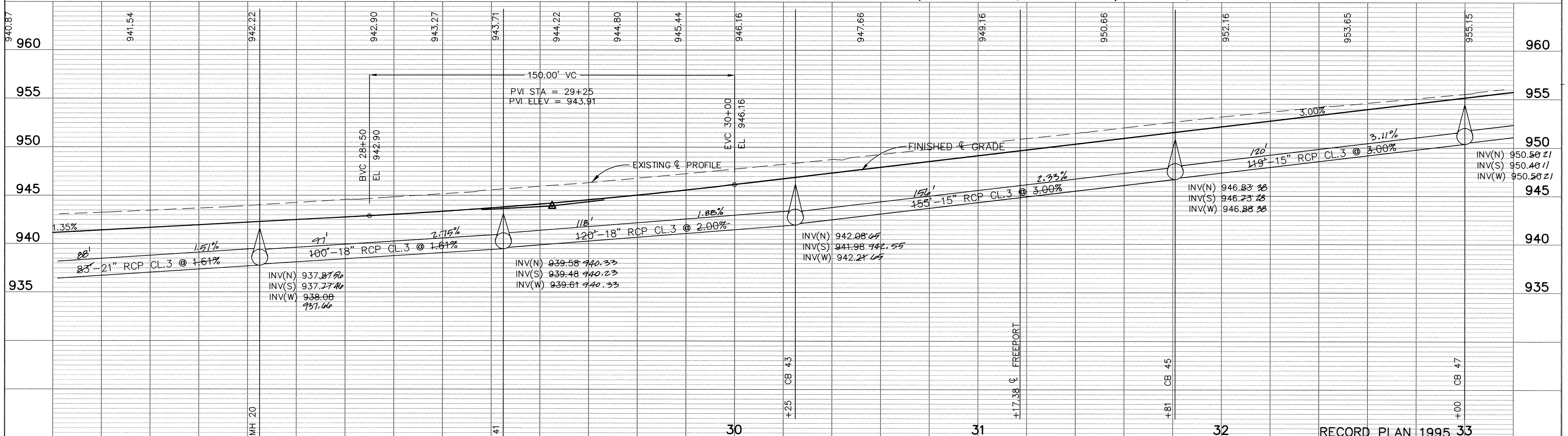

I HEREBY CERTIFY THAT THIS PLAN, SPECIFICATION, OR REPORT WAS PREPARED BY ME OR UNDER MY DIRECT SUPERVISION AND THAT I AM A DULY REGISTERED PROFESSIONAL ENGINEER UNDER THE LAWS OF THE STATE OF MINNESOTA.

*Paul Patton*  
DATE: 4-29-94 REG. NO. 13929

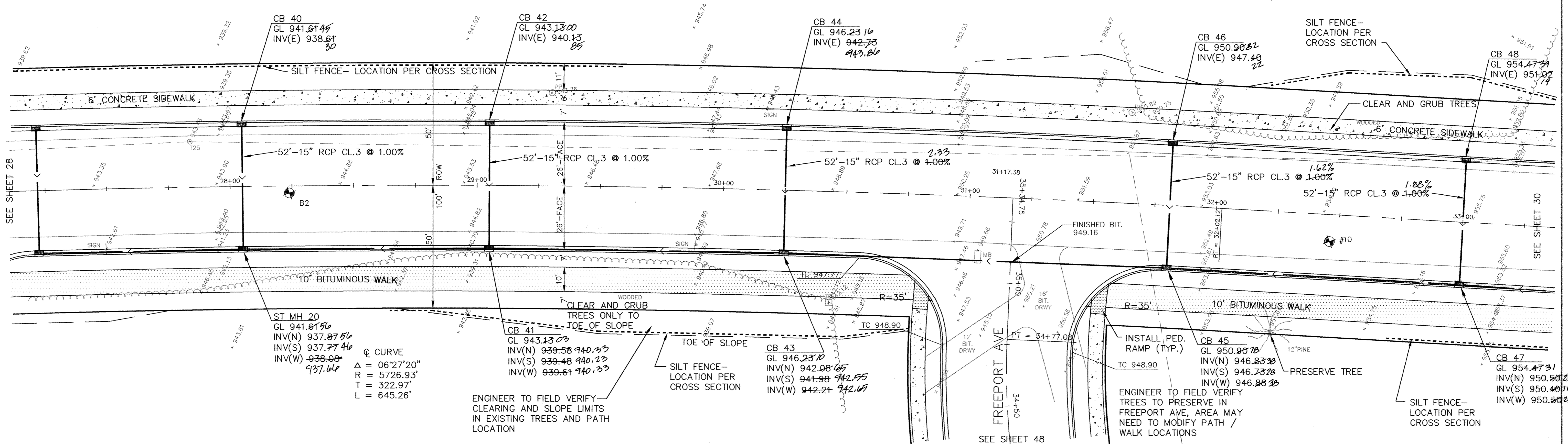
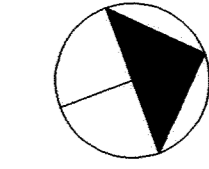

1326 ENERGY PARK DRIVE  
ST. PAUL, MINNESOTA 55108  
(612) 644-4389

9800 SHELARD PARKWAY  
MINNEAPOLIS, MINNESOTA 55441  
(612) 546-0432

REVISIONS	DATE	DESCRIPTION	DESIGNED	PEB
	5/20/94	STATE AID COMMENTS	CHECKED	
			DRAWN	
			GRAPHIC SCALE	
			0 HORIZ. 20	
			0 VERT. 5	

CITY OF ELK RIVER  
JACKSON AVE. RECONSTRUCTION  
SCHOOL ST. TO T.H. 169  
S.A.P. 204-104-04 MTB 27+50 TO 33+00

DATE: APRIL 1994 SHEET 29 OF 74 SHEETS PROJECT NO. 230-216

DRAWING NUMBER 29

SAECO PRODUCTS • NEW HOPE, MINNESOTA  
REPRODUCED BY PART NUMBER 8352

DRAWING NUMBER 29

SAECO PRODUCTS • NEW HOPE, MINNESOTA  
REPRODUCED BY PART NUMBER 8352

DRAWING NUMBER 29

SAECO PRODUCTS • NEW HOPE, MINNESOTA  
REPRODUCED BY PART NUMBER 8352

DRAWING NUMBER 29