

# JACKSON AVENUE

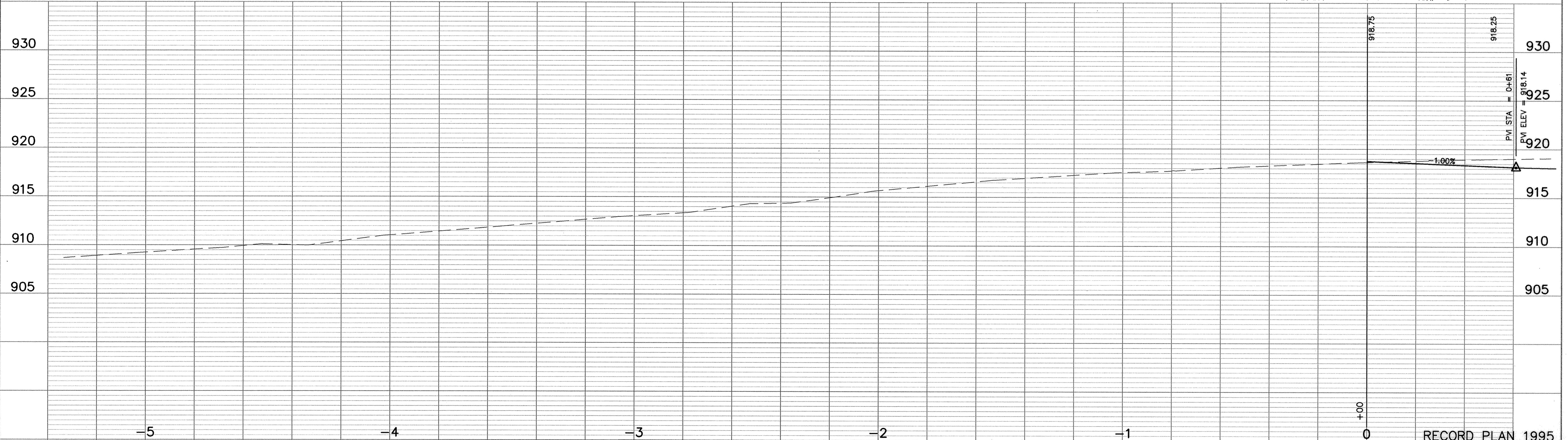
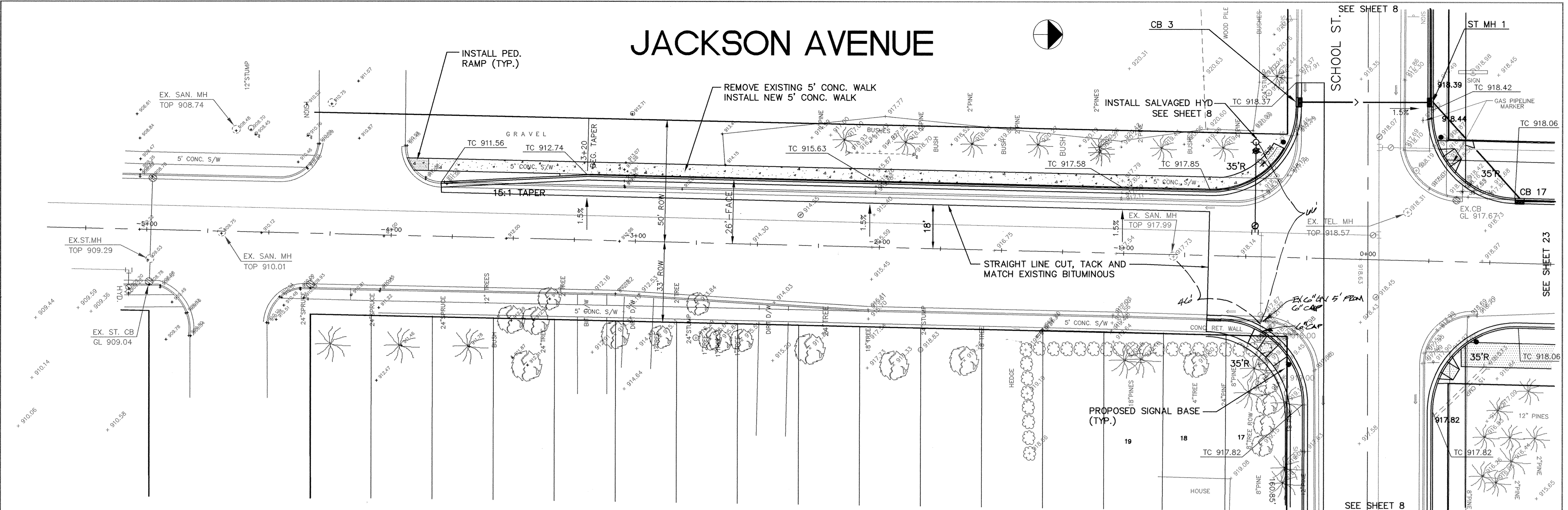

ER216J1	I HEREBY CERTIFY THAT THIS PLAN, SPECIFICATION, OR REPORT WAS PREPARED BY ME OR UNDER MY DIRECT SUPERVISION AND THAT I AM A DULY REGISTERED PROFESSIONAL ENGINEER UNDER THE LAWS OF THE STATE OF MINNESOTA. <i>Paul Faith</i> DATE 6-2-94 REG. NO. 13929		1326 ENERGY PARK DRIVE ST. PAUL, MINNESOTA 55108 (612) 644-4389  9800 SHELARD PARKWAY MINNEAPOLIS, MINNESOTA 55441 (612) 546-0432	DATE	DESCRIPTION	DESIGNED PER	CITY OF ELK RIVER JACKSON AVE. RECONSTRUCTION SCHOOL ST. TO T.H. 169 S.A.P. 204-104-04MTB -6+00 TO 0+00	DATE	SHEET	PROJECT NO.
				6-2-94	REVISE HYD. NOTES	CHECKED DRAWN		APRIL 1994	22 OF 74 SHEETS	230-216

DRAWING NUMBER  
 SCHOO 95  
 22  
 DRAWING NUMBER  
 823