

SCHOOL STREET

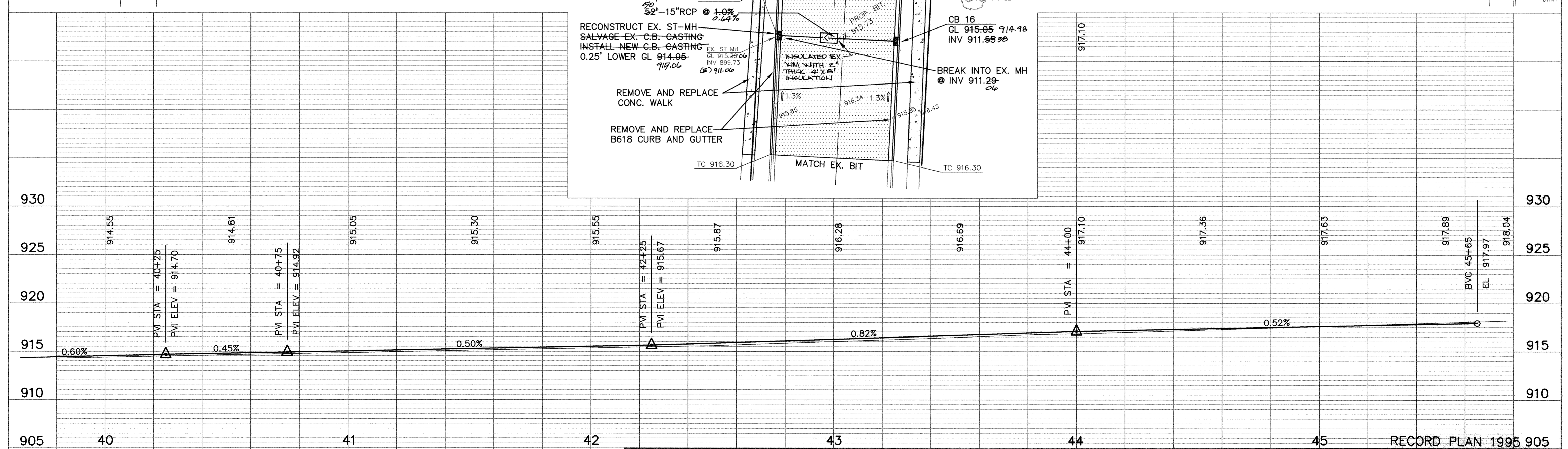
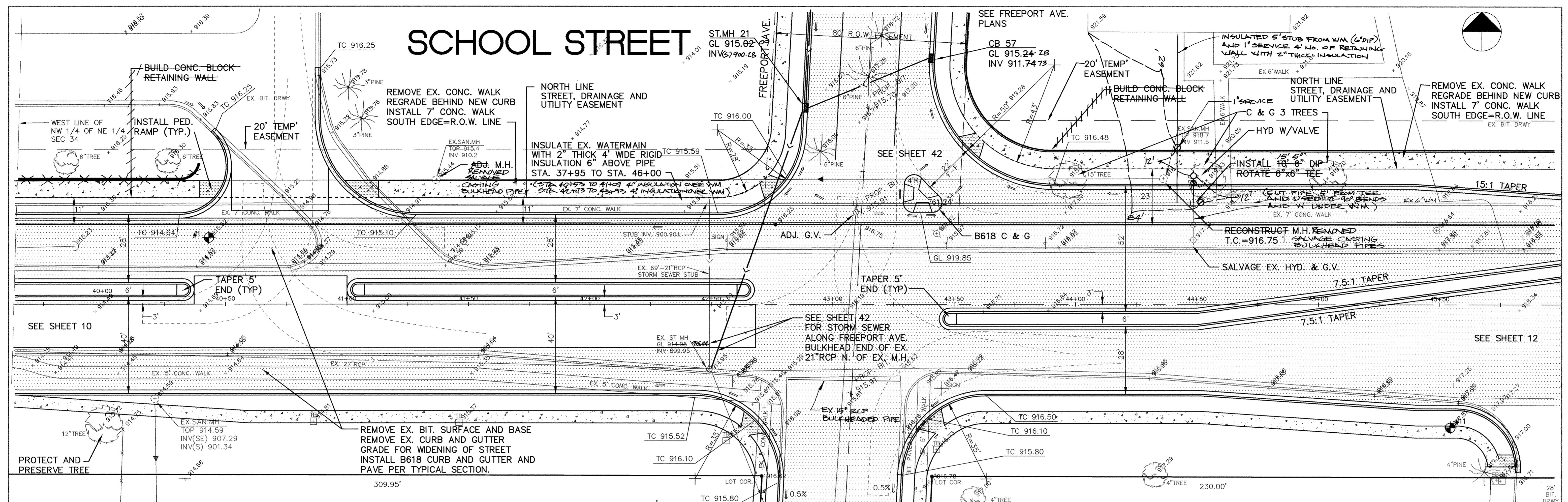

I HEREBY CERTIFY THAT THIS PLAN, SPECIFICATION, OR REPORT WAS PREPARED BY ME OR UNDER MY DIRECT SUPERVISION AND THAT I AM A DULY REGISTERED PROFESSIONAL ENGINEER UNDER THE LAWS OF THE STATE OF MINNESOTA.

Fred Brink
DATE 6-2-94 REG. NO. 13929

MSA
CONSULTING ENGINEERS

1326 ENERGY PARK DRIVE
ST. PAUL, MINNESOTA 55108
(612) 644-4389

9800 SHELARD PARKWAY
MINNEAPOLIS, MINNESOTA 55441
(612) 546-0432

DATE	DESCRIPTION	DESIGNED	PER
6-1-94	7.5:1 TAPER - MEDIAN 15:1 TAPER - N. CURB	CHECKED	
		DRAWN	

GRAPHIC SCALE
0 HORIZ. 20
0 VERT. 5

CITY OF ELK RIVER
STREET RECONSTRUCTION
SCHOOL STREET
204-107-04 40+00 TO 45+00

DATE APRIL 1994 SHEET 11 OF 74 SHEETS PROJECT NO. 230-216