

SCHOOL STREET

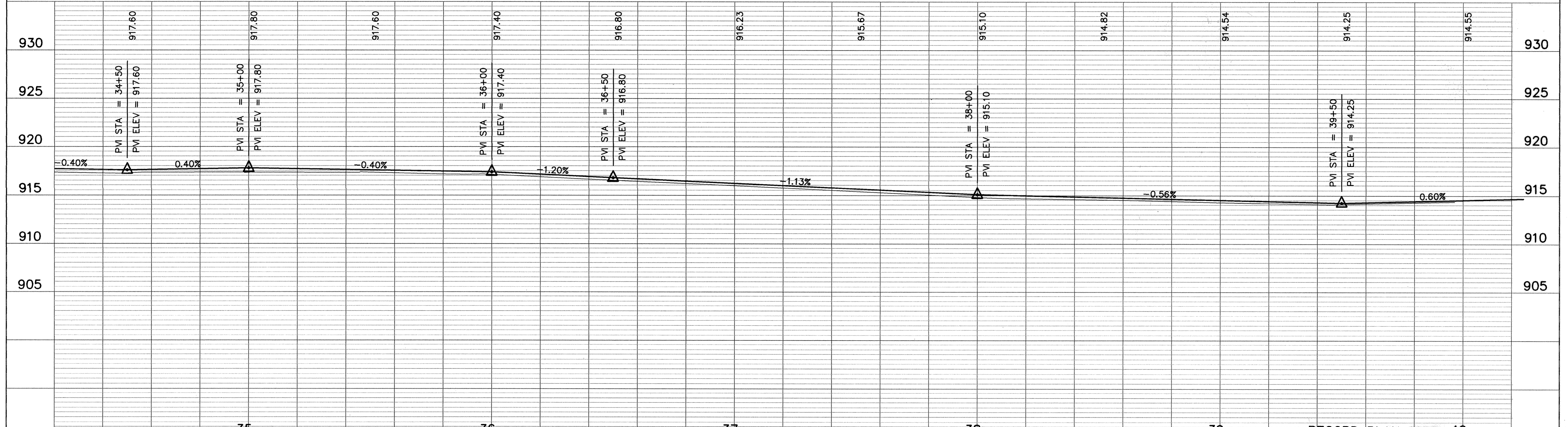

I HEREBY CERTIFY THAT THIS PLAN, SPECIFICATION, OR REPORT WAS PREPARED BY ME OR UNDER MY DIRECT SUPERVISION AND THAT I AM A DULY REGISTERED PROFESSIONAL ENGINEER UNDER THE LAWS OF THE STATE OF MINNESOTA.
Paul B. [Signature]
 DATE 6-2-94 REG. NO. 139129

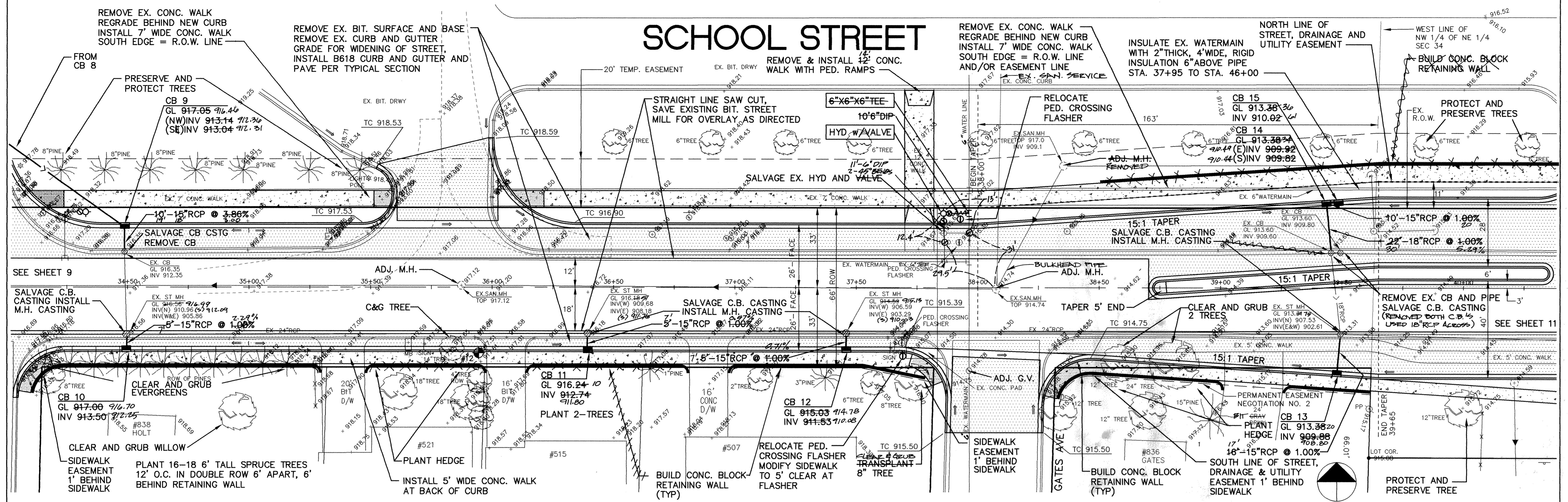

1326 ENERGY PARK DRIVE
 ST. PAUL, MINNESOTA 55108
 (612) 644-4389
 9800 SHELARD PARKWAY
 MINNEAPOLIS, MINNESOTA 55441
 (612) 546-0432

DATE	DESCRIPTION	DESIGNED	PEB
6-2-94	ADD HEDGE @ #521		
		CHECKED	
		DRAWN	
		GRAPHIC SCALE	
		0 HORIZ. 20	
		0 VERT. 5	

RECORD PLAN 1995 40
 CITY OF ELK RIVER
 STREET RECONSTRUCTION
 SCHOOL STREET
 204-107-04 34+50 TO 40+00
 DATE APRIL 1994 SHEET 10 OF 74 SHEETS PROJECT NO. 230-216