

SACO PRODUCTS • NEW HOPE, MINNESOTA  
REORDER BY PART NUMBER 6552  
SACO PRODUCTS • NEW HOPE, MINNESOTA  
REORDER BY PART NUMBER 6552  
SACO PRODUCTS • NEW HOPE, MINNESOTA  
REORDER BY PART NUMBER 6552  
SACO PRODUCTS • NEW HOPE, MINNESOTA  
REORDER BY PART NUMBER 6552

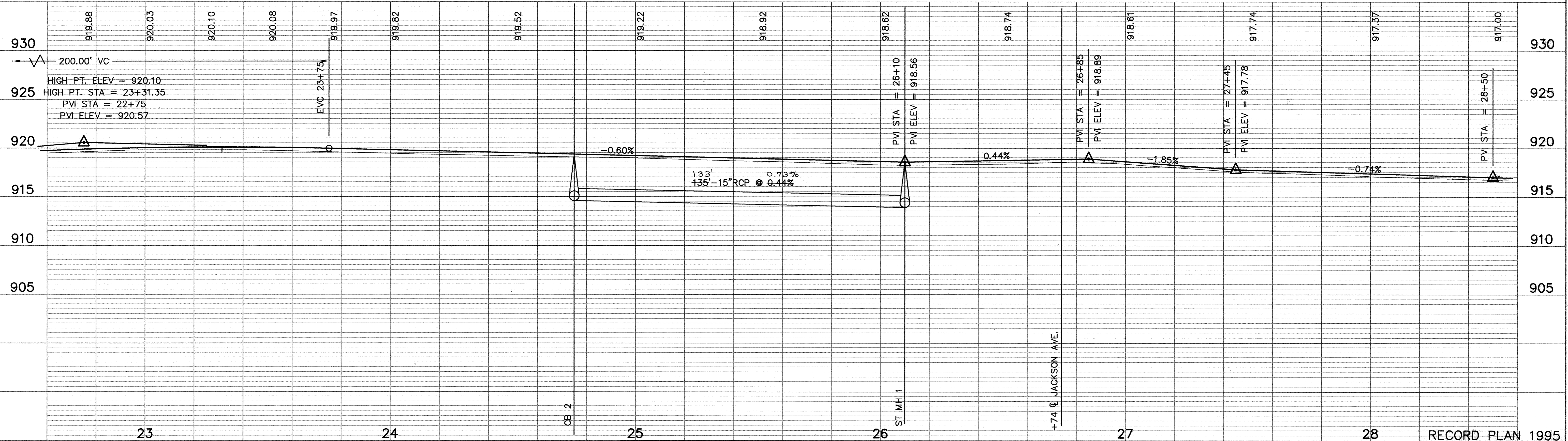
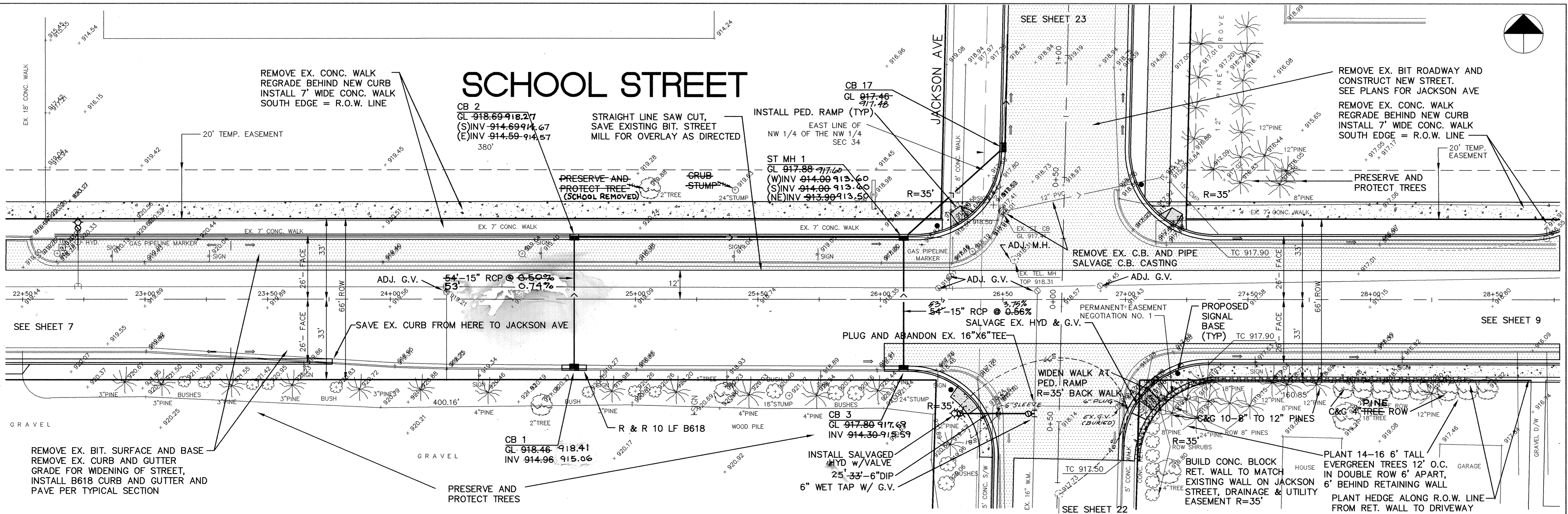

ER216-2	<p>I HEREBY CERTIFY THAT THIS PLAN, SPECIFICATION, OR REPORT WAS PREPARED BY ME OR UNDER MY DIRECT SUPERVISION AND THAT I AM A DULY REGISTERED PROFESSIONAL ENGINEER UNDER THE LAWS OF THE STATE OF MINNESOTA.</p> <p><i>Paul Boettler</i> DATE 6-2-94 REG. NO. 1929</p>	<p><b>MSA</b> CONSULTING ENGINEERS</p> <p>1326 ENERGY PARK DRIVE ST. PAUL, MINNESOTA 55108 (612) 644-4389</p> <p>9800 SHELARD PARKWAY MINNEAPOLIS, MINNESOTA 55441 (612) 546-0432</p>	<p>DATE 6-1-94 DESCRIPTION REMOVE DROPOFF LANE</p> <p>DESIGNED PEB CHECKED DRAWN</p> <p>GRAPHIC SCALE 0 HORIZ. 20 0 VERT. 5</p>	<p>CITY OF ELK RIVER STREET RECONSTRUCTION SCHOOL STREET 204-107-04</p> <p>DATE APRIL 1994 SHEET 8 OF 74 SHEETS PROJECT NO. 230-216</p>
---------	--	---	---	---