

SCHOOL STREET

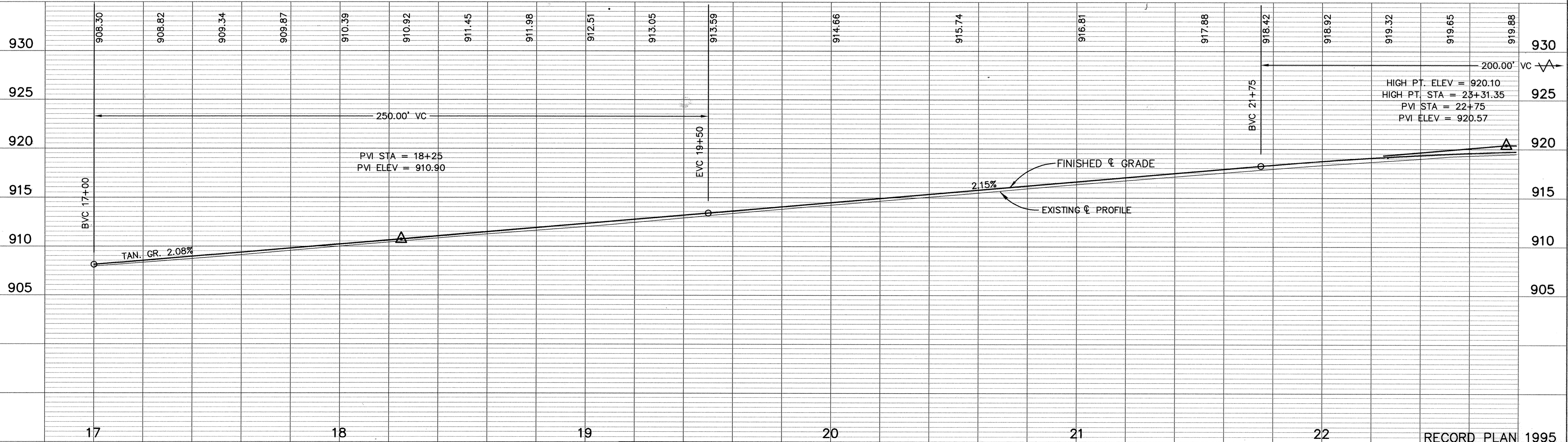
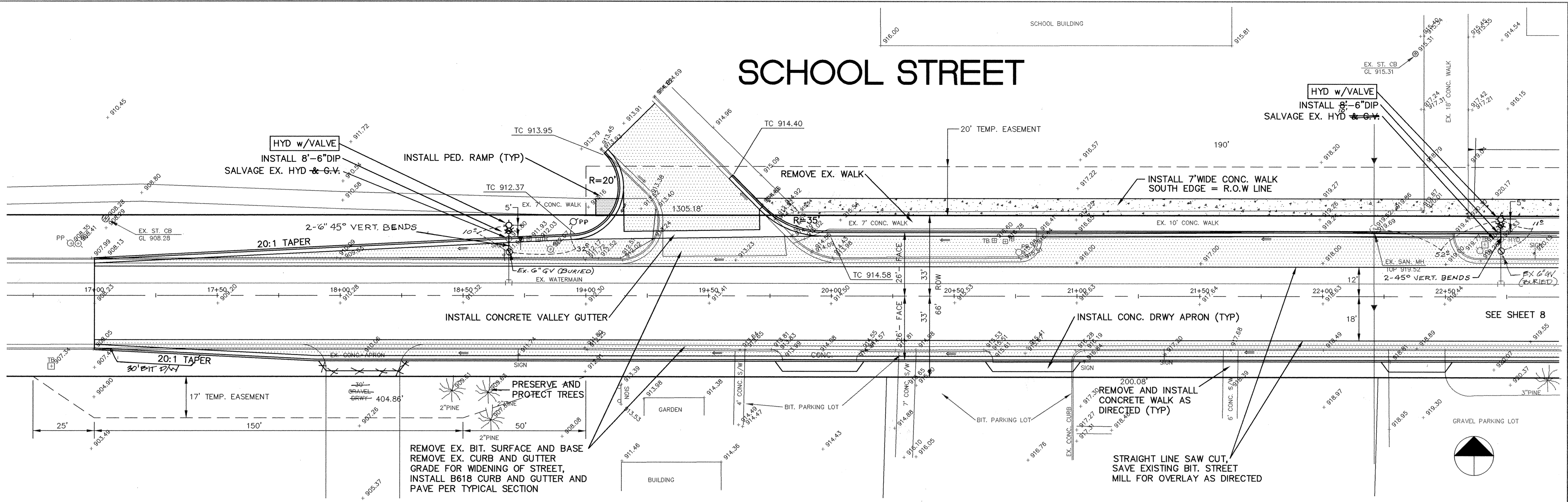

ER216-1	<p>I HEREBY CERTIFY THAT THIS PLAN, SPECIFICATION, OR REPORT WAS PREPARED BY ME OR UNDER MY DIRECT SUPERVISION AND THAT I AM A DULY REGISTERED PROFESSIONAL ENGINEER UNDER THE LAWS OF THE STATE OF MINNESOTA.</p> <p><i>Rand Boettcher</i></p> <p>DATE <u>6-2-94</u> REG. NO. <u>13929</u></p>	<p>MSA CONSULTING ENGINEERS</p> <p>1326 ENERGY PARK DRIVE ST. PAUL, MINNESOTA 55108 (612) 644-4389</p> <p>9800 SHELARD PARKWAY MINNEAPOLIS, MINNESOTA 55441 (612) 546-0432</p>	<p>DATE: 6-1-94</p> <p>DESCRIPTION: REMOVE DROPOFF LANE</p> <p>DESIGNED: PEB</p> <p>CHECKED: []</p> <p>DRAWN: []</p> <p>GRAPHIC SCALE: 0 HORIZ. 20' 0 VERT. 5'</p>	<p>CITY OF ELK RIVER STREET RECONSTRUCTION SCHOOL STREET 204-107-04</p> <p>DATE: APRIL 1994</p>	<p>RECORD PLAN 1995</p> <p>17+00 TO 22+50</p> <p>DATE: APRIL 1994</p> <p>SHEET 7 OF 74 SHEETS</p> <p>PROJECT NO. 230-216</p>
---------	---	---	--	---	--