

- NOTES:
- 1) SEE STREET CONSTRUCTION NOTES ON SHEET 2 FOR REMOVAL OF EXISTING ITEMS.
 - 2) PROPOSED INLET STRUCTURE CASTINGS SHALL CONSIST OF:
 - A. FRAME CASTING NO. 801
 - B. GRATE CASTING NO. 810
 - C. CURB BOX CASTING NO. 823A
 - 3) PROPOSED NON INLET STRUCTURE CASTINGS SHALL CONSIST OF:
 - A. RING CASTING NO. 700-7
 - B. COVER CASTING NO. 711
 - 4) ALL STRUCTURES REFERED TO AS CATCHBASINS SHALL BE 27" DIA.
 - 5) WHERE EXISTING WATERMAIN IS IN CONFLICT WITH PROPOSED STORM SEWER - WATERMAIN SHALL BE LOWERED AS DIRECTED BY ENGINEER IN FIELD.
 - 6) CONTRACTOR TO EXPOSE EXISTING SANITARY SEWER & WATERMAIN AT PROPOSED CROSSINGS WITH STORM SEWER TO DETERMINE ACTUAL ELEVATION PRIOR TO CONSTRUCTION.
 - * 7) ALL STORM SEWER STRUCTURES REFERED TO AS MANHOLES SHALL BE 48" DIAMETER UNLESS NOTED OTHERWISE.

TYPICAL DITCH SECTION

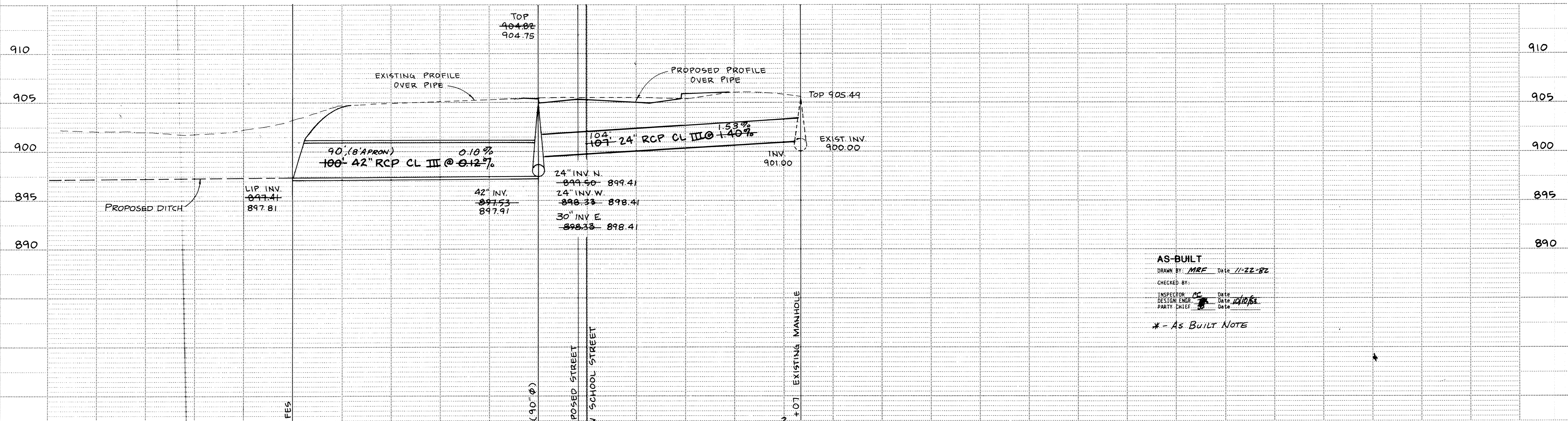

AS-BUILT
 DRAWN BY: MRF Date: 11-22-82
 CHECKED BY:
 INSPECTOR: JS Date: 10/18/83
 DESIGN ENGR: JS Date: 10/18/83
 PARTY CHIEF: JS Date: 10/18/83
 * - AS-BUILT NOTE

I hereby certify that this plan, specification or report was prepared by me or under my direct supervision and that I am a duly Registered Professional Engineer under State of Minn. Statutes sections, 326.02 to 326.16.
 Signature: [Signature]
 Date: 8/28/81 Minn. Reg. No. 15206

consulting engineers diversified inc.
 Civil municipal planning environmental land surveying geotechnics
 p o box 1 osseo minnesota 55369 • (612) 425-2181

DESIGNED BY	TJM
CHECKED BY	JRR
DRAWN BY	TAK
DATE	Aug 81

CITY OF ELK RIVER
 SCHOOL STREET IMPROVEMENT PROJECT
 STORM SEWER
 OUTLET TO DITCH & STORM SEWER NOTES
 BK LOOSE PG LEAF DATE AUG 81 SHEET 12 OF 26 SHEETS FILE NO. ER3:02-5