

# 191ST LANE

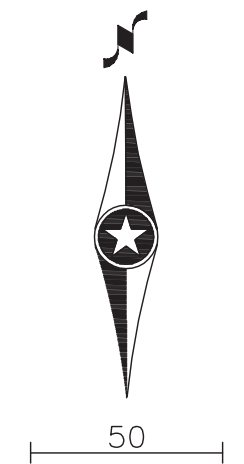

## RECORD PLANS

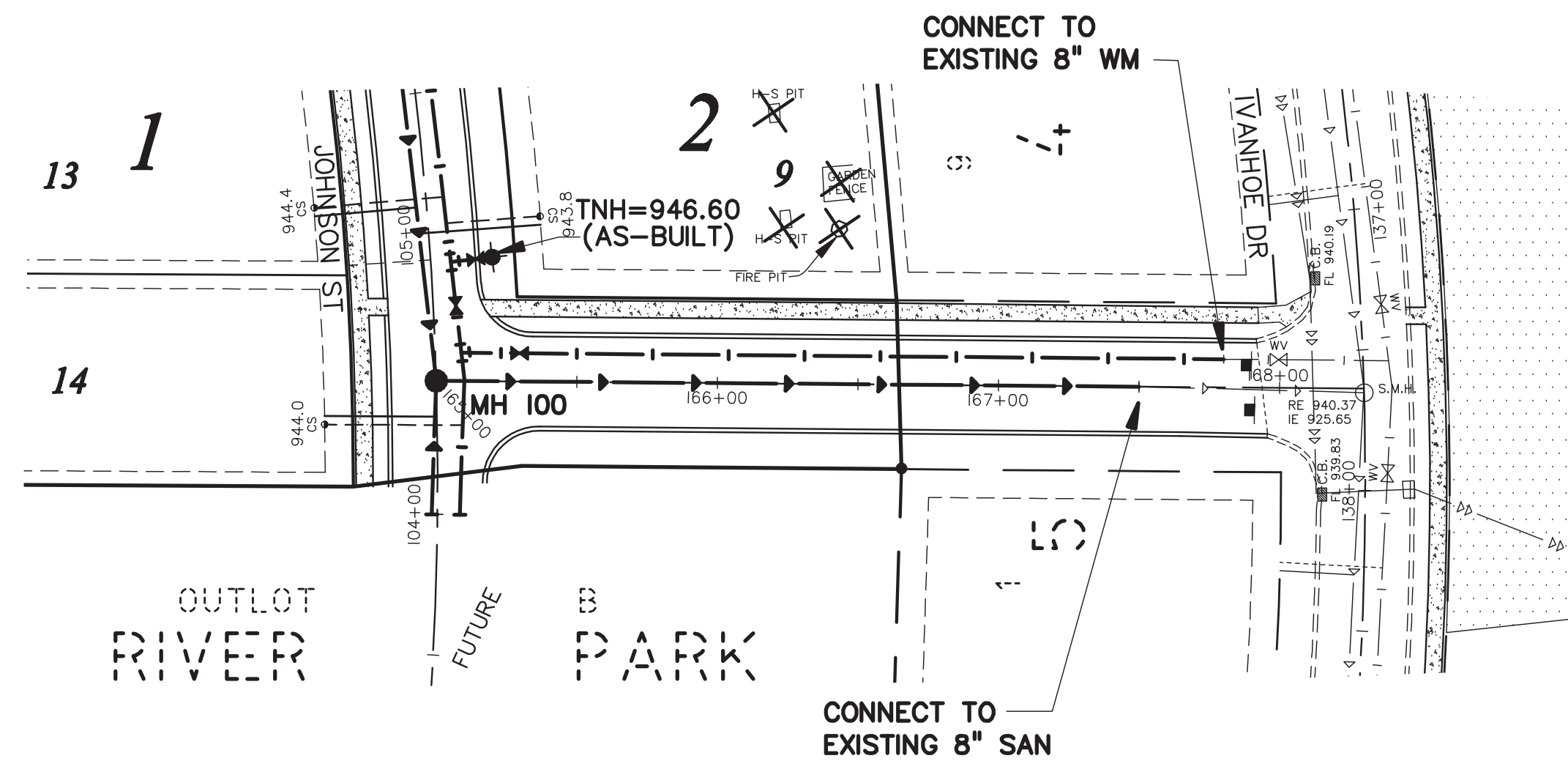
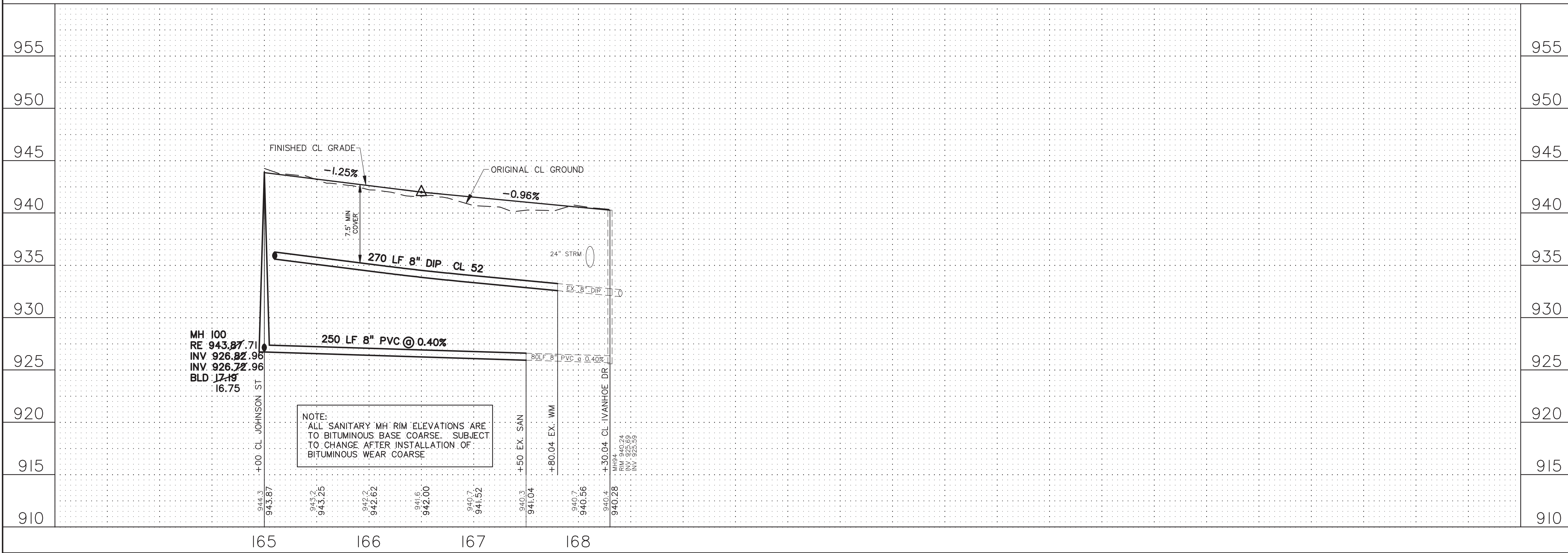

REV NO.	DATE	DESCRIPTION
10/12/2016		
DESIGN BY: DM		
DRAWN BY: DM		
CHECKED BY: RDA		
DWG: -30-ASB-SANWAT		
TEXT:		
FILE NO: 9070.30-03		

I hereby certify that this plan, specification, or report was prepared by me or under my direct supervision and that I am a duly Licensed Professional Engineer under the laws of the state of Minnesota.

Signature: *Ross D. Abel*  
 Ross D. Abel, PE  
 Date: 10/12/2016 L.C. No. 16733

**Oliver Surveying & Engineering, Inc.**  
 Land Surveying • Civil Engineering • Land Planning  
 580 Dodge Ave. Elk River, Minnesota 55330  
 (763) 441-2072 - fac. (763) 441-5665  
 www.oliver-se.com

**RIVER PARK THIRD ADDITION**  
 ELK RIVER, MN  
 FOR **PAXMAR**  
 RECORD PLANS: SANITARY SEWER  
 & WATERMAIN CONSTRUCTION PLAN  
 191ST LANE

SHEET NO. **3** OF **12**