

QUALITY LABEL UTILITY PLAN ELK RIVER, MINNESOTA

RECORD PLAN

Company: Amcon Construction
 Scope: General Contractor
 Contact: Donovan Smith
 Address: 1715 Yankee Doodle Dr.
 Suite 200
 Eagan, MN 55121
 Phone: 651-379-9090
 Fax: 651-379-9091

Company: Nova Frost, Inc.
 Scope: Site Utilities Contractor
 Contact: Steve Frost
 Address: 2347 Commerce Drive
 PO Box 516
 Hastings, MN 55033
 Phone: 651-480-8575
 Fax: 651-480-8527

NO.	DESCRIPTION	CASTING
CBMH A	48" DIA. W/ SLAB TOP	NEENAH R-1733
CB 1	48" DIA. W/ SLAB TOP	NEENAH R-2557
CB 2	48" DIA. W/ SLAB TOP	NEENAH R-2557
CB 3	48" DIA. W/ SLAB TOP	NEENAH R-3067V
CB 4	2'X3' RECT.	NEENAH R-3067V
CB 5	48" DIA. W/ SLAB TOP	NEENAH R-3067V

LEGEND:

- Existing Watermain
- - - Existing Sanitary Sewer
- - - Existing Storm Sewer
- - - Proposed Watermain
- - - Proposed Sanitary Sewer
- - - Proposed Storm Sewer
- ⊙ Existing Hydrant
- ⊙ Proposed Hydrant
- ⊙ Existing Sanitary Manhole
- ⊙ Proposed Sanitary Manhole
- ⊙ Proposed Catch Basin/Manhole

GENERAL NOTES:

- THE INFORMATION SHOWN ON THESE DRAWINGS CONCERNING TYPE AND LOCATION OF EXISTING UTILITIES IS NOT GUARANTEED TO BE ACCURATE OR ALL INCLUSIVE. THE CONTRACTOR IS RESPONSIBLE FOR MAKING HIS OWN DETERMINATION AS TO THE TYPE AND LOCATION OF UTILITIES AS MAY BE NECESSARY TO AVOID DAMAGE TO THESE UTILITIES.
- CONTACT COPPER STATE ONE-CALL AT 888-454-0002 FOR EXISTING UTILITY LOCATIONS.
- THE CONTRACTOR SHALL FIELD VERIFY SIZE, LOCATION, AND ELEVATION OF EXISTING SANITARY SEWER, WATER MAIN, AND STORM SEWER AND NOTIFY ENGINEER OF ANY DISCREPANCIES PRIOR TO THE START OF INSTALLATIONS.
- INSTALLATIONS SHALL CONFORM TO THE CITY ENGINEERS ASSOCIATION OF MINNESOTA (CEAM) STANDARD UTILITY SPECIFICATIONS (1999 EDITION) AND THE CITY OF ELK RIVER STANDARD SPECIFICATIONS.
- CONTRACTOR SHALL NOTIFY CITY OF ELK RIVER PUBLIC WORKS DEPARTMENT AT (763) 835-1032 A MINIMUM OF 24 HOURS PRIOR TO ANY INTERRUPTION OF SANITARY SEWER OR WATER SERVICE TO EXISTING HOMES OR BUSINESSES.
- CONTACT JOHN ANDERSON, CITY OF ELK RIVER ENGINEERING DEPARTMENT AT 763-835-1032 FOR INSPECTION OF ALL UTILITY WORK.
- SEE SHEET C4 FOR ADDITIONAL DETAILS.

STREET AND ADJACENT NOTES:

- SAW-CUT EXISTING BITUMINOUS AND CONCRETE CURBS TO PROVIDE BUTT-JOINT.
- REMOVAL AND DISPOSAL OF EXISTING STREET MATERIALS AS REQUIRED FOR CONSTRUCTION IS INCIDENTAL.
- RESTORE DISTURBED STREET TO EXISTING OR BETTER SECTION AS APPROVED BY ENGINEER.
- CONTRACTOR SHALL USE TRAFFIC CONTROL MEASURES (IN ACCORDANCE WITH THE MINNESOTA MANUAL OF UNIFORM TRAFFIC CONTROL DEVICES) AS NECESSARY WHENEVER GRAVEL, UTILITY, OR PAVING OPERATIONS ENCOACH ON ADJACENT STREET.

CURB NOTES:

- BACK-FILLING OF CURBS WITH ON-SITE MATERIALS IS INCIDENTAL TO CURB CONSTRUCTION.
- CURBS AND CUTTER SHOWN SHALL BE B912 UNLESS OTHERWISE NOTED ON PLANS.

STORM SEWER NOTES:

- STORM SEWER SHALL BE RCP (CLASS II MINIMUM) OR HDPE UNLESS OTHERWISE NOTED ON PLANS.

WATER MAIN NOTES:

- MAINTAIN MINIMUM OF 7.5 FEET OF COVER OVER WATER SERVICE.
- FIRE SERVICE TO BUILDING SHALL BE 8" DIP CLASS 52, COMBINED FIRE AND DOMESTIC SERVICE LINE.
- FIELD VERIFY SIZE AND LOCATION OF EXISTING WATERMAIN AND NOTIFY ENGINEER OF ANY DISCREPANCIES PRIOR TO THE START OF CONSTRUCTION.

SANITARY SEWER NOTES:

- EXISTING SANITARY SEWER LOCATIONS SHALL BE VERIFIED IN FIELD PRIOR TO CONSTRUCTION.
- SANITARY SEWER SERVICE TO BUILDING SHALL BE 8" PVC SCHEDULE 40 UNLESS OTHERWISE NOTED.
- FIELD VERIFY LOCATION, SIZE, AND INVERT ELEVATION OF EXISTING SANITARY SEWER AND NOTIFY ENGINEER OF ANY DISCREPANCIES PRIOR TO THE START OF CONSTRUCTION.

All structures and piping were installed according to plan. All elevations match plan.

Signature: *Steve Frost*
 Steve Frost
 Date: August 17, 2006

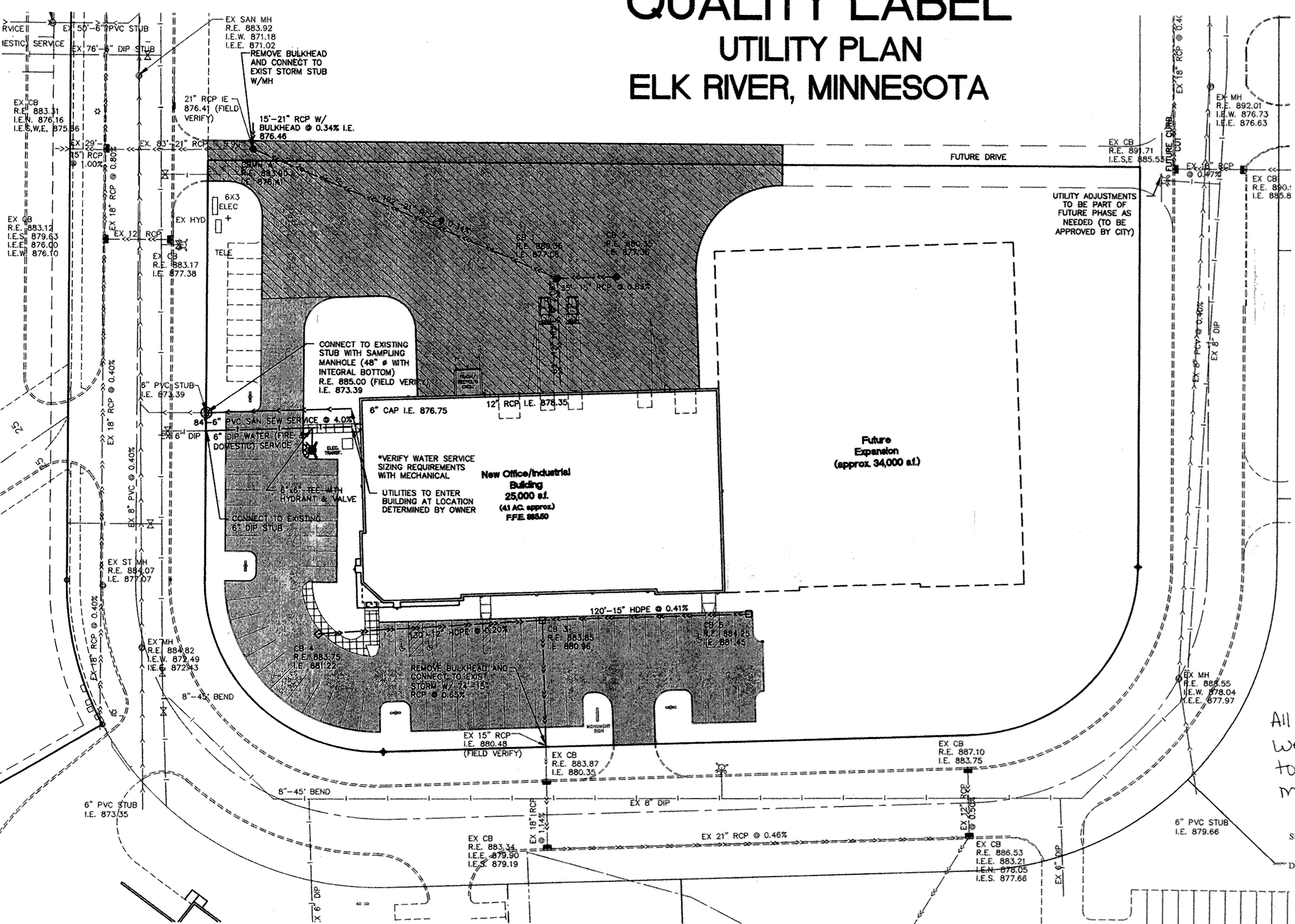

DESIGNED	REVISIONS
C.G.S.	2/10/06 CITY COMMENT LETTER (1/08/06)
DRAWN	
C.A.U.	
CHECKED	
A.G.	

I hereby certify that this plan was prepared by me or under my direct supervision and that I am a duly registered professional engineer under the laws of the State of Minnesota.
Craig G. Schlichting
 CRAIG G. SCHLICHTING
 DATE: 2/10/06 REG. NO. 41296

SITE PLANNING ENGINEERING
PLOWE ENGINEERING, INC.
 9180 LEXINGTON AVENUE N.E.
 CIRCLE PINES, MN 55014 (763) 785-1043

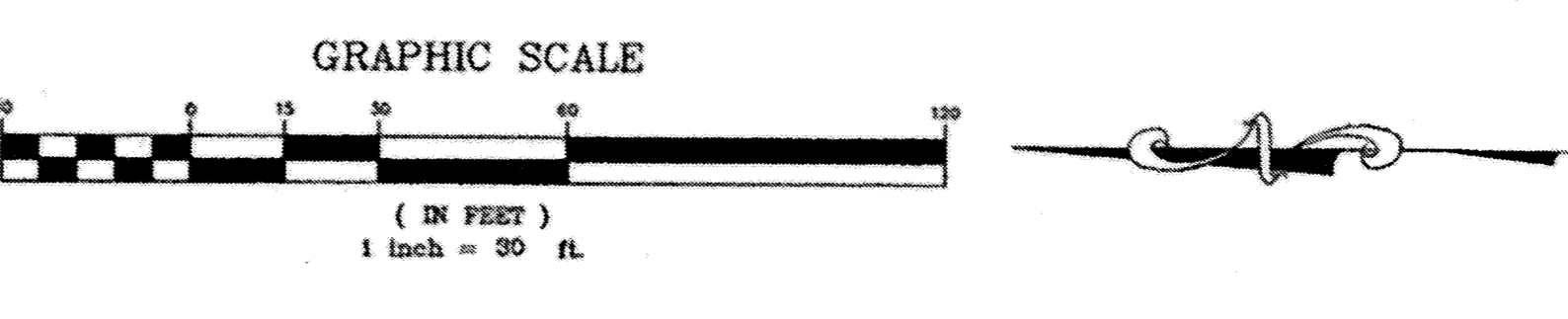

PREPARED FOR:

 Design Construction
 Construction Management
 1715 YANKEE DOODLE ROAD,
 SUITE 200
 Eagan, Minnesota 55121
 Phone 651-379-9090
 Fax 651-379-9091

DATE: 12/09/05
 SHEET
C2

DRAWING NUMBER QUALITY LABEL.05