

LEGEND

- 882 Existing Contours
- 882 Proposed Contours
- - - Silt Fence
- Possible House Pad
- Proposed Storm Sewer
- Drainage Direction
- Haybale Checks

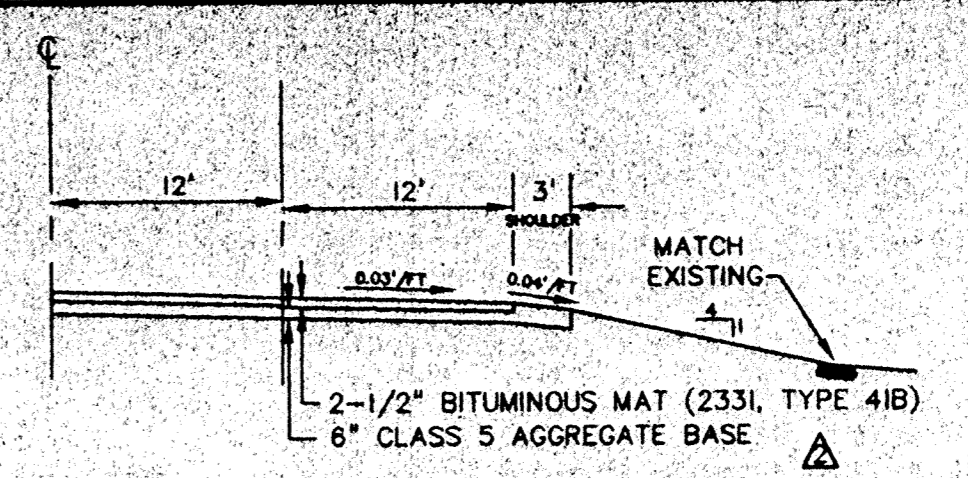

RIGHT TURN LANE SECTION

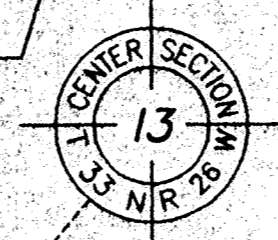
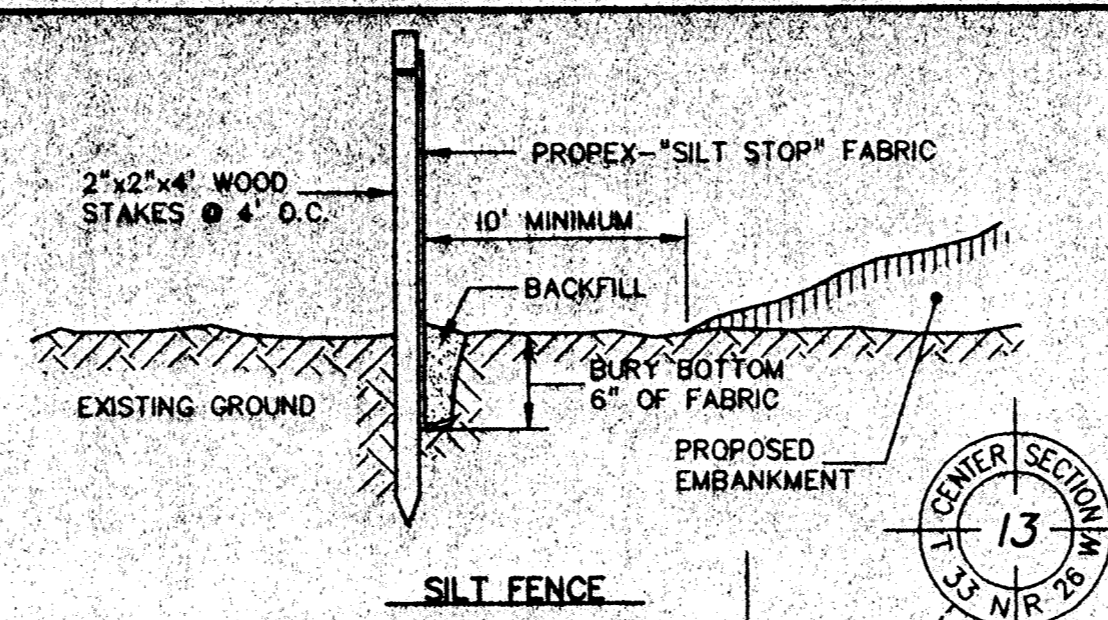
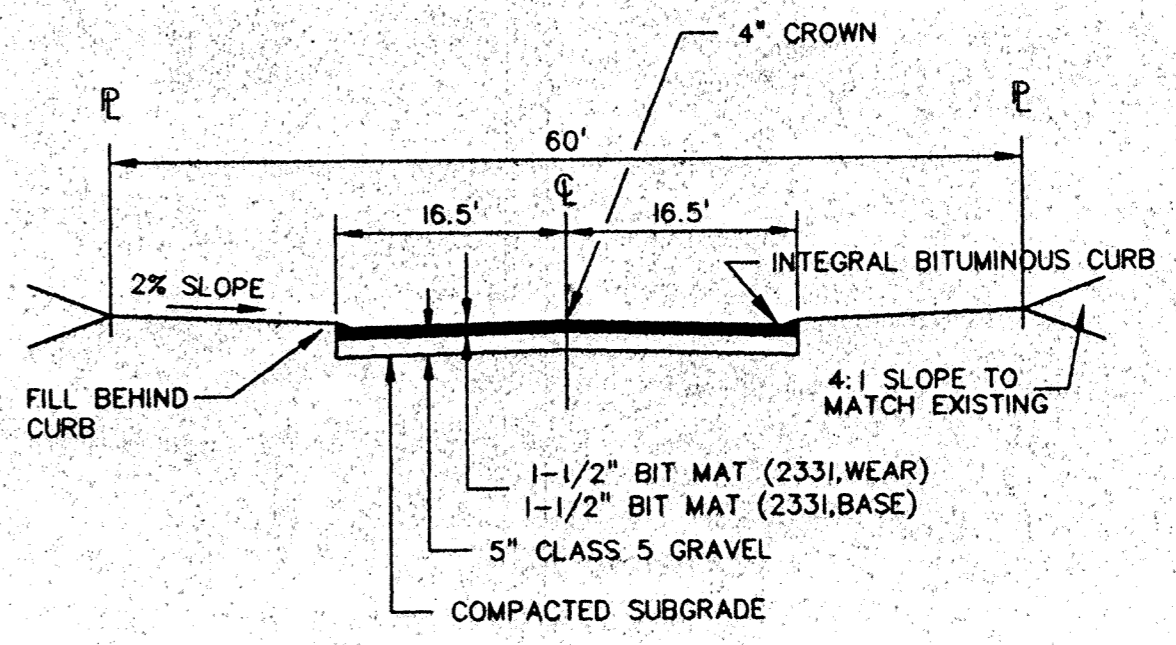

TYPICAL STREET SECTION

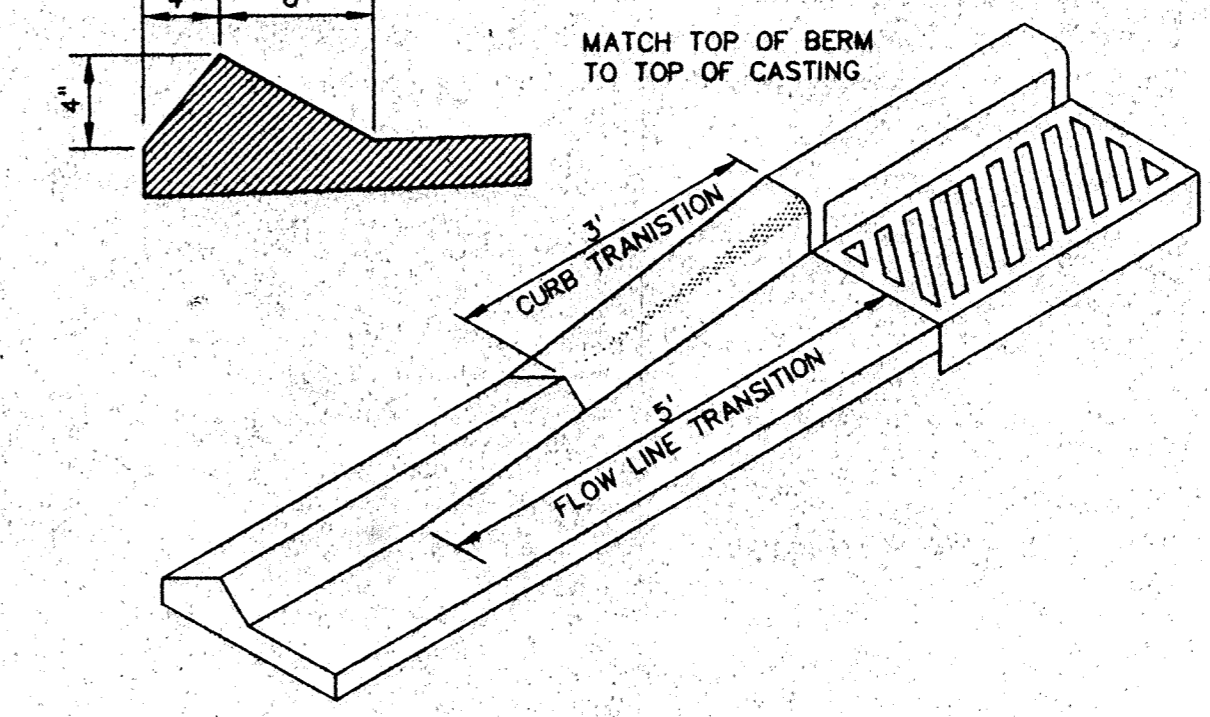
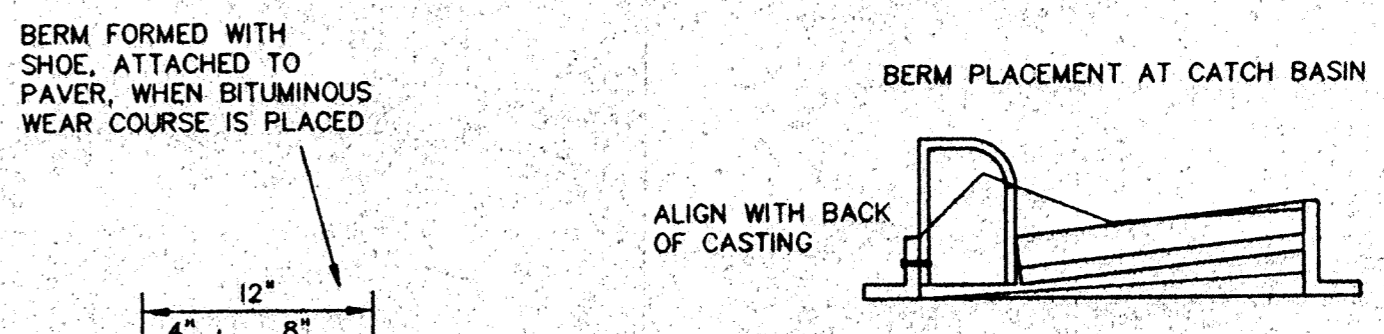

INTEGRAL BITUMINOUS BERM

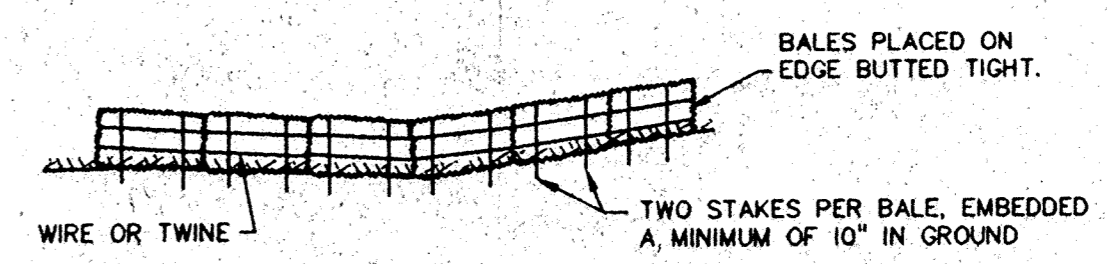

PROPERLY INSTALLED STRAW BALE BARRIER

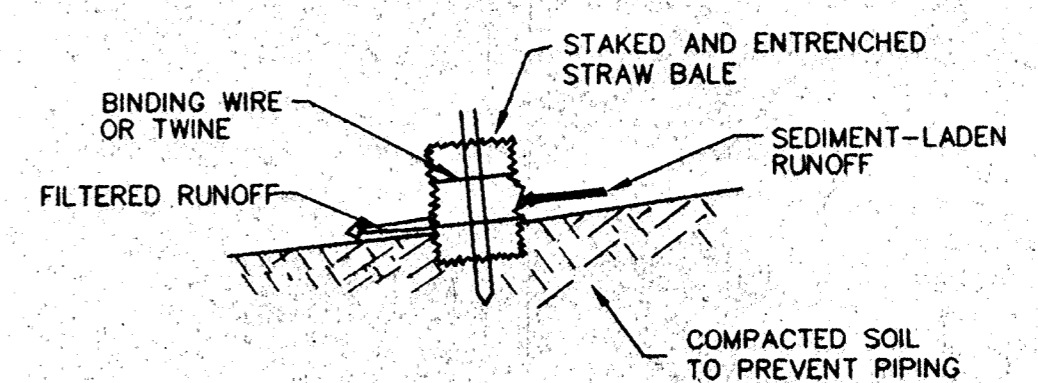

NOTES:

1. THE BALES SHALL BE TRENCHED 4" INTO THE GROUND AND SHALL BE STAKED BY STEEL FENCE POSTS OR 2" X 2" WOOD STAKES. THE STAKES SHOULD BE ANGLED TOWARDS THE PREVIOUSLY LAID BALE.
2. SOIL SHALL BE COMPACTED ON THE UPSLOPE SIDE OF BALES. LOOSE STRAW SHALL BE WEDGED BETWEEN THE BALES.

APPROVED

John Oliver
MSA Consulting Engineer

EROSION CONTROL STRAW BALE CHECK DAM

REV. NO.	DATE	DESCRIPTION
1	7/8/96	NETLAND DELINEATION AREA
2	7/17/96	BIT MAT ON TURNING LANE DETAIL
3	8/17/96	REMOVE DELIN. DRAINAGE SWALE

I hereby certify that this plan was prepared by me or under my direct supervision and that I am duly registered and licensed under the laws of the State of Minnesota.

Signed: *John Oliver*
Date: 6/28/96 Reg. No. 12699

John Oliver & Associates, Inc.
Civil Engineering, Land Surveying, Land Planning
580 Dodge Avenue
Elk River, Minnesota 55330
(612)441-2072 (FAX)441-6666

W.J.C. DEVELOPMENT CORP.
Final Grading, Drainage,
& Erosion Control Plan