

Record Plans
 10-09-15
 Utility Contractor: Hennen Construction
 Grading Contractor: Omann Brothers Paving, Inc.
 *Note: Rim and invert elevations provided by Otto Associates. All other record plan information provided by the City of Elk River.

NOTES:
 1. PAVEMENT RESTORATION SHALL BE PAID AT THE SAME UNIT PRICES AS NEW PAVEMENT.

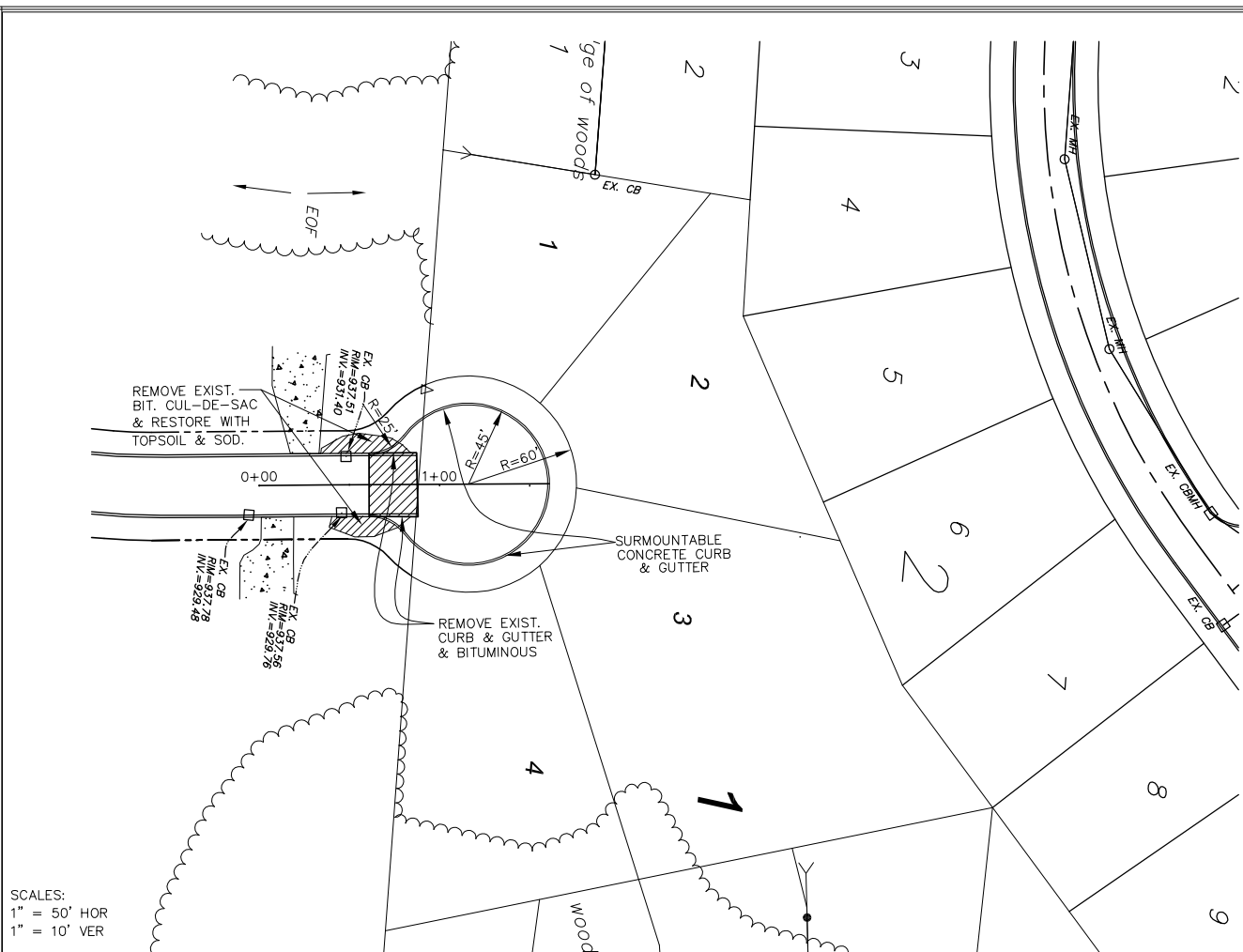

SCALES:
 1" = 50' HOR
 1" = 10' VER

ALBANY CIRCLE

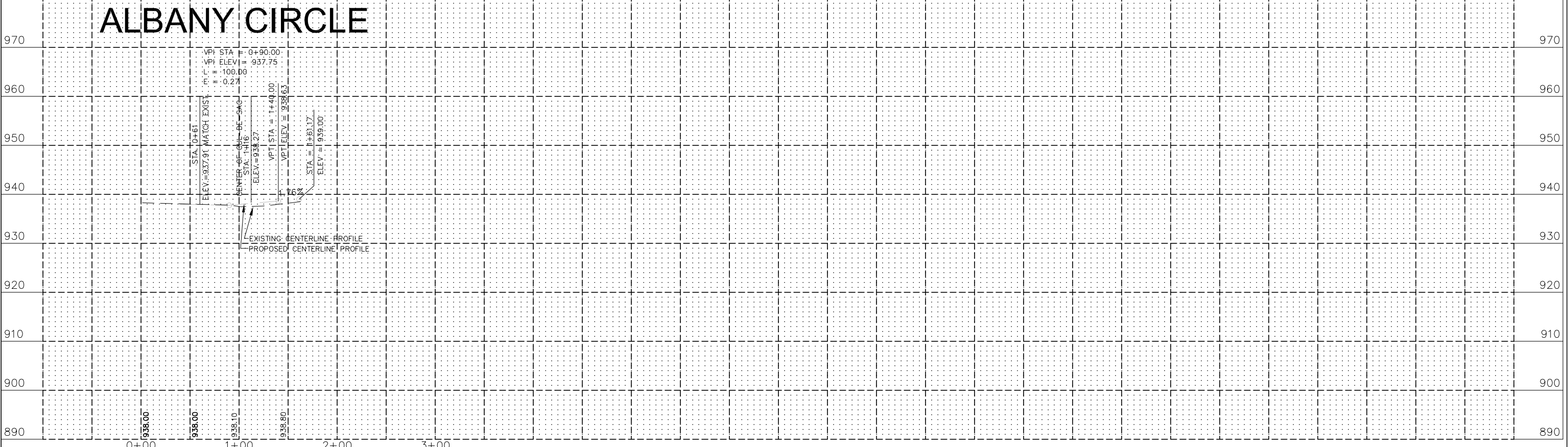

REV. NO.	DATE	BY	DESCRIPTION

DESIGNED C.S.O.	DRAWN M.L.H.
CHECKED C.S.O.	

12-1-15

PRESTIGIOUS WOODLAND HILLS SECOND ADDITION
 BENZINGER PROPERTIES
 ELK RIVER, MN

PROJECT NO: 13-0210
DATE: 12/1/15
STREET & STORM SEWER PLAN ALBANY CIRCLE
SHEET NO. 6 OF 11 SHEETS