

- REFERENCE NOTES:
- ① ALL PERFORATED CP PIPE SHALL BE CONSTRUCTED WITH AN INFILTRATION TRENCH PER $\frac{1}{8}$.
 - ② CONSTRUCT MANHOLE PER $\frac{4}{7}$.
 - ③ TYING PIPE JOINTS SHALL BE INCIDENTAL.

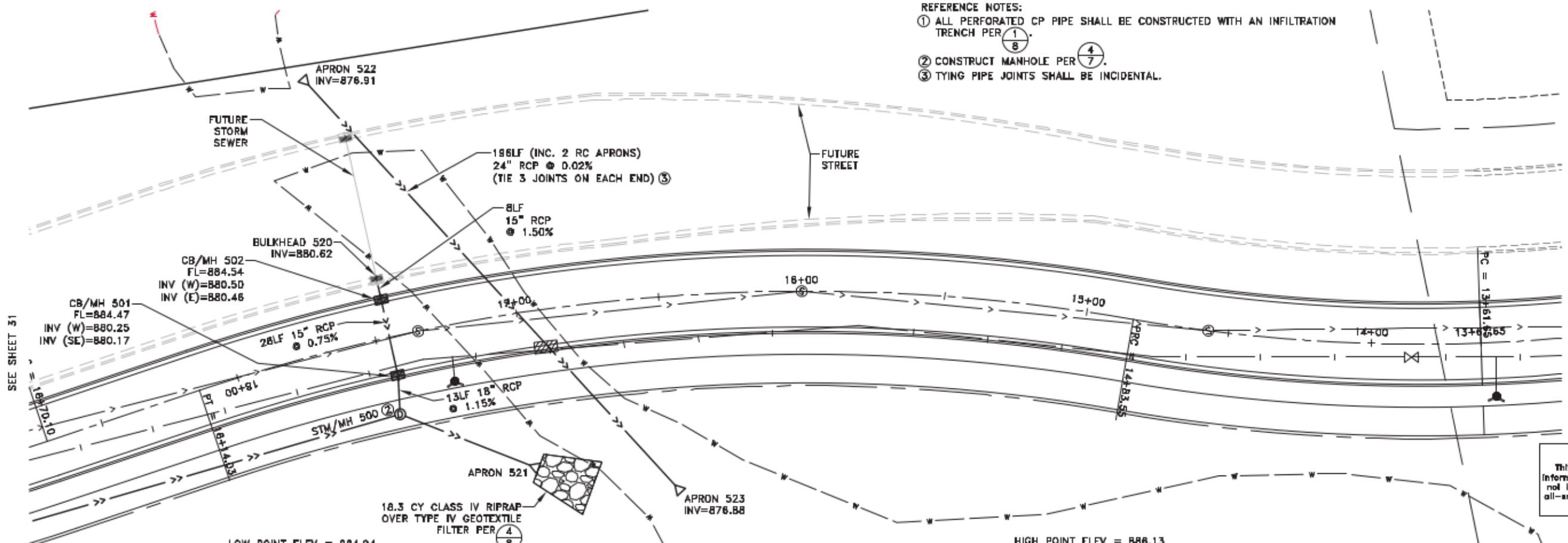

LOW POINT ELEV = 884.94
 LOW POINT STA = 17+45.10
 PVI STA = 17+75
 PVI ELEV = 884.67
 A.D. = 2.39
 K = 50.17

HIGH POINT ELEV = 886.13
 HIGH POINT STA = 15+02.42
 PVI STA = 15+00
 PVI ELEV = 886.32
 A.D. = -1.25
 K = 95.98

RECORD PLAN
 This drawing is furnished for informational purposes only and is not intended to be complete and all-encompassing in displaying all prevailing conditions.

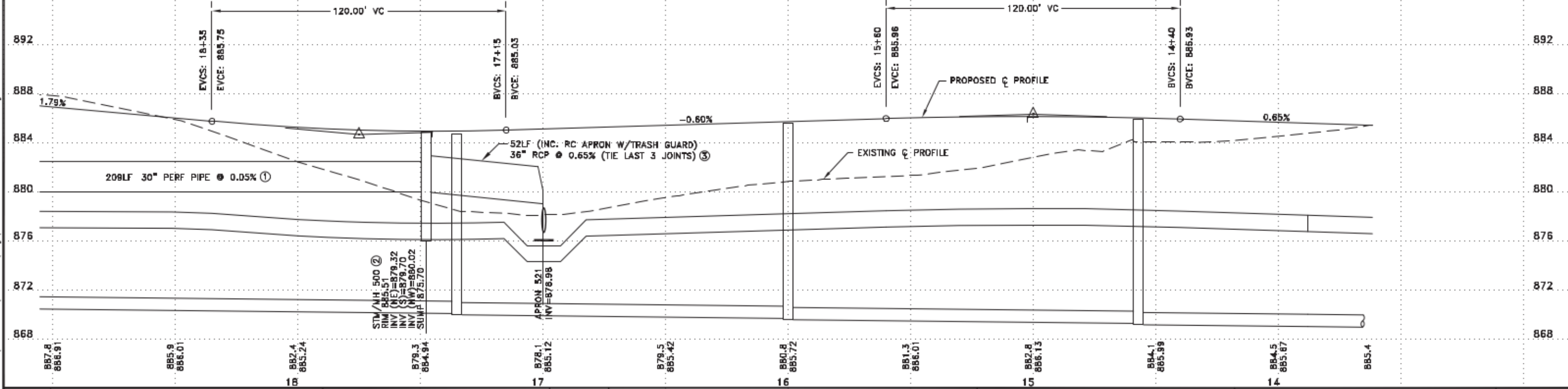
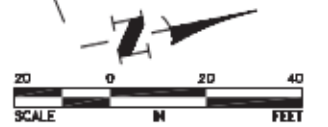

Mar 23, 2016 - 10:08am
 K:\cad\eng\PROJECTS\MUNICIPAL\ER302\AB\dwg\ER302 STREET AND STORM.dwg

DATE	REVISION
8/23/14	REVISED CULVERT
3/21/16	RECORD PLAN

I hereby certify that this plan, specification, or report was prepared by me or under my direct supervision and that I am a duly Licensed Professional Engineer under the laws of the State of Minnesota.

Chang J. Johnson, P.E.
 Date 8/15/14 Lic. No. 23461

DESIGNED BY: TAE
 CHECKED BY: DMS
 DRAWN BY: CJJ



Hakanson Anderson
 Civil Engineers and Land Surveyors
 3501 Thurston Ave., Anoka, Minnesota 55303
 763-427-5880 FAX 763-427-0520
 www.hakanson-anderson.com

**NATURES EDGE BUSINESS CENTER
 PHASE 2 IMPROVEMENTS**

STREET AND STORM SEWER PLAN
 TWIN LAKES ROAD
 CITY OF ELK RIVER, MINNESOTA

SHEET 30 OF 43 SHEETS