

- NOTES:
- 1) ALL INTERSECTIONS ARE TO HAVE 15' RADII, UNLESS STATED ON THE PLANS.
 - 2) CONTRACTOR TO STRAIGHT LINE CUT EXISTING BITUMINOUS ON ALL STREETS ADJACENT TO VALE ROAD & XENIA AVENUE AND APPLY TACK COAT & WARP TO MATCH EXISTING BITUMINOUS MAT.
 - 3) END BITUMINOUS BERM WITH 2' TAPER SECTION

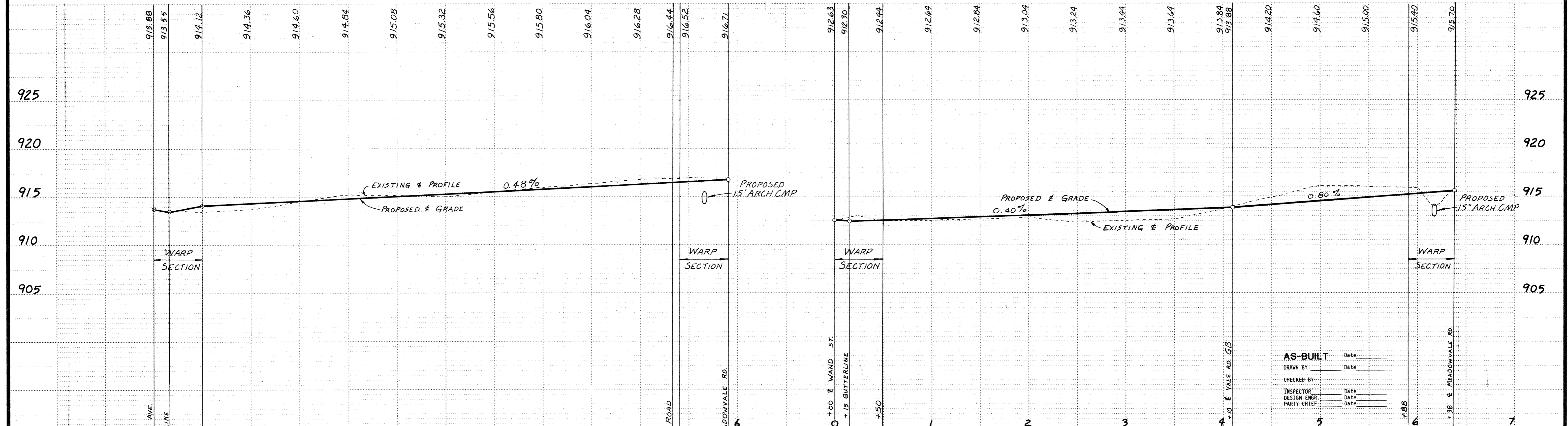

I hereby certify that this plan, specification or report was prepared by me or under my direct supervision and that I am a duly Registered Professional Engineer under State of Minn. Statutes Sections 226.02 to 226.16. Date: July 17, 1988 Minn. Reg. No. 101666	consulting engineers diversified inc.	civil municipal planning environmental land surveying soil exploration	DESIGNED BY: _____ CHECKED BY: _____ DRAWN BY: GB	CITY OF ELK RIVER MEADOWVALE OAKS STREET CONSTRUCTION VALE ROAD & XENIA AVENUE
			REVISIONS: _____ SCALE: HORIZ. 1"=50' VERT. 1"=5' DATE: JULY 79	SHEET 3 OF 3 SHEETS FILE NO. ER6-02-2