

ELGIN DRIVE

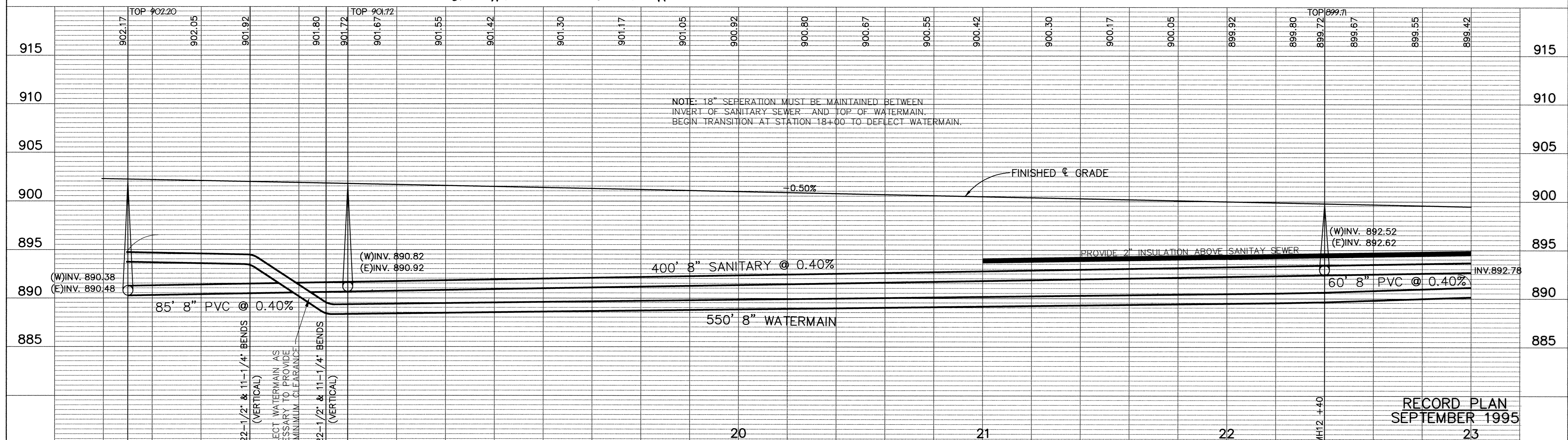
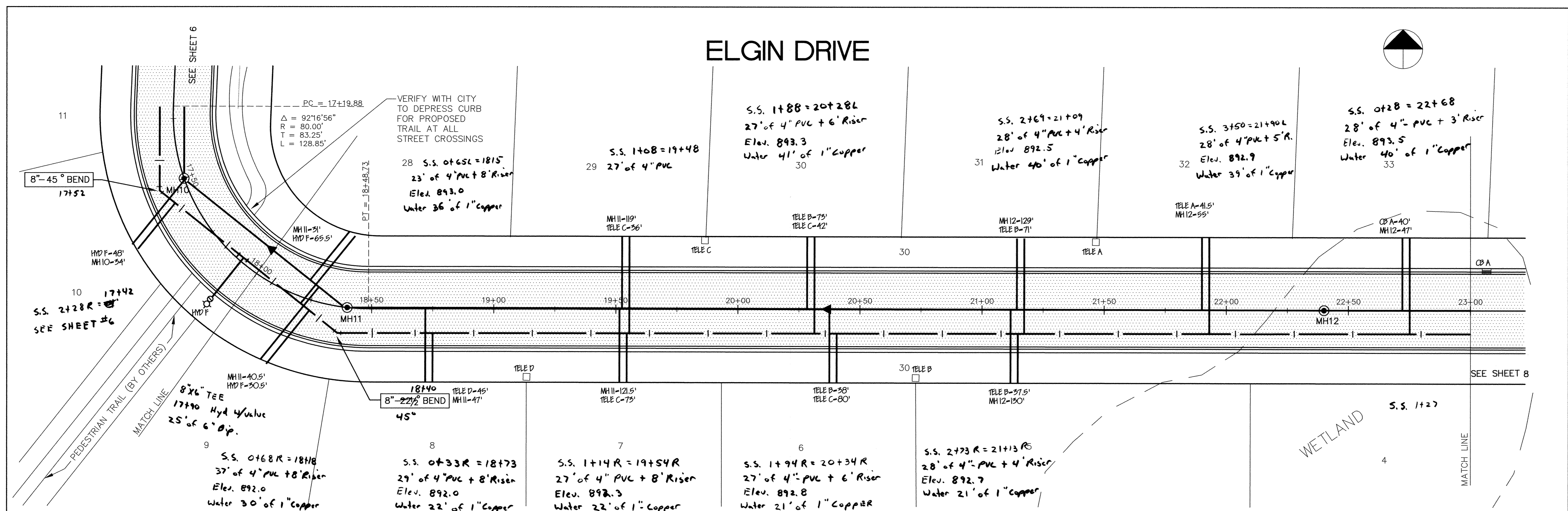
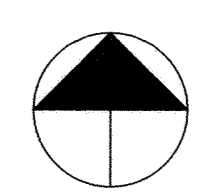

NOTE: 18" SEPERATION MUST BE MAINTAINED BETWEEN INVERT OF SANITARY SEWER AND TOP OF WATERMAIN. BEGIN TRANSITION AT STATION 18+00 TO DEFLECT WATERMAIN.

RECORD PLAN
SEPTEMBER 1995

I HEREBY CERTIFY THAT THIS PLAN, SPECIFICATION, OR REPORT WAS PREPARED BY ME OR UNDER MY DIRECT SUPERVISION AND THAT I AM A DULY REGISTERED PROFESSIONAL ENGINEER UNDER THE LAWS OF THE STATE OF MINNESOTA.
Mark J. Graham
DATE 2/10/95 REG. NO. 19130

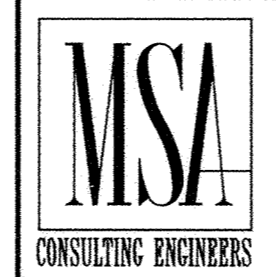

1326 ENERGY PARK DRIVE
ST. PAUL, MINNESOTA 55108
(612) 644-4389

9800 SHELARD PARKWAY
MINNEAPOLIS, MINNESOTA 55441
(612) 546-0432

DATE	2/95	DESCRIPTION	ADDED HYDRANT EXTENSION	DESIGNED	MVG	CHECKED	RB	DRAWN	IC
REVISIONS				GRAPHIC SCALE					
				HORIZ.	20				
				VERT.	5				

CITY OF ELK RIVER STREET AND UTILITY IMPROVEMENTS ELGIN DRIVE					
DATE	FEB, 1994	SHEET	7 OF 13 SHEETS	PROJECT NO.	230-208