

# DENVER COURT

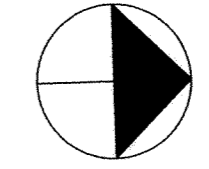

$\Delta = 108^{\circ}05'44"$   
 $R = 80.00000'$   
 $T = 110.30397'$   
 $L = 150.92994'$

MATCH LINE SEE SHEET 4

8" - 45° BEND  
2+10  
S.S. 0+08L = 2+15  
30' of 4" PVC + 5'R  
Elev. 894.0  
WATER  
26' of 1" Copper

MH2-49.5'  
MH1-75'  
3  
S.S. 0+46L = 1+83  
40' of 4" PVC + 5'R  
Elev. 894.5  
Water 37' of 1" Copper

MH2-95.5'  
MH1-28'  
2  
S.S. 1+05L = 1+32  
24' of 4" PVC + 6'R  
Elev. 894.0  
Water 20' of 1" Copper

EX. HYD-76.5'  
MH1-01'  
0+23  
8" X 6" RED.  
6" VALVE  
EX. HYD-99.5'  
MH1-114'  
S.S. 0+29L  
24' of 4" PVC + 6'R  
Elev. 894.0  
Water 20' of 1" Copper

STATION 0+19  
REMOVE EXISTING 8"  
PLUG AND EXTEND  
SANITARY SEWER  
EXISTING INV. 883.09

STRAIGHT LINE CUT, TACK  
AND MATCH EXISTING BITUMINOUS  
MILL EXISTING WEAR COURSE  
A MINIMUM OF 4'

STATION 0+33  
REMOVE EXISTING  
6" PLUG AND  
EXTEND WATERMAIN

193RD AVE

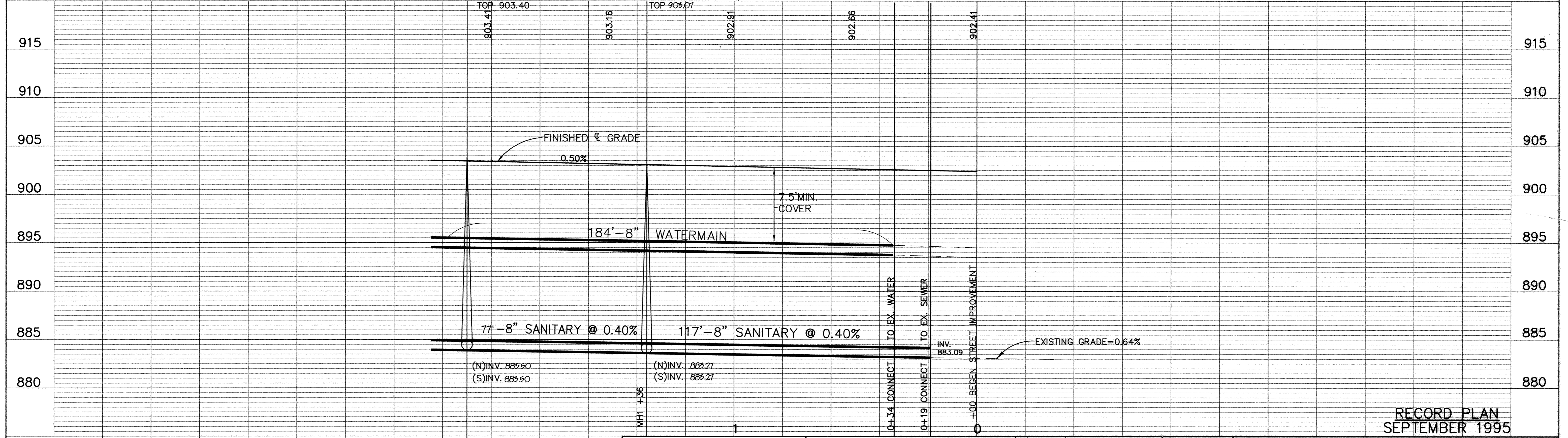

RECORD PLAN  
SEPTEMBER 1995

I HEREBY CERTIFY THAT THIS PLAN, SPECIFICATION,  
OR REPORT WAS PREPARED BY ME OR UNDER MY DIRECT  
SUPERVISION AND THAT I AM A DULY REGISTERED  
PROFESSIONAL ENGINEER UNDER THE LAWS OF THE  
STATE OF MINNESOTA.  
*Nash Graham*  
DATE 2/10/95 REG. NO. 1930

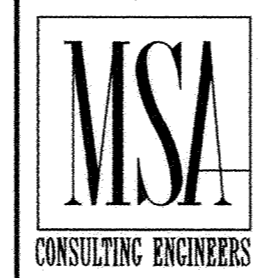

1326 ENERGY PARK DRIVE  
ST. PAUL, MINNESOTA 55108  
(612) 644-4389  
  
9800 SHELARD PARKWAY  
MINNEAPOLIS, MINNESOTA 55441  
(612) 546-0432

DATE	DESCRIPTION	DESIGNED	MVG
2/95	GRADE REVISIONS	CHECKED	RB
	BETWEEN 0+00-2+10	DRAWN	TC

GRAPHIC SCALE	
HORIZ.	20'
VERT.	5'

CITY OF ELK RIVER STREET AND UTILITY IMPROVEMENTS DENVER COURT			
DATE	FEB, 1994	SHEET	3 OF 13 SHEETS
PROJECT NO.	230-208		