

Call 48 Hours before digging:
GOPHER STATE ONE CALL
 Twin City Area 651-454-0002
 Mn. Toll Free 1-800-252-1166

© 2002 Westwood Professional Services, Inc.

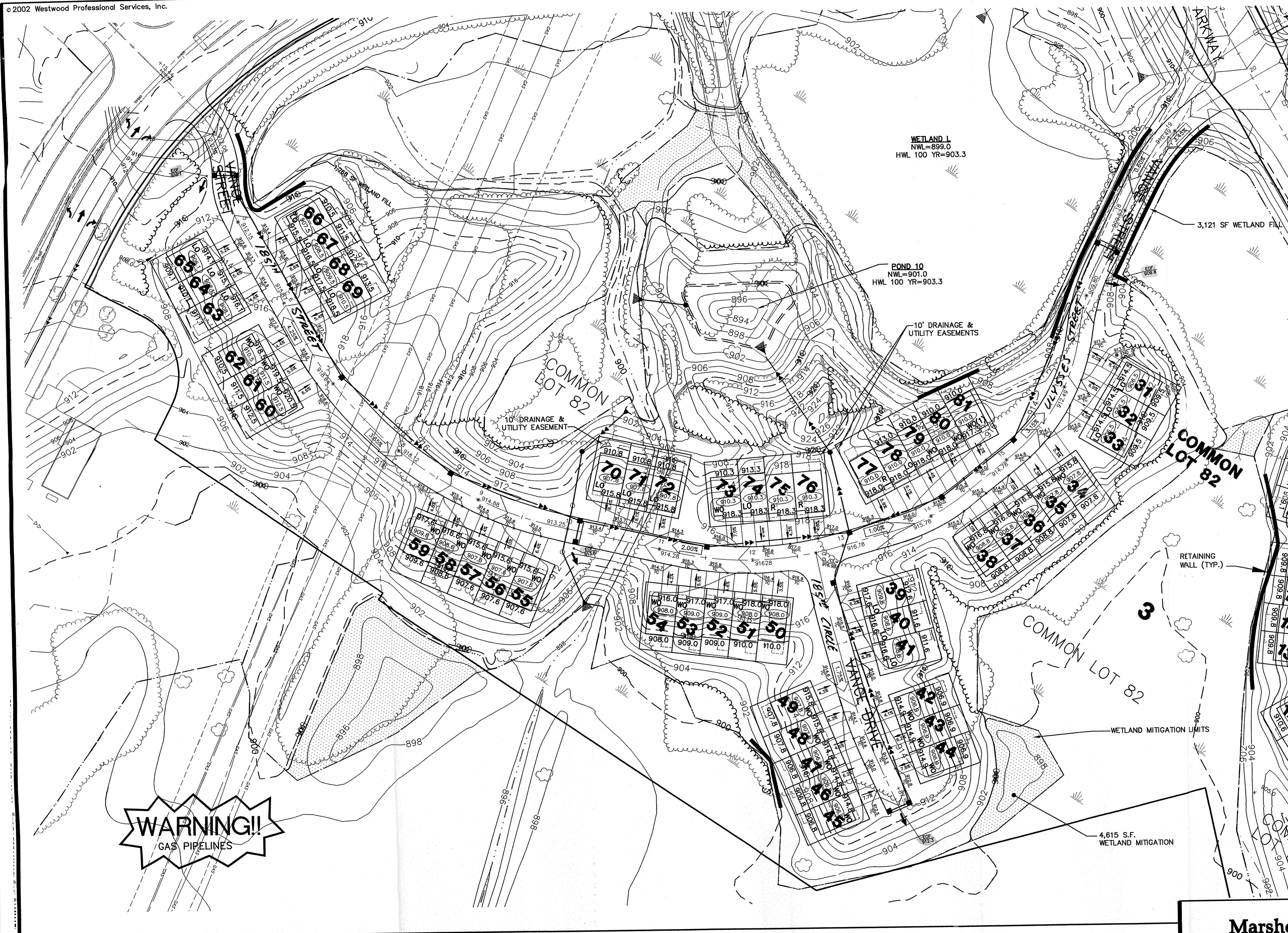

- LEGEND:**
- DENOTES SOIL BORING
 - DENOTES SILT FENCE
 - DENOTES HEAVY DUTY SILT FENCE
 - DENOTES EXISTING CONTOURS
 - DENOTES PROPOSED CONTOURS
 - DENOTES EXISTING STORM SEWER
 - DENOTES PROPOSED STORM SEWER
 - DENOTES EXISTING TREE LINE
 - DENOTES APPROXIMATE TREE REMOVAL LIMITS
 - DENOTES EXISTING SPOT ELEVATION
 - DENOTES PROPOSED SPOT ELEVATION
 - DENOTES BAILE CHECKS AROUND CATCH BASINS
 - DENOTES EMERGENCY OVERFLOW ELEVATION

APPROVED
 9/6/02 *John S. King*
 Howard R. Green Co.
 Critical GRADES

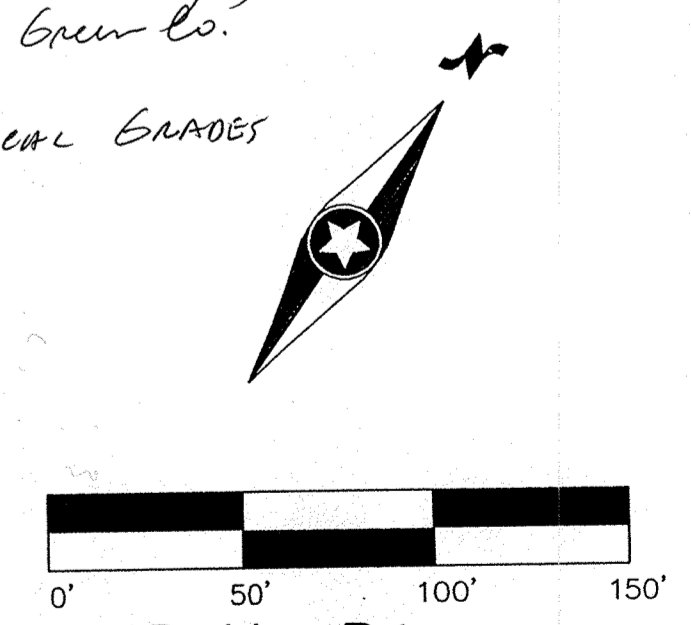

Latest Revisions Date: E-3 20011092DEV2.DWG
 Date: 08/09/02 Sheet: 2 OF 3

WARNING!!
 GAS PIPELINES

Westwood Professional Services, Inc.
 7599 Anagram Drive
 Eden Prairie, MN 55344
 Phone: 952/937-5150 Fax: 952/937-5822

I hereby certify that this plan was prepared by me or under my direct supervision and that I am a duly licensed PROFESSIONAL ENGINEER under the laws of the State of Minnesota.
Francis D. Hagen, II
 Francis D. Hagen, II
 Date: 08/09/02 License No. 17716

Revisions:	Designed:
	FDH
	Checked: FDH
	Drawn: WH
	Record Drawing by/date:

Prepared for:
D.R. Horton, Inc.
 20860 Kenbridge Court, Suite 100
 Lakeville, Minnesota 55044

**Marshes of
 Trott Brook Farms**
 Elk River, Minnesota

Development Plan

PLAN HOLD CORPORATION • IRVINE, CALIFORNIA
 REGISTERED BY NUMBER 07584
 POSITION LIST BY PRINT OR THIS LINE
 PLAN HOLD CORPORATION • IRVINE, CALIFORNIA
 REGISTERED BY NUMBER 07584
 POSITION LIST BY PRINT OR THIS LINE
 PLAN HOLD CORPORATION • IRVINE, CALIFORNIA
 REGISTERED BY NUMBER 07584
 POSITION LIST BY PRINT OR THIS LINE