

SAFCO PRODUCTS • NEW HOPE, MINNESOTA
REVISION BY PART NUMBER 0552
REVISION DATE OF PART NUMBER 0552

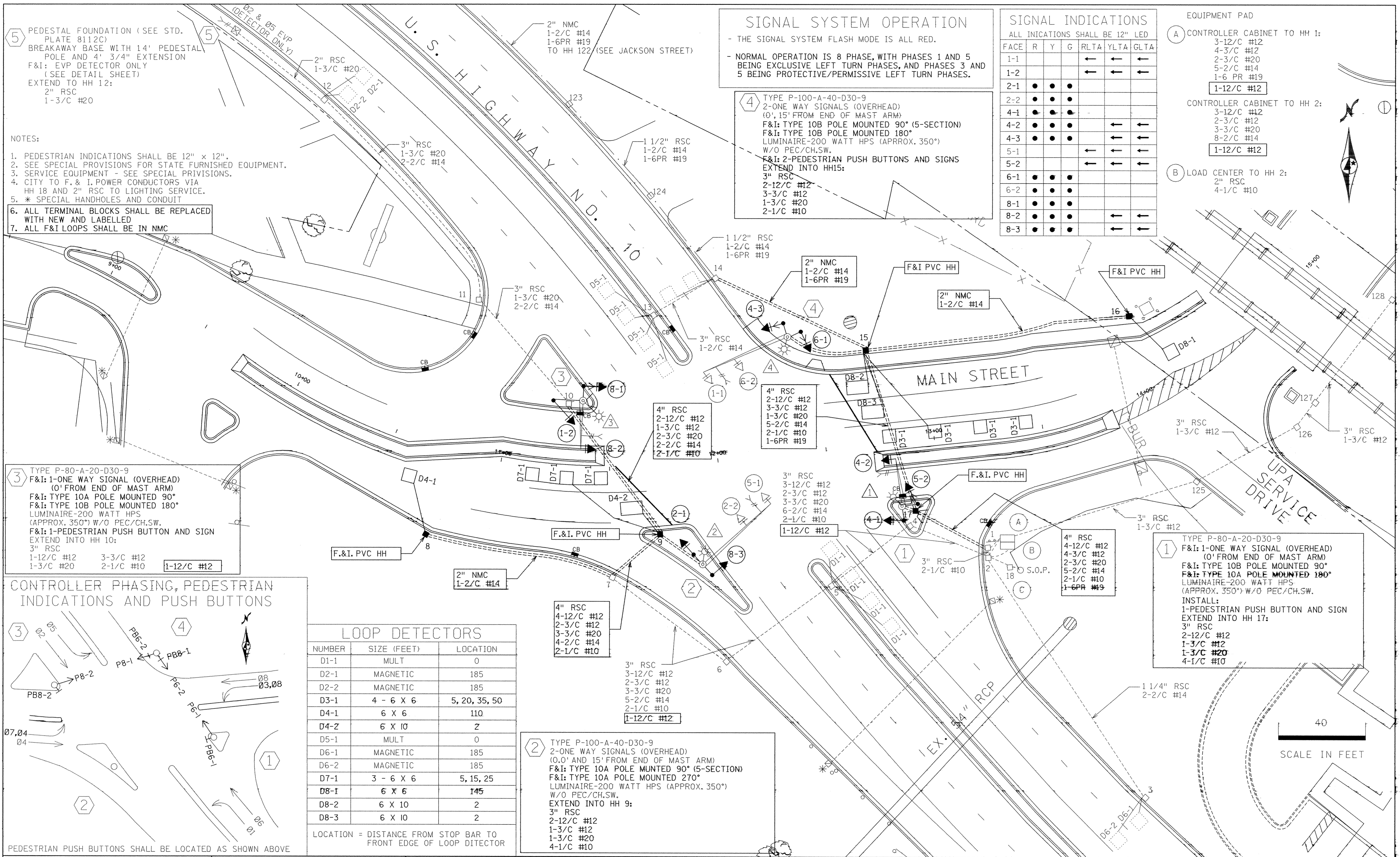

SIGNAL SYSTEM OPERATION
- THE SIGNAL SYSTEM FLASH MODE IS ALL RED.
- NORMAL OPERATION IS 8 PHASE, WITH PHASES 1 AND 5 BEING EXCLUSIVE LEFT TURN PHASES, AND PHASES 3 AND 5 BEING PROTECTIVE/PERMISSIVE LEFT TURN PHASES.

SIGNAL INDICATIONS
ALL INDICATIONS SHALL BE 12" LED

FACE	R	Y	G	RLTA	YLTA	GLTA
1-1				←	←	←
1-2				←	←	←
2-1	●	●	●			
2-2	●	●	●			
4-1	●	●	●			
4-2	●	●	●	←	←	←
4-3	●	●	●	←	←	←
5-1				←	←	←
5-2				←	←	←
6-1	●	●	●			
6-2	●	●	●			
8-1	●	●	●	←	←	←
8-2	●	●	●	←	←	←
8-3	●	●	●	←	←	←

EQUIPMENT PAD
A CONTROLLER CABINET TO HH 1:
3-12/C #12
4-3/C #12
2-3/C #20
5-2/C #14
1-6 PR #19
1-12/C #12
CONTROLLER CABINET TO HH 2:
3-12/C #12
2-3/C #12
3-3/C #20
8-2/C #14
1-12/C #12
B LOAD CENTER TO HH 2:
2" RSC
4-1/C #10

5 PEDESTAL FOUNDATION (SEE STD. PLATE 8112C)
BREAKAWAY BASE WITH 14' PEDESTAL POLE AND 4' 3/4" EXTENSION
F&I: EVP DETECTOR ONLY (SEE DETAIL SHEET)
EXTEND TO HH 12:
2" RSC
1-3/C #20

- NOTES:
1. PEDESTRIAN INDICATIONS SHALL BE 12" x 12".
 2. SEE SPECIAL PROVISIONS FOR STATE FURNISHED EQUIPMENT.
 3. SERVICE EQUIPMENT - SEE SPECIAL PROVISIONS.
 4. CITY TO F. & I. POWER CONDUCTORS VIA HH 18 AND 2" RSC TO LIGHTING SERVICE.
 5. * SPECIAL HANDHOLES AND CONDUIT
 6. ALL TERMINAL BLOCKS SHALL BE REPLACED WITH NEW AND LABELLED
 7. ALL F&I LOOPS SHALL BE IN NMC

3 TYPE P-80-A-20-D30-9
F&I: 1-ONE WAY SIGNAL (OVERHEAD) (0' FROM END OF MAST ARM)
F&I: TYPE 10A POLE MOUNTED 90°
F&I: TYPE 10B POLE MOUNTED 180°
LUMINAIRE-200 WATT HPS (APPROX. 350") W/O PEC/CH.SW.
F&I: 1-PEDESTRIAN PUSH BUTTON AND SIGN
EXTEND INTO HH 10:
3" RSC
1-12/C #12 3-3/C #12
1-3/C #20 2-1/C #10
1-12/C #12

CONTROLLER PHASING, PEDESTRIAN INDICATIONS AND PUSH BUTTONS

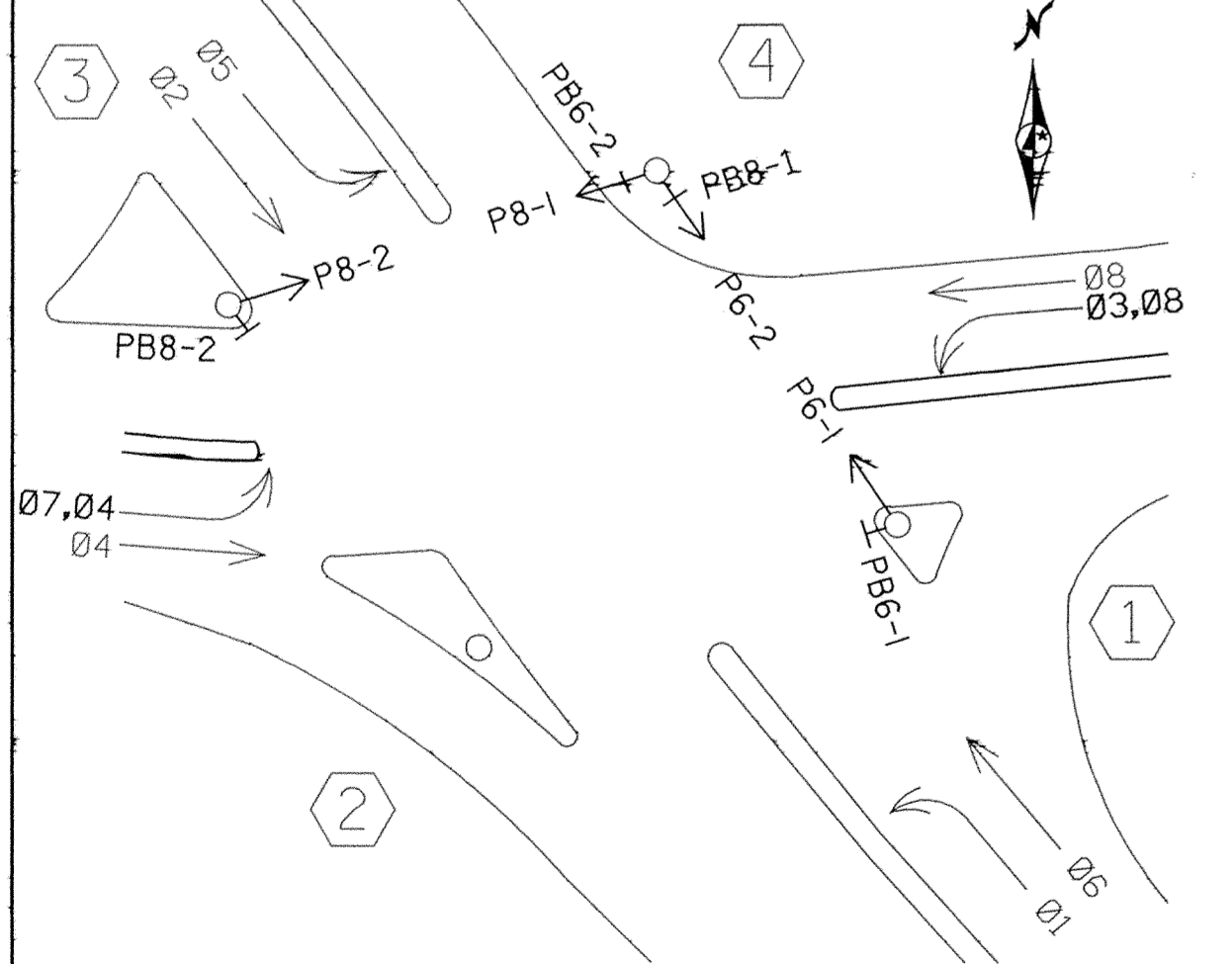

LOOP DETECTORS

NUMBER	SIZE (FEET)	LOCATION
D1-1	MULT	0
D2-1	MAGNETIC	185
D2-2	MAGNETIC	185
D3-1	4 - 6 X 6	5, 20, 35, 50
D4-1	6 X 6	110
D4-2	6 X 10	2
D5-1	MULT	0
D6-1	MAGNETIC	185
D6-2	MAGNETIC	185
D7-1	3 - 6 X 6	5, 15, 25
D8-1	6 X 6	145
D8-2	6 X 10	2
D8-3	6 X 10	2

LOCATION = DISTANCE FROM STOP BAR TO FRONT EDGE OF LOOP DETECTOR

2 TYPE P-100-A-40-D30-9
2-ONE WAY SIGNALS (OVERHEAD) (0.0' AND 15' FROM END OF MAST ARM)
F&I: TYPE 10A POLE MOUNTED 90° (5-SECTION)
F&I: TYPE 10A POLE MOUNTED 270°
LUMINAIRE-200 WATT HPS (APPROX. 350") W/O PEC/CH.SW.
EXTEND INTO HH 9:
3" RSC
2-12/C #12
1-3/C #12
1-3/C #20
4-1/C #10

DESIGNED BY: CNR DRAWN BY: RJS
APPROVED BY: BCJ JOB NUMBER 816600J
CAD DATE: 01/31/2005 11:11:03 AM
CAD FILE: c:\ad\816600J\dgn\TH10-Main Layout.dgn

I HEREBY CERTIFY THAT THIS PLAN, SPECIFICATION, OR REPORT WAS PREPARED BY ME OR UNDER MY DIRECT SUPERVISION AND THAT I AM A DULY LICENSED PROFESSIONAL ENGINEER UNDER THE LAWS OF THE STATE OF MINNESOTA
SIGNATURE: _____ DATE: 3/28/03
PRINTED NAME: BRIAN C. JOHNSON LIC. NO. 26815

NO. DATE BY REVISION DESCRIPTION

1	2/10/05	SM	As-BUILTS
---	---------	----	-----------

1326 ENERGY PARK DRIVE
ST. PAUL, MINNESOTA 55108
(651) 644-4389
Howard R. Green Company

MAIN ST./U.S. HIGHWAY NO. 10
CITY OF ELK RIVER

SIGNAL REVISION LAYOUT
S.P. 204-113-12
T.E. #3165
SYS. ID 20198

SHEET NO.
15

