

# MAIN STREET

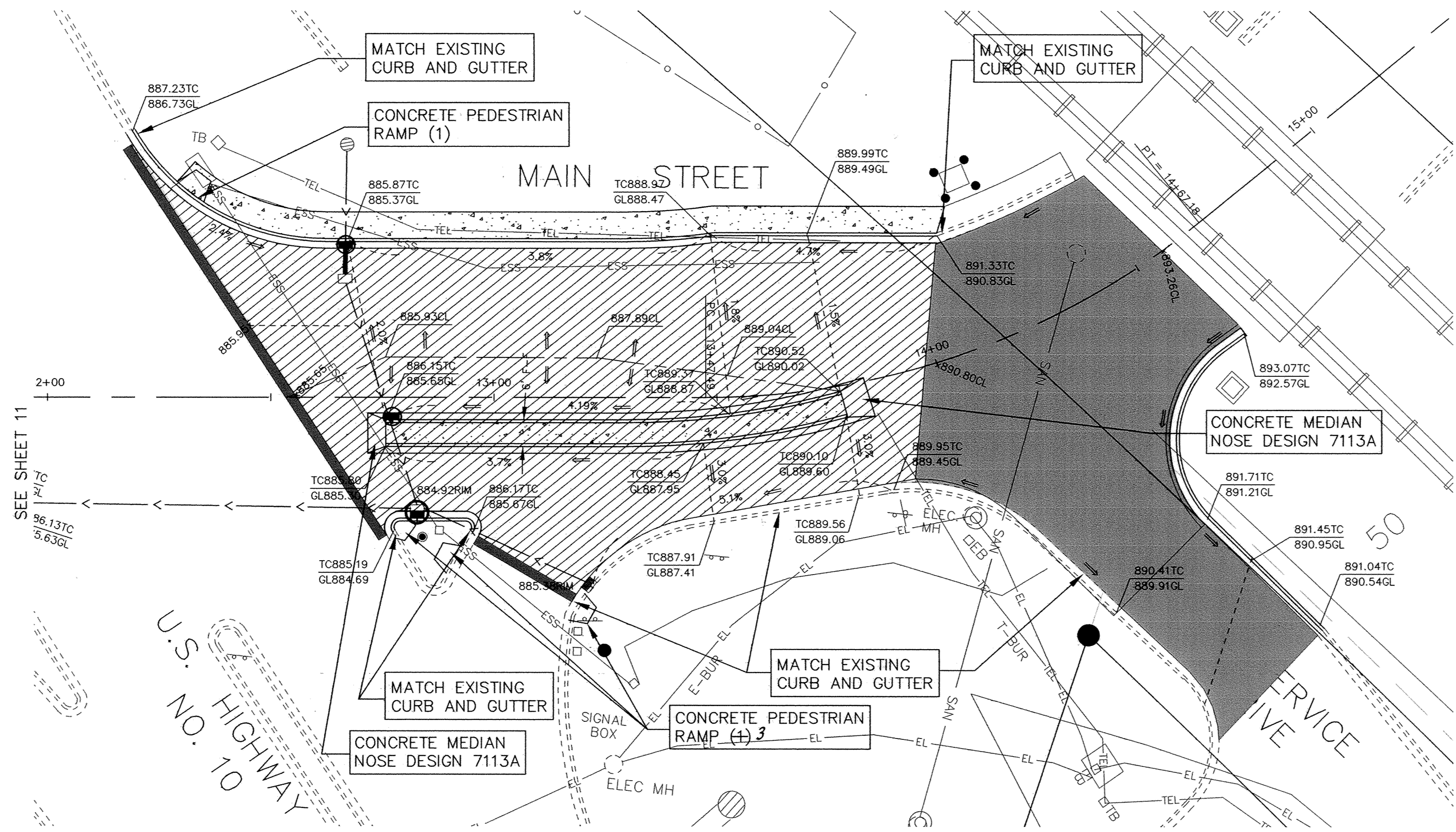

-  - DENOTES CONCRETE MEDIAN SECTION
-  - DENOTES FULL PAVEMENT SECTION
-  - DENOTES BITUMINOUS MILL SECTION
-  - DENOTES B618 CONCRETE CURB AND GUTTER

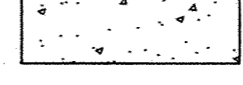
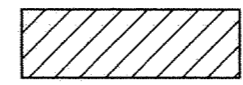
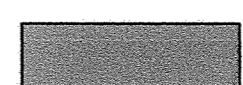
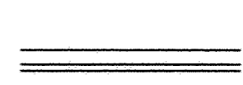
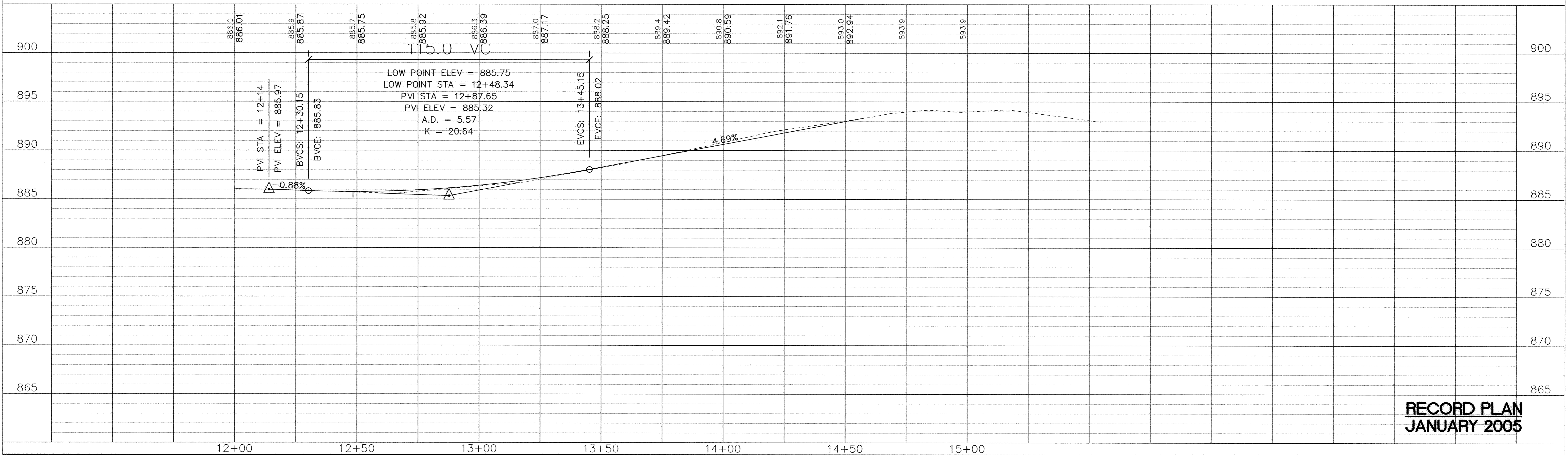
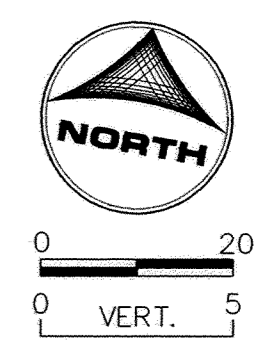

**RECORD PLAN  
JANUARY 2005**

DESIGNED BY: EY DRAWN BY: EY  
 APPROVED BY: \_\_\_\_\_ JOB NUMBER 816600J  
 CAD DATE: January\_06\_2005 11:05:17 a.m.  
 CAD FILE: 816600\ASBUILT\816600P-P.DWG (JCUNNIN)

I HEREBY CERTIFY THAT THIS PLAN, SPECIFICATION, OR REPORT WAS PREPARED BY ME OR UNDER MY DIRECT SUPERVISION AND THAT I AM A DULY LICENSED PROFESSIONAL ENGINEER UNDER THE LAWS OF THE STATE OF MINNESOTA.  
 SIGNATURE: *John Anderson* DATE: 2/2/05  
 PRINTED NAME: JOHN ANDERSON LIC. NO.: 25889

| NO. | DATE   | BY | REVISION DESCRIPTION    |
|-----|--------|----|-------------------------|
| 1.  | 9-3-03 | RM | REVISE PROFILE SETTINGS |
|     |        |    |                         |
|     |        |    |                         |

 Howard R. Green Company  
 1326 ENERGY PARK DRIVE  
 ST. PAUL, MINNESOTA 55108  
 (651) 644-4389

**MAIN STREET/U.S. HIGHWAY NO. 10  
CITY OF ELK RIVER**

STREET IMPROVEMENTS  
 S.P. 204-113-12  
 12+00 TO 15+50

SHEET NO.  
**12**