

LEGEND

	TYPE III BARRICADE				
	BRIDGE NO. 71517				
	TRAFFIC DETOUR ROUTE				
	MESSAGE	SIGN NO.	SIZE	QUANTITY	COLOR
	① MAIN STREET BRIDGE CLOSED	D-1	78"x30"	1	BLACK ON ORANGE
	DETOUR	M4-9T	30"x24"	1	BLACK ON ORANGE
	② BRIDGE CLOSED AHEAD	W20-X4	48"x48"	2	BLACK ON ORANGE
	③ DETOUR	M4-9R	30"x24"	5	BLACK ON ORANGE
	MAIN STREET BRIDGE TRAFFIC	D-2	78"x30"	5	BLACK ON ORANGE
	④ DETOUR	M4-9L	30"x24"	5	BLACK ON ORANGE
	MAIN STREET BRIDGE TRAFFIC	D-2	78"x30"	5	BLACK ON ORANGE
	⑤ DETOUR	M4-9T	30"x24"	1	BLACK ON ORANGE
	MAIN STREET BRIDGE TRAFFIC	D-2	78"x30"	1	BLACK ON ORANGE
	⑥ END DETOUR	M4-8A	24"x18"	2	BLACK ON ORANGE
	⑦ ROAD CLOSED	R11-2	48"x30"	2	BLACK ON WHITE

- NOTES:
- 1) DETOUR SIGNING SHALL CONFORM TO REQUIREMENTS OF MN/DOT 2564, TRAFFIC SIGNS AND DEVICES, AND THE LATEST EDITION OF THE MINNESOTA MANUAL ON UNIFORM TRAFFIC CONTROL DEVICES.
 - 2) TYPE "D" SIGN PANELS SHALL HAVE A HIGH INTENSITY REFLECTORIZED BACKGROUND.
 - 3) EXACT SIGN LOCATIONS TO BE DETERMINED IN THE FIELD BY THE ENGINEER.

RECORD PLAN OCT. 1993

CITY OF ELK RIVER
S.P. NO. 204-113-03
MAIN STREET BRIDGE
TRAFFIC DETOUR AND SIGNING PLAN

DATE JULY, 1992 SHEET 24A OF 24 SHEETS PROJECT NO. 230-030

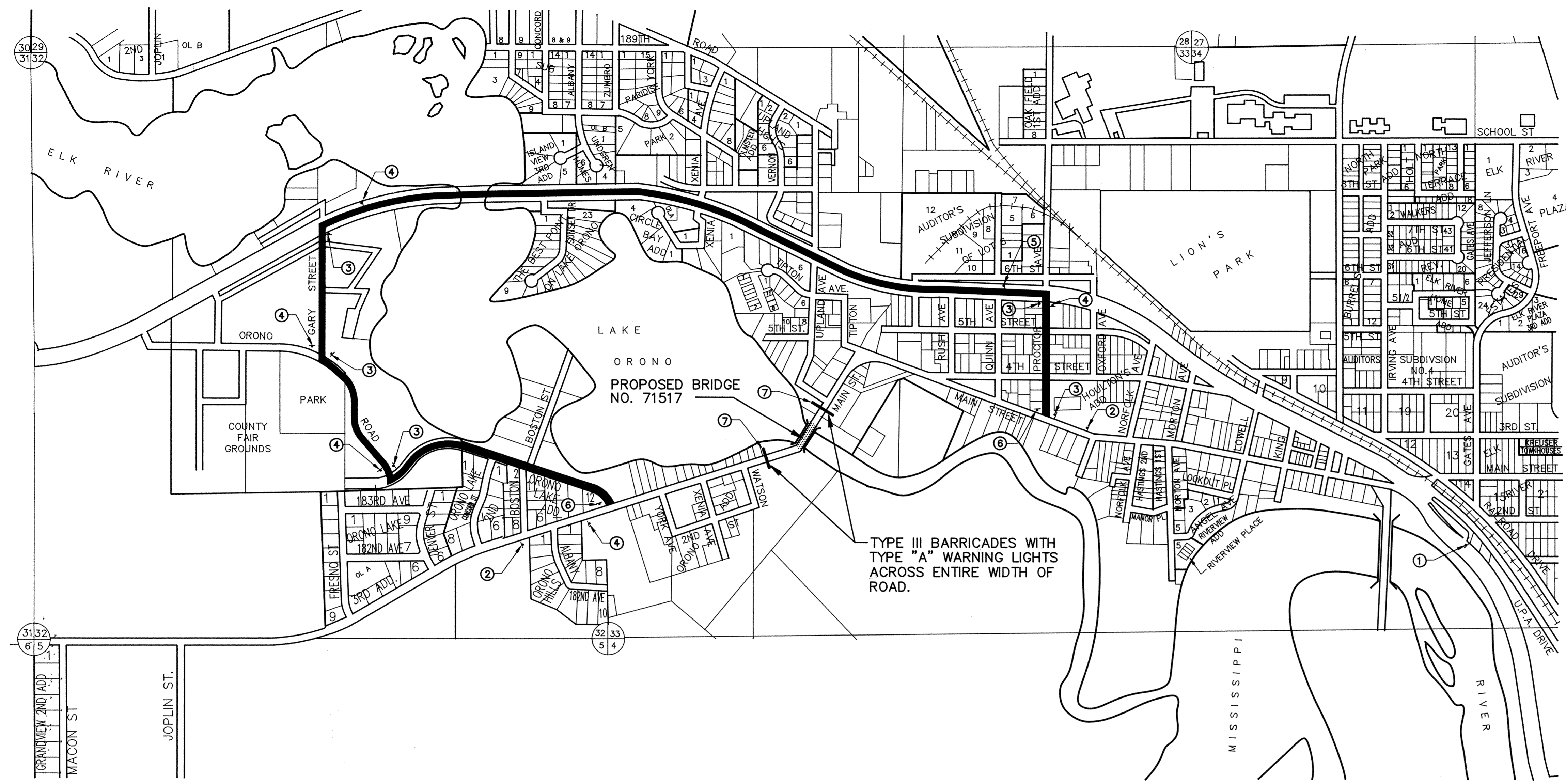

TYPE III BARRICADES WITH
TYPE "A" WARNING LIGHTS
ACROSS ENTIRE WIDTH OF
ROAD.



78"x30", 3"R. 1.0"B BLACK/ORANGE D-1
LINE 1 56.0 : 6"-4 1/2" E MOD.
LINE 2 64.4 : 6"-4 1/2" E MOD.

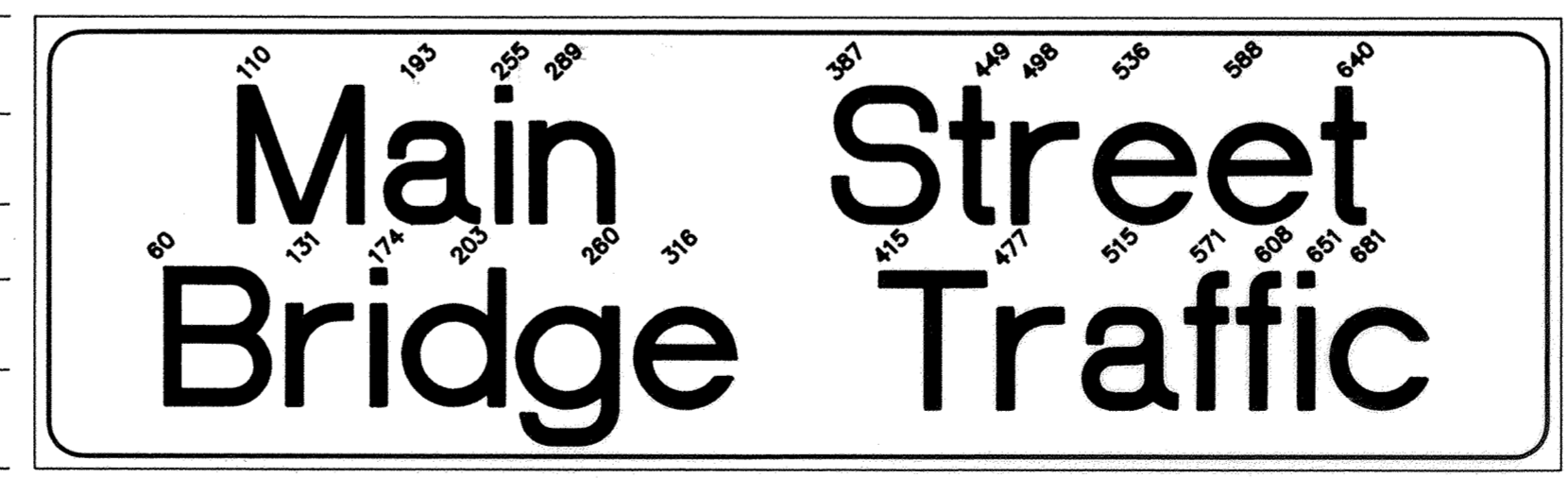

78"x30", 3"R. 1.0"B BLACK/ORANGE D-2
LINE 1 56.0 : 6"-4 1/2" E MOD.
LINE 2 65.9 : 6"-4 1/2" E MOD.

I HEREBY CERTIFY THAT THIS PLAN, SPECIFICATION, OR REPORT WAS PREPARED BY ME OR UNDER MY DIRECT SUPERVISION AND THAT I AM A DULY REGISTERED PROFESSIONAL ENGINEER UNDER THE LAWS OF THE STATE OF MINNESOTA.
Mark J. Gresham
DATE 7-16-92 REG. NO. 19130

Maier Stewart & Associates Inc.
CONSULTING ENGINEERS
9800 SHELARD PARKWAY (612) 546-0432 MINNEAPOLIS, MINNESOTA 55441
1959 SLOAN PLACE (612) 774-6021 ST. PAUL, MINNESOTA 55117

DATE	DESCRIPTION	DESIGNED	CHECKED

GRAPHIC SCALE	0	600
° HORIZ.		
° VERT.		