

MAIN STREET

EXTEND 25'-6" WATERMAIN TO NORTH END OF PROPOSED STREET CONSTRUCTION AND CONNECT TO EXISTING 4". DISCONNECT & PLUG 1"=0 (NEW STOP) EXISTING LINE @ 6" MAIN (INCIDENTAL)
 REMOVE EXISTING MANHOLE AND EXTEND EXISTING 8" SANITARY SEWER FROM THE NORTH TO NEW MANHOLE

#936
 WYE = 11+06 = 4"=19 (RECONNECT)
 WYE = 11+20 = 4"=21 (RECONNECT)
 1"=0 (NEW STOP)

#926
 WYE = 10+43
 4"=20 (RECONNECT)
 1"=0 (USED EX₂)

#942
 HITCHING POST
 WYE = 12+34
 6"=21 (RECONNECT)
 1"=0 (NEW STOP)

14'-8" PIPE @ 5.00%
 OLD
 INSTALL NEW 6" HYDRANT LEAD AND 6" VALVE. CONNECT TO EXISTING HYDRANT
 NEW

DISCONNECT AND PLUG AT MAIN (INCIDENTAL)

CUT IN 6"x6"x6" TEES

HYD "A" = 90
 MH 10 = 22

REPLACE W/ NEW 6" VALVE

SEE SHEET 9

CONNECT EXISTING 8" SANITARY SEWER FROM THE SOUTH TO NEW MANHOLE 8" FIC = 7'

55'
 EXTEND 6" WATERMAIN TO SOUTH END OF PROPOSED STREET CONSTRUCTION AND CONNECT TO EXISTING 4"

#957
 WYE = 13+63
 4"=13 (RECONNECT)
 1"=NO WATER

NOTE: CONNECT ALL EXISTING SANITARY SEWER SERVICES TO NEW 18"

#943
 WYE = 12+43
 4"=20 (RECONNECT)
 1"=ED (RECONNECT)

#931
 WYE = 10+26
 4"=22 (RECONNECT)
 1"=10 (RECONNECT)

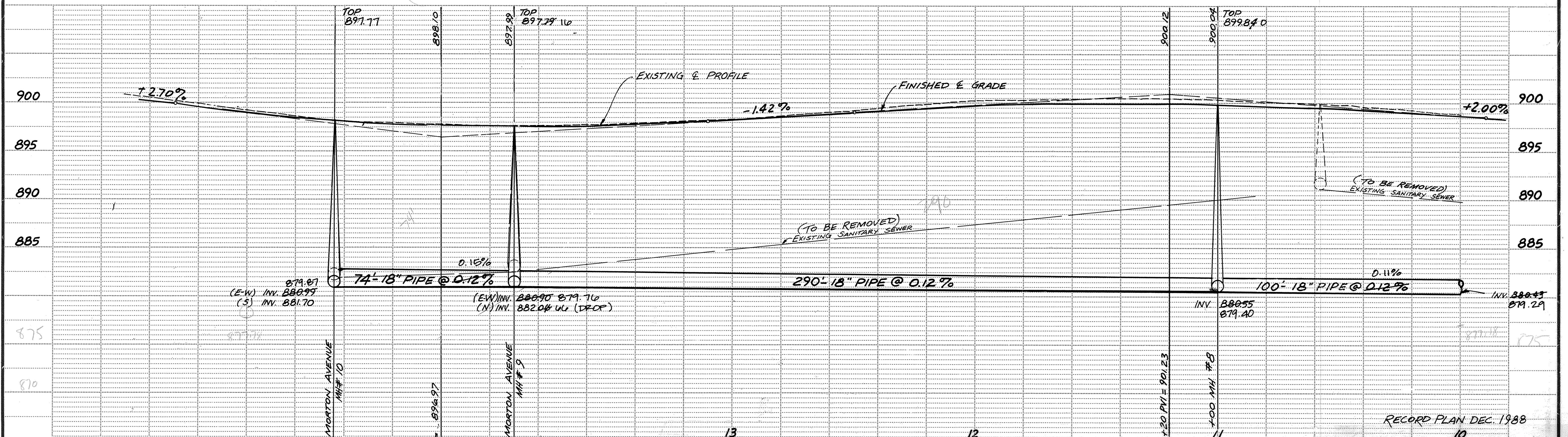

		CONSULTING ENGINEERS		DESIGNED	
		Maier Stewart & Associates Inc.		CHECKED	
1959 SLOAN PLACE		(612) 774-6021		DATE 3/5/88	
ST. PAUL, MINNESOTA 55117		DESCRIPTION		DRAWN MRJ	
		Street Grades		GRAPHIC SCALE	
				0 HORIZ. 20	
				0 VERT. 5	
				CITY OF ELK RIVER	
				SANITARY SEWER	
				MAIN STREET	
				DATE OCT 1987	
				SHEET 8 OF 42 SHEETS	
				PROJECT NO. 230-014	

DRAWING NUMBER
 MAINS 87
 8
 267