

DRAWING NUMBER
MANS 87
1

M.S.A.S. MAIN STREET 204-113-04
PROCTOR AVE. 204-101-01
JACKSON AVE 204-104-02

MAIN STREET 204-113-04	LENGTH	5211 FEET	0.99	MILES
PROCTOR AVE. 204-101-01	LENGTH	1011 FEET	0.19	MILES
JACKSON AVE 204-104-02	LENGTH	294 FEET	0.06	MILES

PLAN 1" = 20'
SCALES: PROFILE HOR. 1" = 20'
VERT. 1" = 5'
CROSS SECTIONS HOR. 1" = 10'
VERT. 1" = 5'

INDEX OF SHEETS

- 1 TITLE SHEET & LAYOUT MAP
- 2 EST. QUANTITY, STREET SECTIONS & NOTES
- 3 LOCATION MAP
- 4-16 SANITARY SEWER
- 17-31 STORM SEWER & STREET
- 32-38 CROSS SECTIONS
- 39-42 STANDARD DETAILS

THE 45 DEGREE DIAGONAL PARKING WITH A 22.2' TRAFFIC ISLE IN LIEU OF THE REQUIRED 25.2' TRAFFIC ISLE ON JACKSON STREET IS ALLOWED BY A VARIANCE TO STATE AID STANDARDS 8820.9916, DATED MARCH 26, 1984, GRANTED BY THE COMMISSIONER OF TRANSPORTATION ON DECEMBER 23, 1987.

THE 45 DEGREE DIAGONAL PARKING WITH A 22.2' TRAFFIC ISLE IN LIEU OF THE REQUIRED 25.5' TRAFFIC ISLE ON MAIN STREET IS ALLOWED BY A VARIANCE TO STATE AID STANDARDS 8820.9916, DATED MARCH 26, 1984, GRANTED BY THE COMMISSIONER OF TRANSPORTATION ON DECEMBER 1, 1987.

I HEREBY CERTIFY THAT THIS PLAN, SPECIFICATION, OR REPORT WAS PREPARED BY ME OR UNDER MY DIRECT SUPERVISION AND THAT I AM A DULY REGISTERED PROFESSIONAL ENGINEER UNDER THE LAWS OF THE STATE OF MINNESOTA.

Terry J. Mauer
DATE 1/11/88 REG. NO. 15316

APPROVED *Terry J. Mauer* CITY ENGINEER 1/11/88 DATE
RECOMMENDED FOR APPROVAL *D. J. O. Reed* DISTRICT STATE AID ENGINEER 1/23/88 DATE
RECOMMENDED FOR APPROVAL *Julie Skallman* STATE PLANS & SPEC. ENGINEER 2/10/88 DATE
APPROVED 2/10 1988 *William M. Gay* STATE AID DIRECTOR DATE

CITY OF ELK RIVER
SECTIONS 33 & 34, T33N, R26W
SANITARY SEWER, WATERMAIN,
STORM DRAINAGE & STREET CONSTRUCTION
MAIN STREET, PROCTOR
AVENUE, JACKSON AVENUE

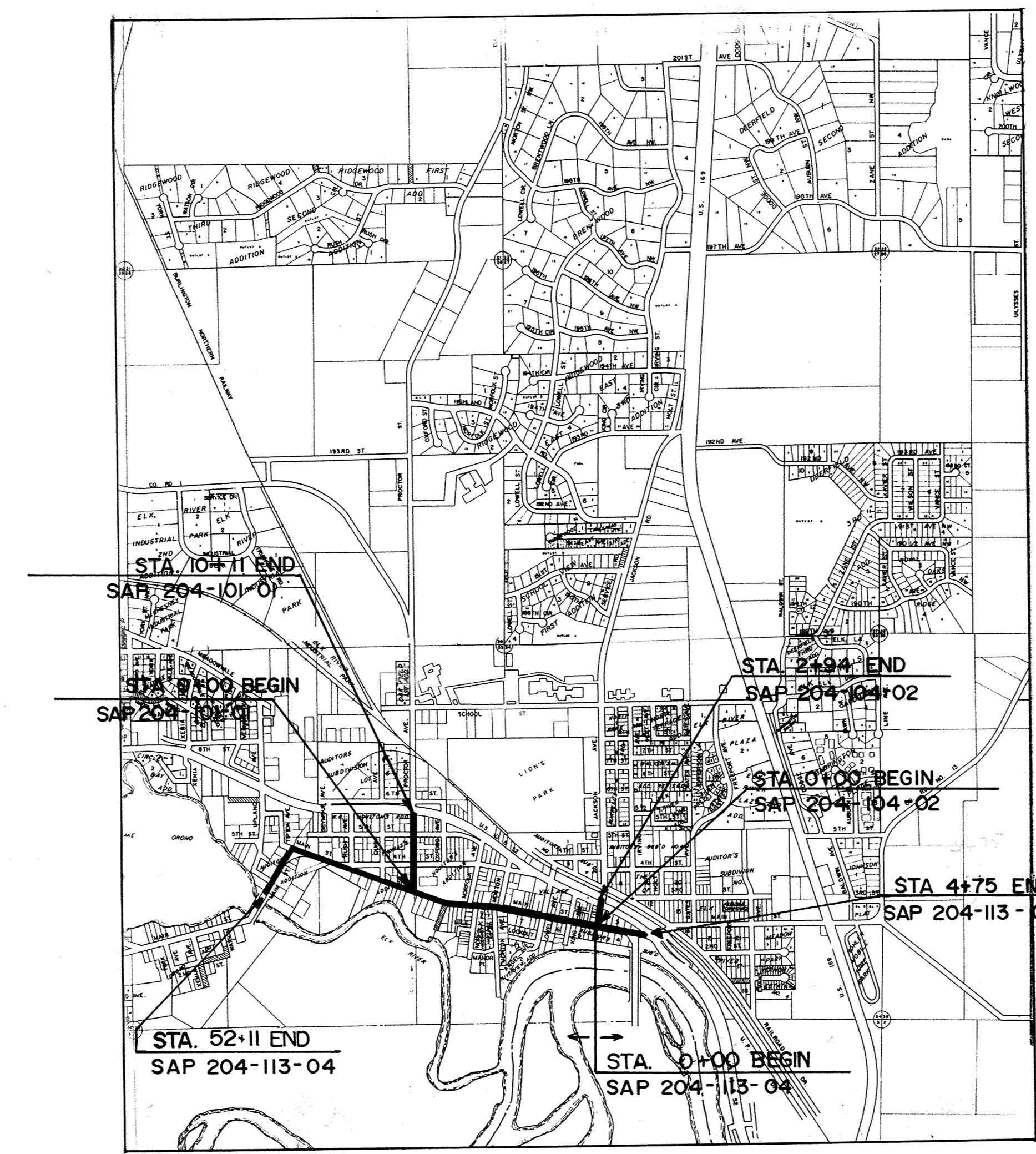

PLAN SYMBOLS

- | | | | |
|-------------------|-----------|-----------------|---|
| SECTION LINE | ————— | TREES | |
| QUARTER LINE | ----- | BRUSH OR SHRUBS | |
| SIXTEENTH LINE | - - - - - | HEDGE | |
| RIGHT OF WAY LINE | ————— | CONIFERS | |
| PROPERTY LINE | ————— | SWAMP | |
| CENTER LINE | ————— | MAILBOX | □ |
| FENCE LINE | - x - x - | SIGN | + |
| RIVER OR CREEK | | | |
| LAKE OR POND | | | |
| CULVERT | ----- | | |
| BRIDGE | ----- | | |
| RETAINING WALL | ===== | | |

UTILITIES SYMBOLS

- | | | | |
|----------------|---|---------------------------------|--|
| SANITARY SEWER | | HYDRANT | |
| STORM SEWER | | POWER, TELEPHONE, OR LIGHT POLE | |
| WATERMAIN | | ANCHOR | |
| GAS LINE | | SOIL BORING LOCATION | |
| POWER LINE | | | |
| MANHOLE | ● | | |
| CATCH BASIN | ⊕ | | |
| VALVE | ○ | | |

	MAIN ST 204-113-04	PROCTOR AVE 204-101-01	JACKSON AVE 204-104-02
ADT CURRENT YEAR	2155-4625 (1980)	1037 (1980)	3665 (1980)
ADT FUTURE YEAR	3111-6891 (2000)	1545 (2000)	5461 (2000)
HCA DT	<1100	<1100	<1100
DESIGN SPEED	40 MPH	40 MPH	40 MPH
LOCALLY RESTRICTED TO	30 MPH	30 MPH	30 MPH
SOIL TYPE (SUBGRADE)	A-2	A-2	A-2
SOIL FACTOR	50 %	50 %	50 %
STRUCTURAL DESIGN	9 TON	9 TON	9 TON

STOPPING SITE DISTANCE BASED ON
3.5' HEIGHT OF EYE
0.5' HEIGHT OF OBJECT

STOP CONDITIONS AT:
MAIN & JACKSON
JACKSON & MAIN
MAIN & TIPTON
PROCTOR & MAIN

SPECIFICATION
The Minnesota Department of Transportation "Standard Specifications for Construction", 1983 Edition, shall govern except as modified or altered by the special provisions.