

MAIN STREET

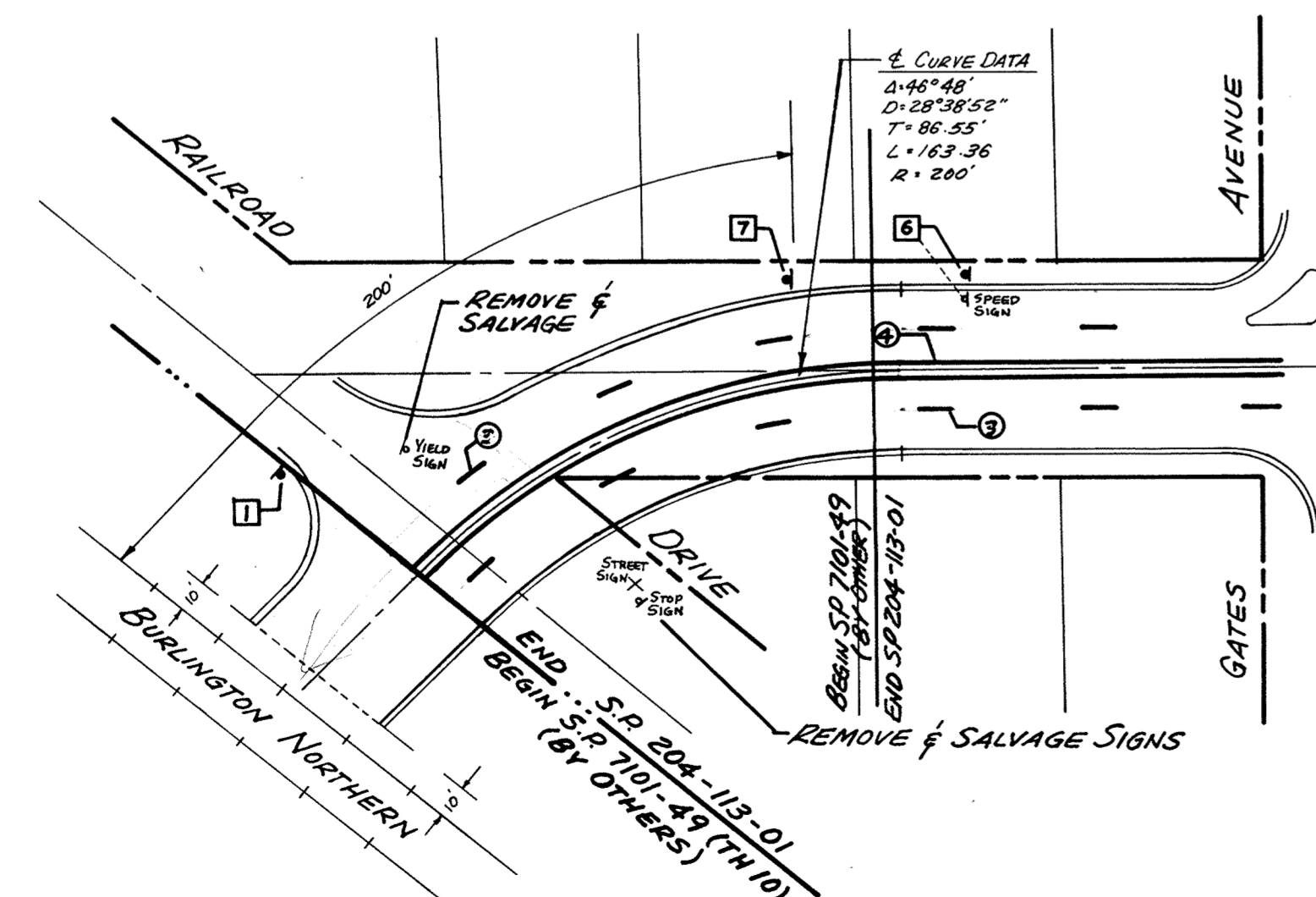
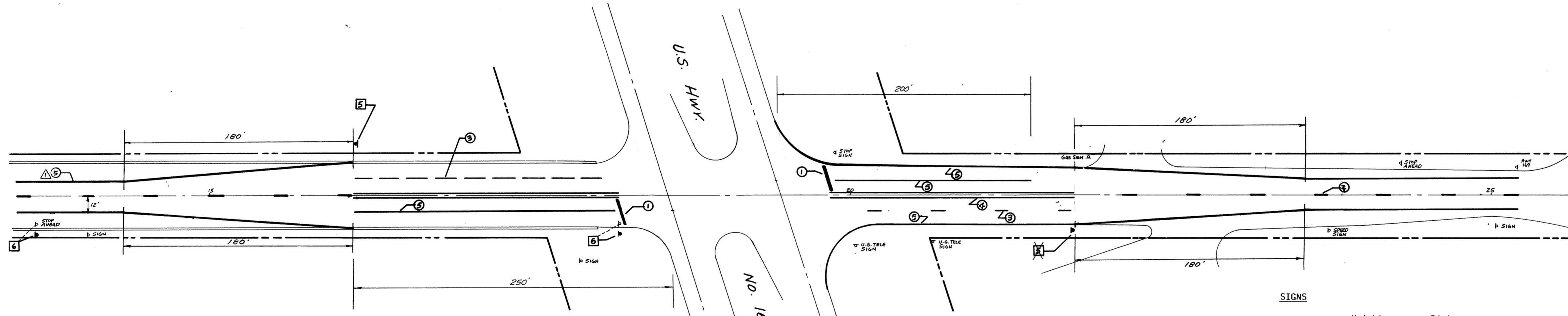
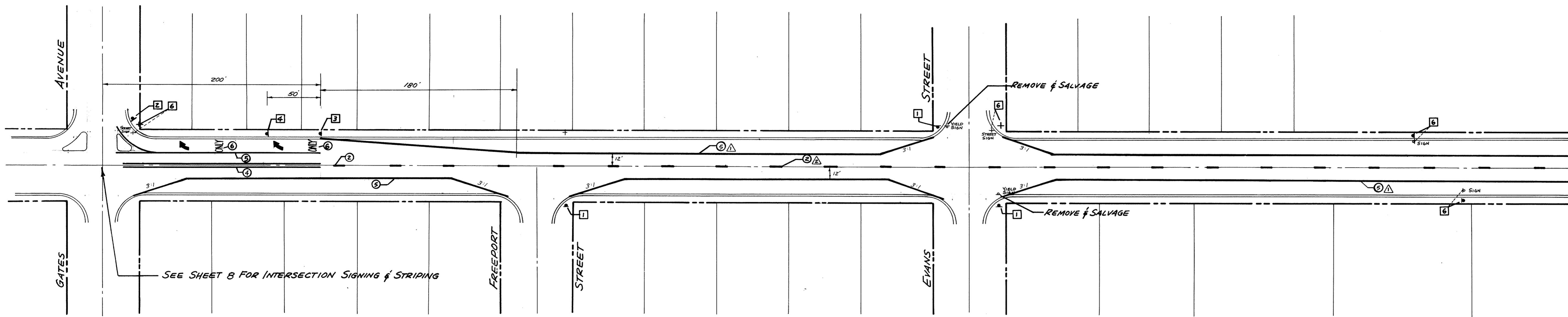

SIGNS

Description	Height To Bottom	Distance Behind Curb/Mat
1 Stop (R1-1) (30"x30")	7'	2'
2 Yield (R1-2) (36"x36"x36")	7'	2'
3 Double Turn (R3-8) (36"x30")	7'	2'
4 Right Lane Must Turn Right (R3-7) (30"x30")	7'	2'
5 Right Lane Ends (W9-1) (36"x36")	7'	2'
6 Relocate Existing Sign	7'	2'
7 Railroad Crossing (W10-1) (36" Dia.)	7'	2'

Note: Any existing signs not utilized are to be salvaged and delivered to the city

STRIPING

Description	Width	Color	Remarks
1 Stop Line	18"	White	Solid
2 Centerline Stripes	4"	Yellow	10' Line, 40' Gap
3 Centerline Stripes	4"	White	10' Line, 40' Gap
4 Double Line	4"	Yellow	Solid
5 Lane Line	4"	White	Solid
6 Arrow With Only	--	White	Only 8' High x 59" Wide, 32' between markings, Arrow 8' High

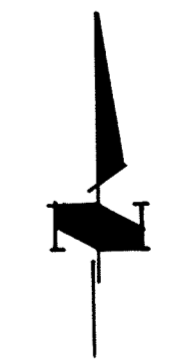

AS-BUILT
 DRAWN BY: MLK Date 2-4-85
 CHECKED BY:
 INSPECTOR: CH Date 2-11-85
 DESIGN ENGR.: Date
 PARTY CHIEF: SS Date 2-11-85

I hereby certify that this plan, specification or report was prepared by me or under my direct supervision and that I am a duly Registered Professional Engineer under State of Minn. Statutes Sections 326.02 to 326.16.
Ernest J. Mauer
 Date 10/18/83 Minn. Reg. No. 15316

consulting engineers diversified inc. **EDI**
 p.o. box j, osseo, minnesota 55369 • (612) 425-2181

REVISIONS 7/4
 LANE LINE 5-30-84
 SKIP LINE 5-30-84
 SCALE 1"=50'
 HORIZ. 1"=50'
 VERT. ---

DESIGNED BY TM
 CHECKED BY TM
 DRAWN BY TM

S.A.P. No. 204-113-01
CITY OF ELK RIVER
SIGNING & STRIPING
MAIN STREET
 DATE Sept, 83 SHEET 9 OF 14 SHEETS
 FILE NO. ER 314.02

DRAWING NUMBER

DRAWING NUMBER

DRAWING NUMBER

DRAWING NUMBER
MAINS 83
9