

MAIN STREET

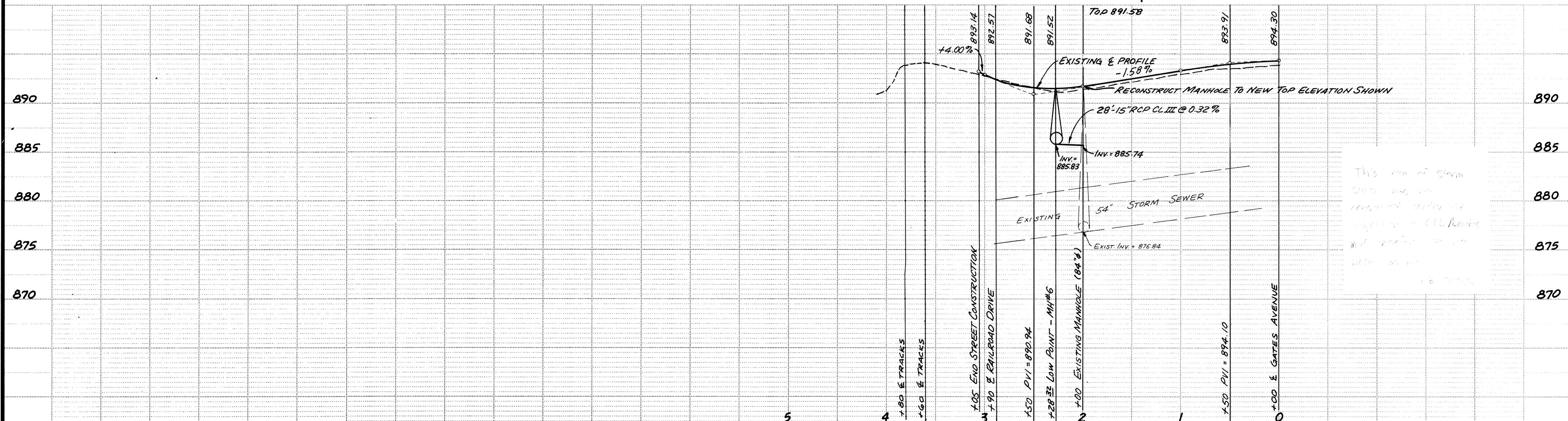
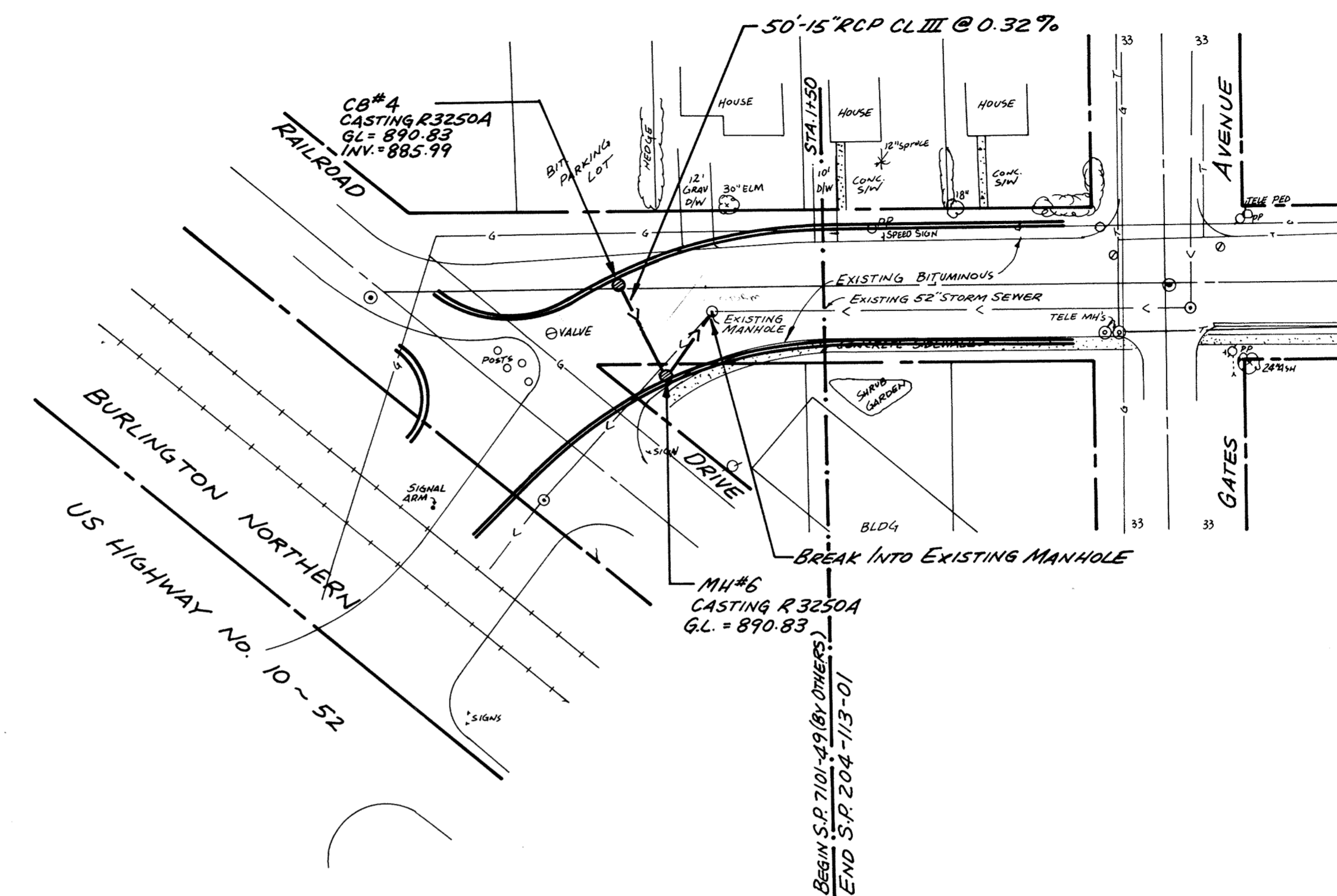

This view of storm sewer was prepared by the engineer and is not to be used for any other purpose.

I hereby certify that this plan, specification or report was prepared by me or under my direct supervision and that I am a duly Registered Professional Engineer under State of Minn. Statutes Sections 326.02 to 326.16. <i>Erin J. Moens</i> Date <i>10/14/83</i> Minn. Reg. No. <i>15316</i>	consulting engineers diversified inc. civil municipal planning environmental land surveying geotechnics P.O. Box 10580, Osseo, Minnesota 55369 • (612) 425-2181	DESIGNED BY <i>TJM</i>	CITY OF ELK RIVER STORM SEWER MAIN STREET
		CHECKED BY <i>TJM</i>	
REVISIONS GRAPHIC SCALE HORIZ 50 VERT 5		DRAWN BY MKJ	SHEET <i>5A</i> OF 15 SHEETS FILE NO. <i>ER 314.02</i>

STATE AID PROJECT NO. 204-113-01

DRAWING NUMBER MAINS 83 5A