

## STORM 1000

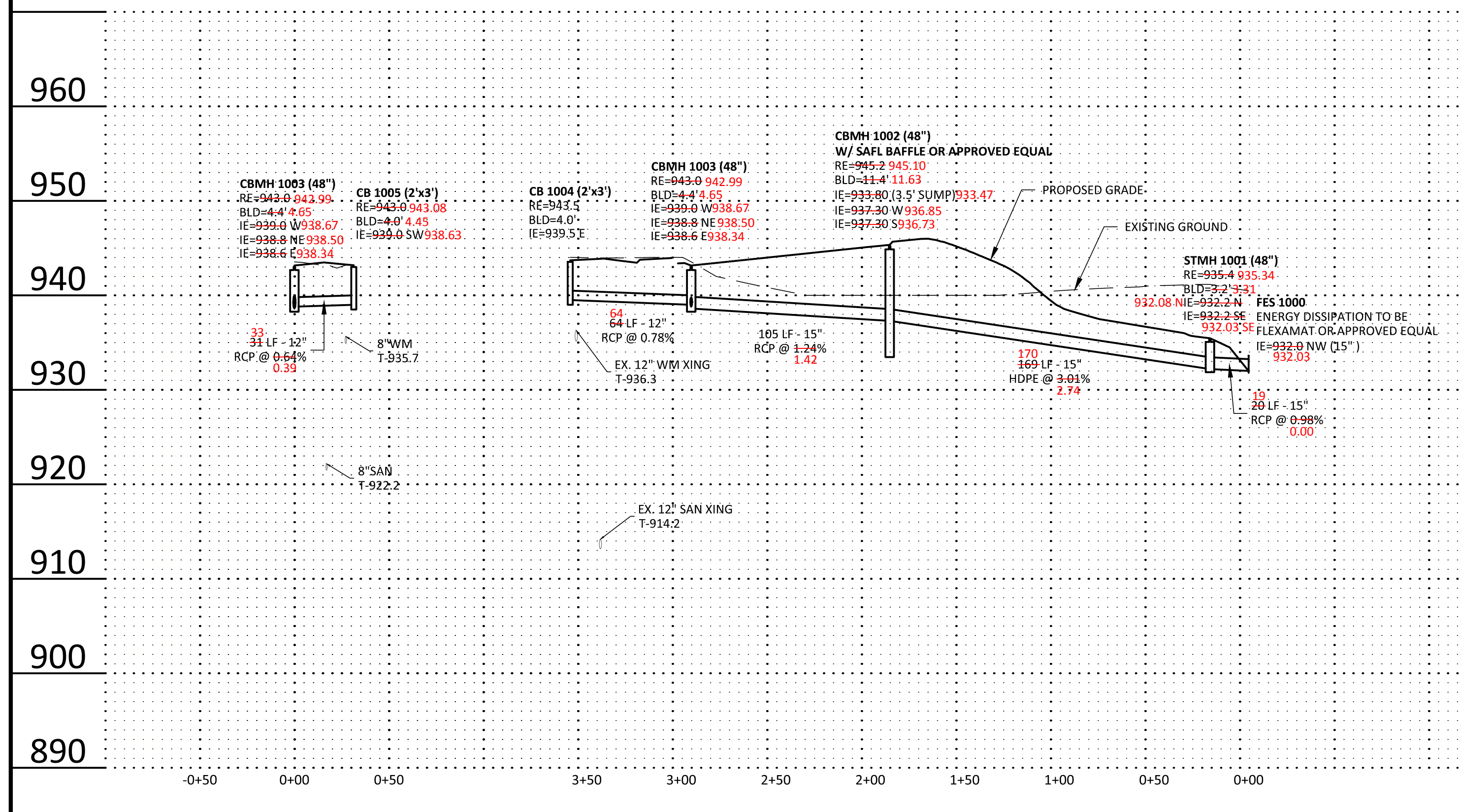

## STORM 1100

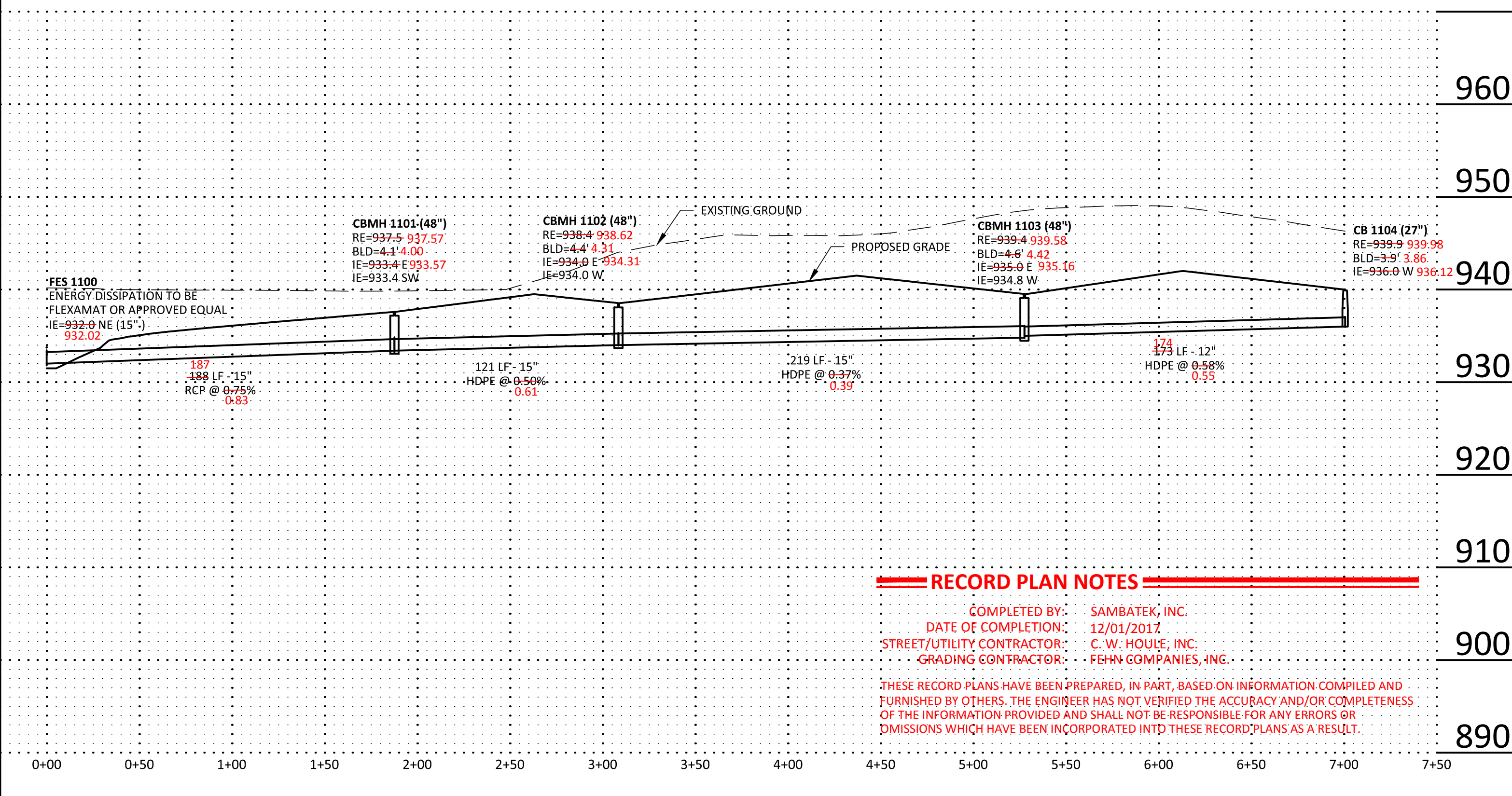

**RECORD PLAN NOTES**

COMPLETED BY: SAMBATEK, INC.  
DATE OF COMPLETION: 12/01/2017  
STREET/UTILITY CONTRACTOR: C. W. HOULE, INC.  
GRADING CONTRACTOR: FERRY COMPANIES, INC.

THESE RECORD PLANS HAVE BEEN PREPARED, IN PART, BASED ON INFORMATION COMPILED AND FURNISHED BY OTHERS. THE ENGINEER HAS NOT VERIFIED THE ACCURACY AND/OR COMPLETENESS OF THE INFORMATION PROVIDED AND SHALL NOT BE RESPONSIBLE FOR ANY ERRORS OR OMISSIONS WHICH HAVE BEEN INCORPORATED INTO THESE RECORD PLANS AS A RESULT.



**Summary**  
Designed: NRH  
Approved: DS  
Phase: FINAL  
Drawn: JSO/NRH  
Book / Page:  
Initial Issue: 02/10/2017

**Revision History**

No.	Date	By	Submittal / Revision
A	02/10/17	NRH	CONSTRUCTION DOCUMENTS
B	06/16/17	JTA	REVISED PAD ELEVATIONS AND DRIVEWAY LOCATIONS
B	12/01/17	MMQ	RECORD PLANS

**Certification**  
I hereby certify that this plan, specification or report was prepared by me or under my direct supervision and that I am a duly licensed professional ENGINEER under the laws of the state of Minnesota.

Nathan R. Herman  
Registration No. 47982 Date: 02/10/2017  
If applicable, contact us for a wet signed copy of this plan which is available upon request at Sambatek's, Minnetonka, MN office.

**Client**  
PAXMAR

**Project**  
MISKE MEADOWS  
PHASE I & PHASE II  
ELK RIVER, MN

**Sheet Title**  
STORM SEWER PLAN &  
PROFILE

**Sheet No. Revision**  
C7.05 B  
**Project No.** PAX 20460