

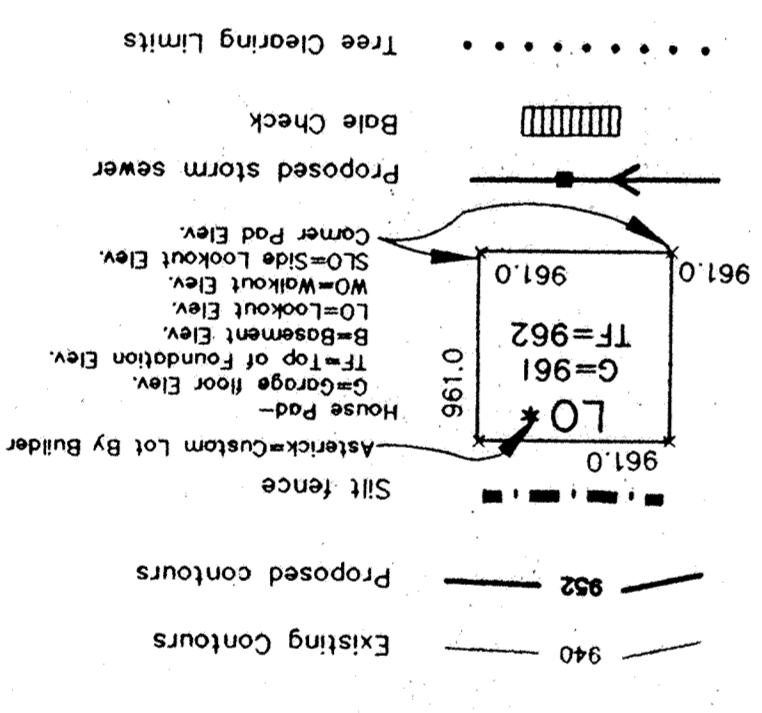

NOTE:
1. ALL LOTS TO BE ROUGH GRADED WITH A 2' AVERAGE PAD HOLD-DOWN.

APPROVED
6/25/97
[Signature]



LEGEND

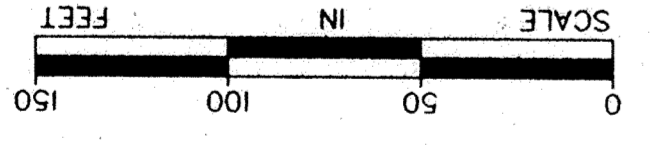

SHEET NO. 6 OF 8

LAFAYETTE WOODS
SECOND ADDITION
ELK RIVER, MN
FOR
WINDSOR DEVELOPMENT L.L.P.
SITE GRADING & DRAINAGE PLAN

John Oliver & Associates, Inc.
Civil Engineering, Land Surveying, Land Planning
580 Dodge Avenue
Brynorville, Minnesota
(612)441-2072 (FAX)441-5686
201 W. Trusters Trail, Suite 200
Brynorville, MN 55937
(612)894-3045 (FAX)894-3049

I hereby certify that this plan was prepared by me or under my direct supervision and that I am a duly Registered Professional Engineer under the laws of the State of Minnesota.
Signed: *John Oliver*
Date: 5/9/96 Reg. No. 22426

DATE: 5/9/96
DESIGN BY: JKRB,GO
DRAWN BY: JK,BC
CHECKED BY: GD
DWG FILE: PH2-GR06
TEXT FILE: N/A
FILE NO.: 2024-20-03

REV	NO.	DATE	DESCRIPTION
1	1	5/20/97	TREE CLEARING LIMITS PER CLIENT
2	2	6/12/97	WIS GRADING & ADD DECU PER CLIENT
3	3	6/17/97	FINAL GRADING SUBMITTAL