

CB or MH NO.	STRUCT. SIZE	NEENAH CASTING or EQUAL
CB-144	24" X 36"	R-3067-V
CBMH-145	48" DIA.	R-3067-V
CBMH-146	48" DIA.	R-1733-C
CBMH-147	48" DIA.	R-3067-V
CBMH-148	48" DIA.	R-3290-A
MH-149	48" DIA.	R-1642-B

NOTE:
 DRAIN TILE LENGTHS IN PUBLIC STREETS SHALL BE 125' UNLESS OTHERWISE NOTED. SEE DETAIL.

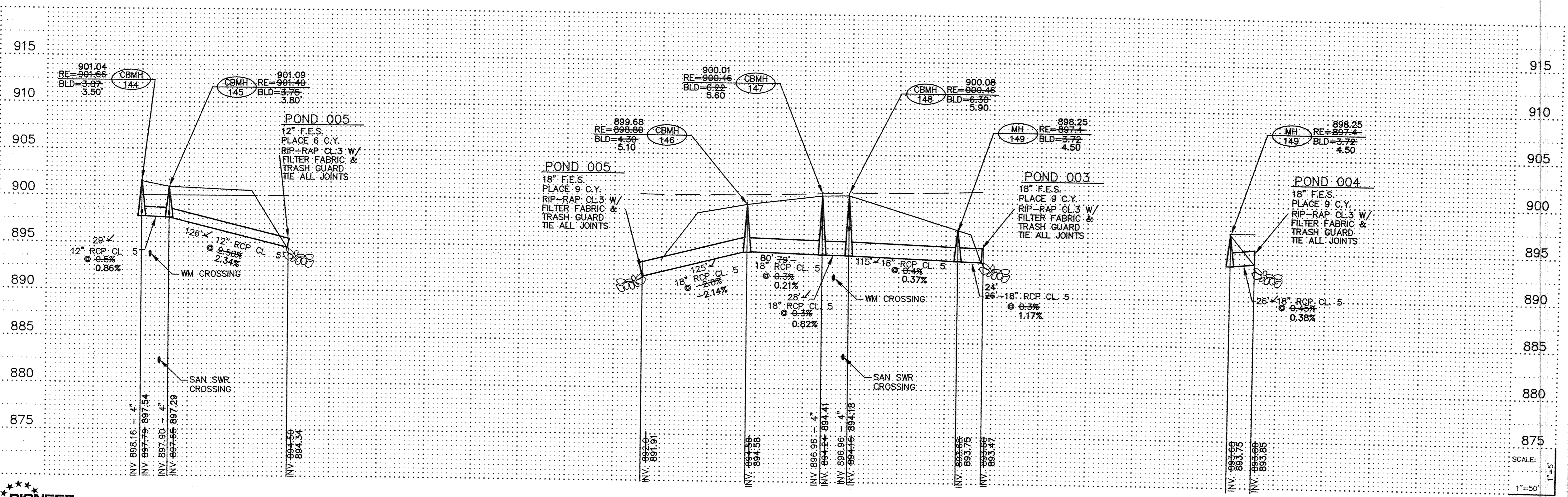

PIONEER engineering
 PA
 2422 Enterprise Drive
 Mendota Heights, MN 55120
 (651) 681-1514 FAX: 651-2486
 255 Highway 161 E
 Burnsville, MN 55334
 (763) 793-1880 FAX: 763-4883

I hereby certify that this plan was prepared by me or under my direct supervision and that I am a duly Licensed Professional Engineer under the laws of the State of Minnesota.

Name: Paul J. Cherak
 Reg. No.: 19860 Date: 6/20/02

Revisions: 1, 6/14/02
 Date: 6/20/02
 Designed: BFK
 Drawn: BFK

SHEET TITLE: **STORM SEWER**

OWNER: **GSS PROPERTIES LLC**
 8857 ZEALAND AVENUE NORTH
 BROOKLYN PARK, MINNESOTA 55445

PROJECT: **KLIEVER LAKE FIELDS EAST**
 ELK RIVER, MINNESOTA

RECORD PLAN 6/14/05
 SHEET 4 OF 9 SHEETS

SAJCO PRODUCTS • NEW HARBOR, MINNESOTA
 REGISTERED BY PART NUMBER 6532
 PROVISIONS SHALL BE PRINTED ON THIS LINE