

FILLMORE STREET NW

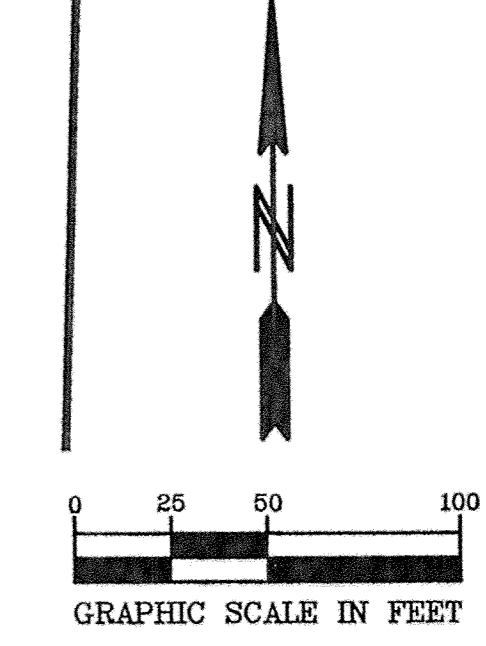

BENCHMARKS
 DOUBLE SPIKE EAST FACE OF POWER POLE,
 WEST SIDE OF FILLMORE STREET N.W.,
 50± FT. SOUTH OF 178TH AVENUE N.W.
 ELEVATION = 897.82 FT.
 TRIPLE SPIKE EAST FACE OF POWER POLE,
 NW QUADRANT OF FILLMORE STREET AND
 175TH AVENUE N.W.
 ELEVATION = 909.73 FT.

NOTE:
 INSTALL INLET PROTECTION AT CATCH BASINS WITHIN 48
 HOURS OF INSTALLATION (SEE DETAILS).

1. CB-108, CB-115, CB-121, AND CBMH USE MONO-MONO SILT FENCE
2. ALL OTHERS USE WMCO OR EQUAL

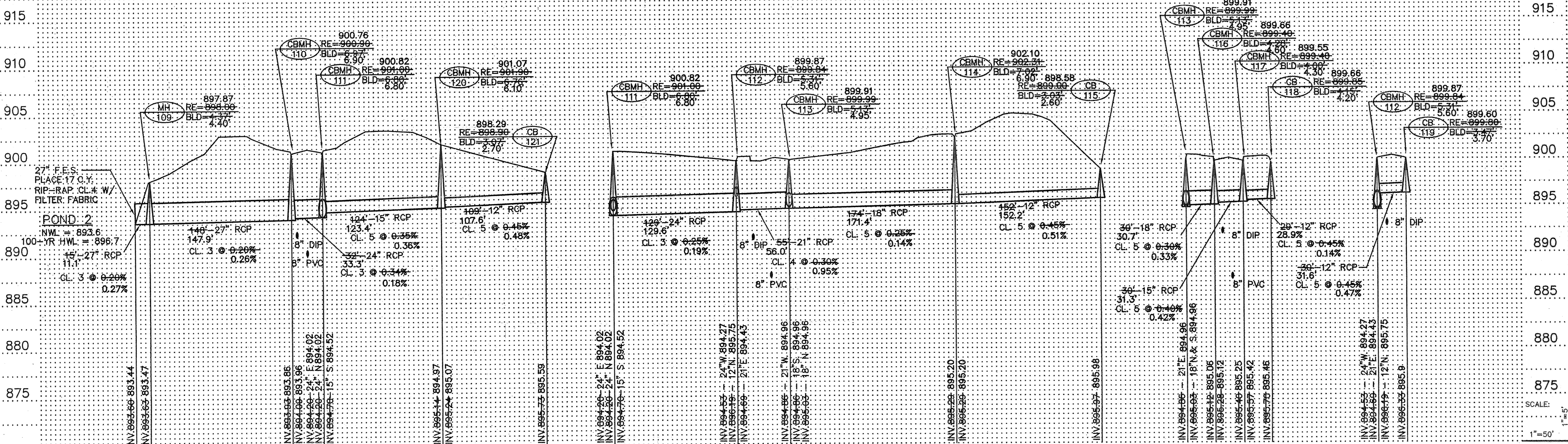

SCALE: 1"=50'

PIONEER engineering
 201 85th Avenue NW
 55265, Brooklyn Park, MN 55433
 (763) 783-1880 FAX: 783-1883
 2422 Enterprise Drive
 Mendota Heights, MN 55120
 (651) 681-1914 FAX: 681-9488

I hereby certify that this plan was prepared by me or under my direct supervision and that I am a duly Licensed Professional Engineer under the laws of the State of Minnesota.

Name: *Brian F. Kallio*
 Brian F. Kallio
 Reg. No. 25817 Date: 7/8/04

4. AS-BUILT
 3. Change inlet protection specification. Change address
 2. Add inlet protection note
 1. Per city comments

Revisions:
 1. 7/8/04
 2. 7/23/04
 3. 8/3/04
 4. 1/14/05

Date: 6/3/04
 Designed: B.F.K.
 Drawn: LC

SHEET TITLE: STORM SEWER

OWNER: GSS PROPERTIES, LLC
 8857 ZEALAND AVENUE NORTH
 BROOKLYN PARK, MINNESOTA 55445

PROJECT: KLEIVER LAKE FIELDS 2ND ADDITION
 ELK RIVER, MINNESOTA

SHEET 7 OF 13 SHEETS