

DRAWING NUMBER

DRAWING NUMBER

DRAWING NUMBER

DRAWING NUMBER

SAVCO PROJECTS • NEW YORK, MINNESOTA
RENDERED BY PART NUMBER 8533

SAVCO PROJECTS • NEW YORK, MINNESOTA
RENDERED BY PART NUMBER 8533

SAVCO PROJECTS • NEW YORK, MINNESOTA
RENDERED BY PART NUMBER 8533

SAVCO PROJECTS • NEW YORK, MINNESOTA
RENDERED BY PART NUMBER 8533

JACKSON AVENUE

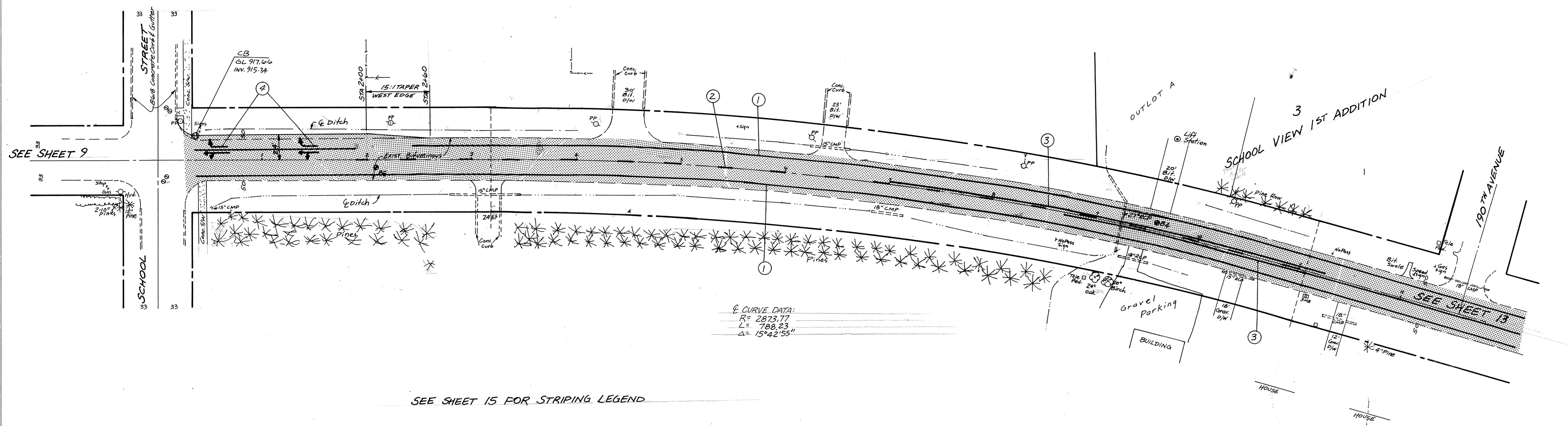
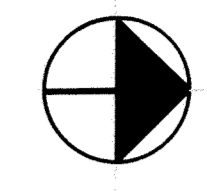

☐ CURVE DATA:
 R = 2873.77
 L = 788.23
 Δ = 15°42'55"

SEE SHEET 15 FOR STRIPING LEGEND

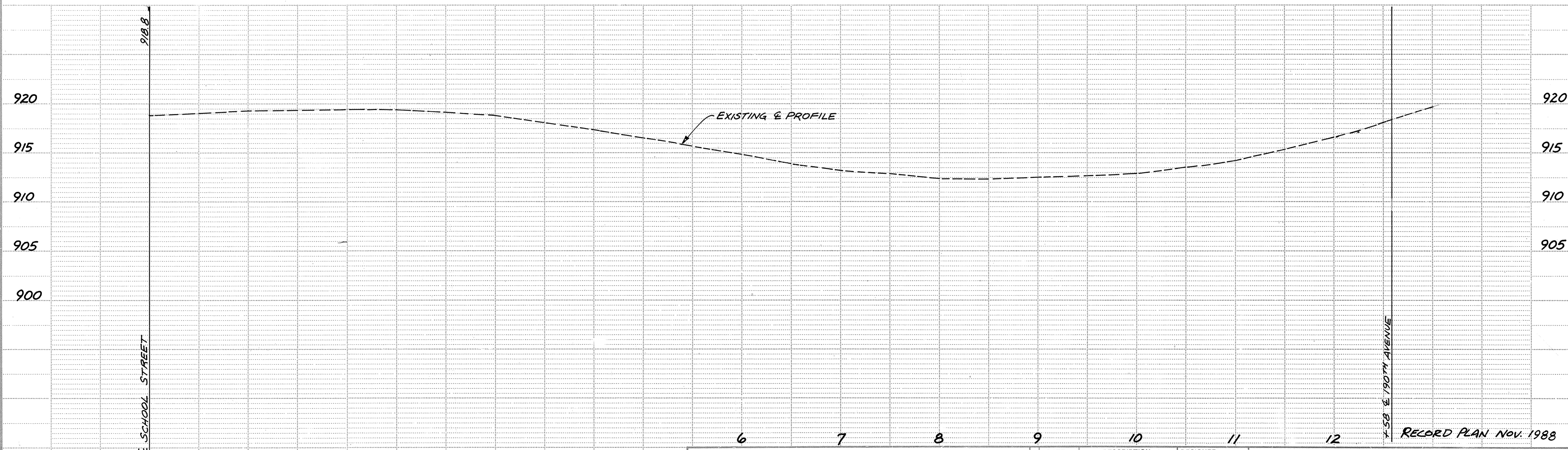

RECORD PLAN NOV. 1988

<p>Maier Stewart & Associates Inc. CONSULTING ENGINEERS 480 CEDAR STREET (612)227-9475 ST. PAUL, MINNESOTA 55101</p>	DATE	DESCRIPTION	DESIGNED	<p>CITY OF ELK RIVER BITUMINOUS OVERLAY JACKSON AVENUE</p> <p>DATE MAY 1987 SHEET 12 OF 28 SHEETS PROJECT NO. 230-032</p>
	REVISIONS		CHECKED	
			DRAWN MRJ	
			GRAPHIC SCALE	
			0 HORIZ. 50 0 VERT. 5	