

STORM SEWER

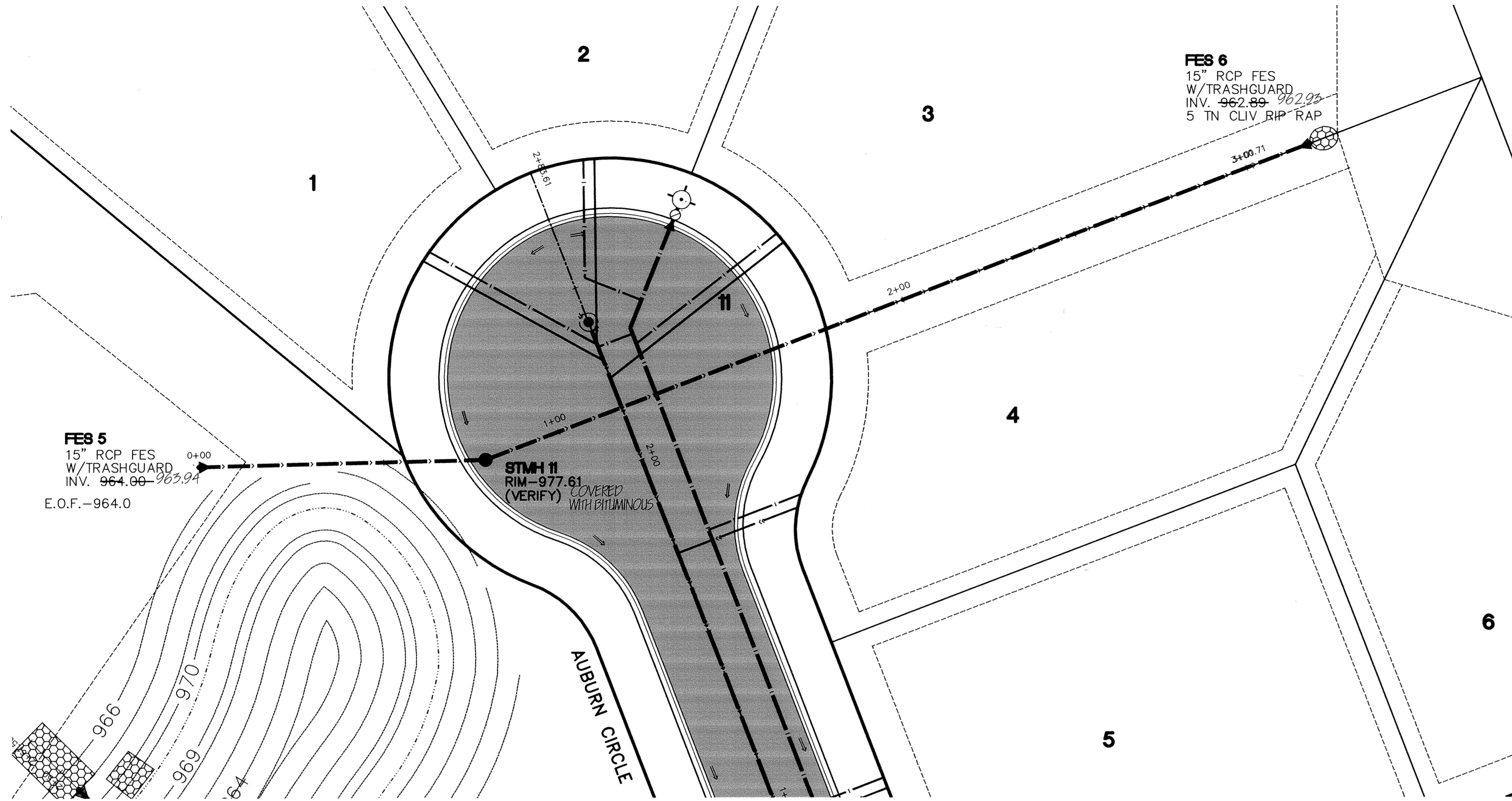

- NOTES:**
- VERIFY LOCATION AND ELEVATIONS OF EXISTING UTILITIES.
 - CONTACT 'GOPHER STATE ONE CALL' FOR LOCATIONS OF BURIED UTILITIES. CALL (651) 454-0002 OR 1 (800) 252-1166.

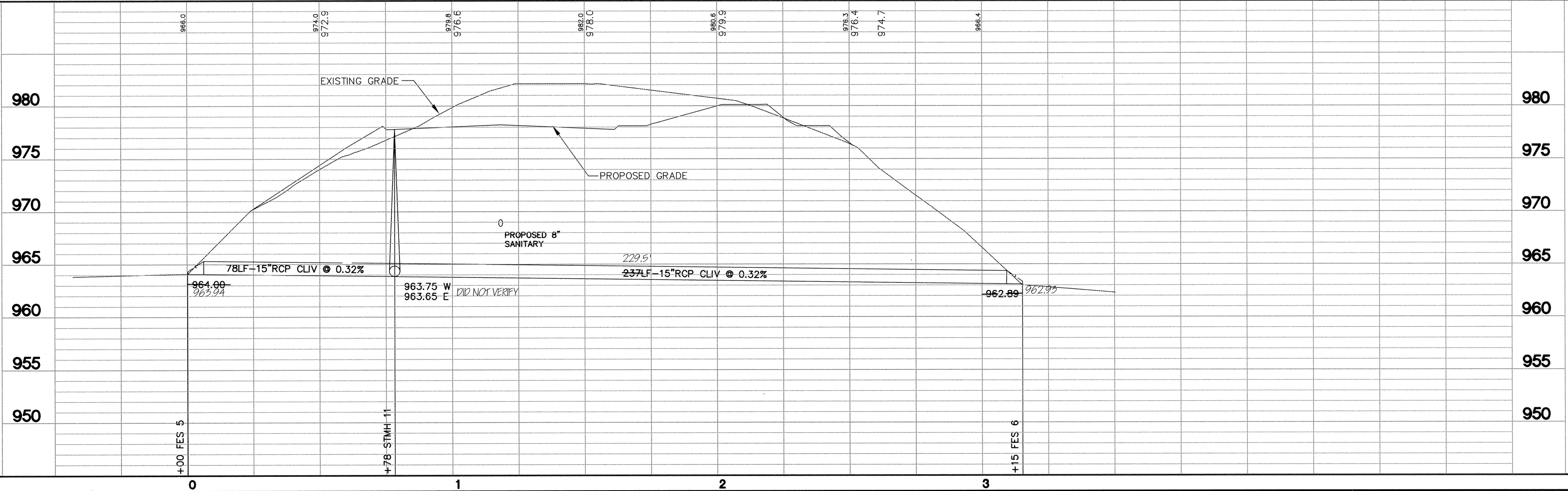
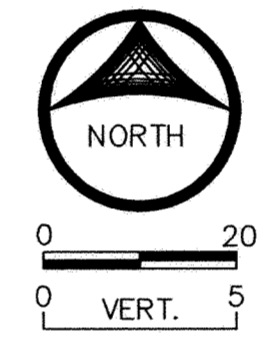

I HEREBY CERTIFY THAT THIS PLAN WAS PREPARED BY ME OR UNDER MY DIRECT SUPERVISION AND THAT I AM A DULY LICENSED PROFESSIONAL ENGINEER UNDER THE LAWS OF THE STATE OF MINNESOTA.

John C. Johnson
JOHN C. JOHNSON
DATE 3/21/05 LICENSE NO. 11546

DATE	REVISIONS	BY
6/25/03	PER CITY REVIEW	PK
7/1/03	MOVED STMH 11	PK
7/17/03	STMH 11 LABEL	PK

U8

RECORD DRAWING - JANUARY 2004

STORM SEWER CONSTRUCTION
HILLSIDE ESTATES 9TH ADDITION

OWNER/DEVELOPER
RIVERSIDE COMPANIES
19230 EVANS STREET, SUITE 115
ELK RIVER, MINNESOTA
PHONE: 763-241-1801

STA. 0+00 TO 4+00
CITY OF ELK RIVER, MINNESOTA

